

F.A.P. RTE.	SECTION	COUNTY	TOTAL SHEETS	SHEET NO.
315	34-4	HANCOCK	452	65
STA. 1060+00		TO STA. 1075+00		
FED. ROAD DIST. NO.	ILLINOIS	FED. AID PROJECT		

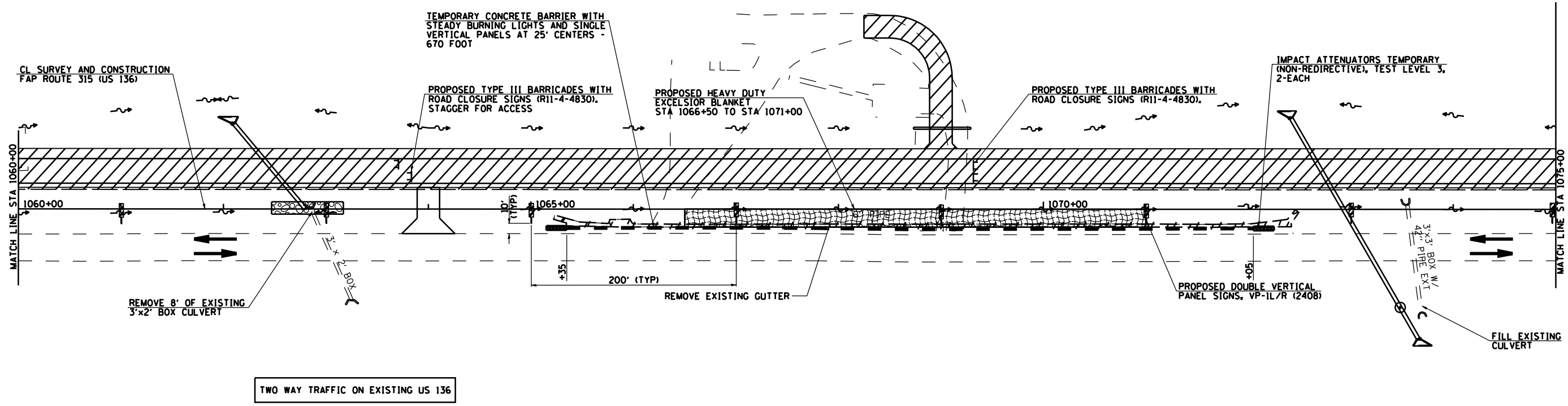

D-86-891-02  
**CONTRACT NO. 72680**



TWO WAY TRAFFIC ON EXISTING US 136

**NOTES:**  
 FINAL SURFACE COURSE TO BE COMPLETED IN A LATER STAGE.  
 TRAFFIC CONTROL AND PROTECTION ON US 136 SHALL BE IN ACCORDANCE WITH STANDARDS 701001, 701006, 701011, & 701326.  
 TEMPORARY EROSION CONTROL ITEMS SHALL BE PLACED AS REQUIRED ON STAGE 1 TEMPORARY FINISHED GRADES AT THE LOCATIONS SHOWN IN THE STAGE 1 PLANS AND THE QUANTITY SCHEDULES AND AS DIRECTED BY THE ENGINEER.

**LEGEND**

	STAGE 1A WORK AREA
	STAGE 1B WORK AREA

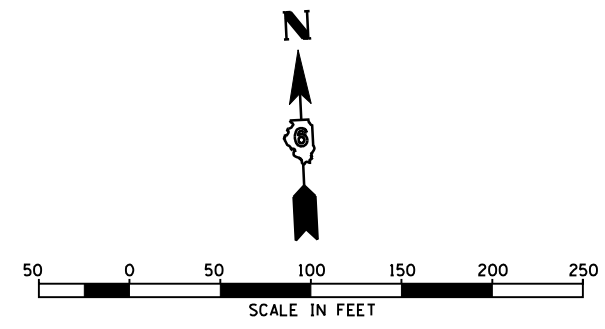

REVISIONS	
NAME	DATE

ILLINOIS DEPARTMENT OF TRANSPORTATION  
 FAP ROUTE 315 (US RTE 136)  
 TRAFFIC CONTROL DETAILS  
 AND STAGING DETAILS  
 STAGE 1 PLAN  
 STA 1060+00 TO STA 1075+00  
 SCALE: 1" = 50'-0"  
 DATE 1/31/06  
 DRAWN BY JCG  
 CHECKED BY JRB