

F.A.P. RTE.	SECTION	COUNTY	TOTAL SHEETS	SHEET NO.
315	34-4	HANCOCK	452	78
STA. 985+00		TO STA. 1000+00		
FED. ROAD DIST. NO.		ILLINOIS	FED. AID PROJECT	

**CONTRACT NO. 72680**

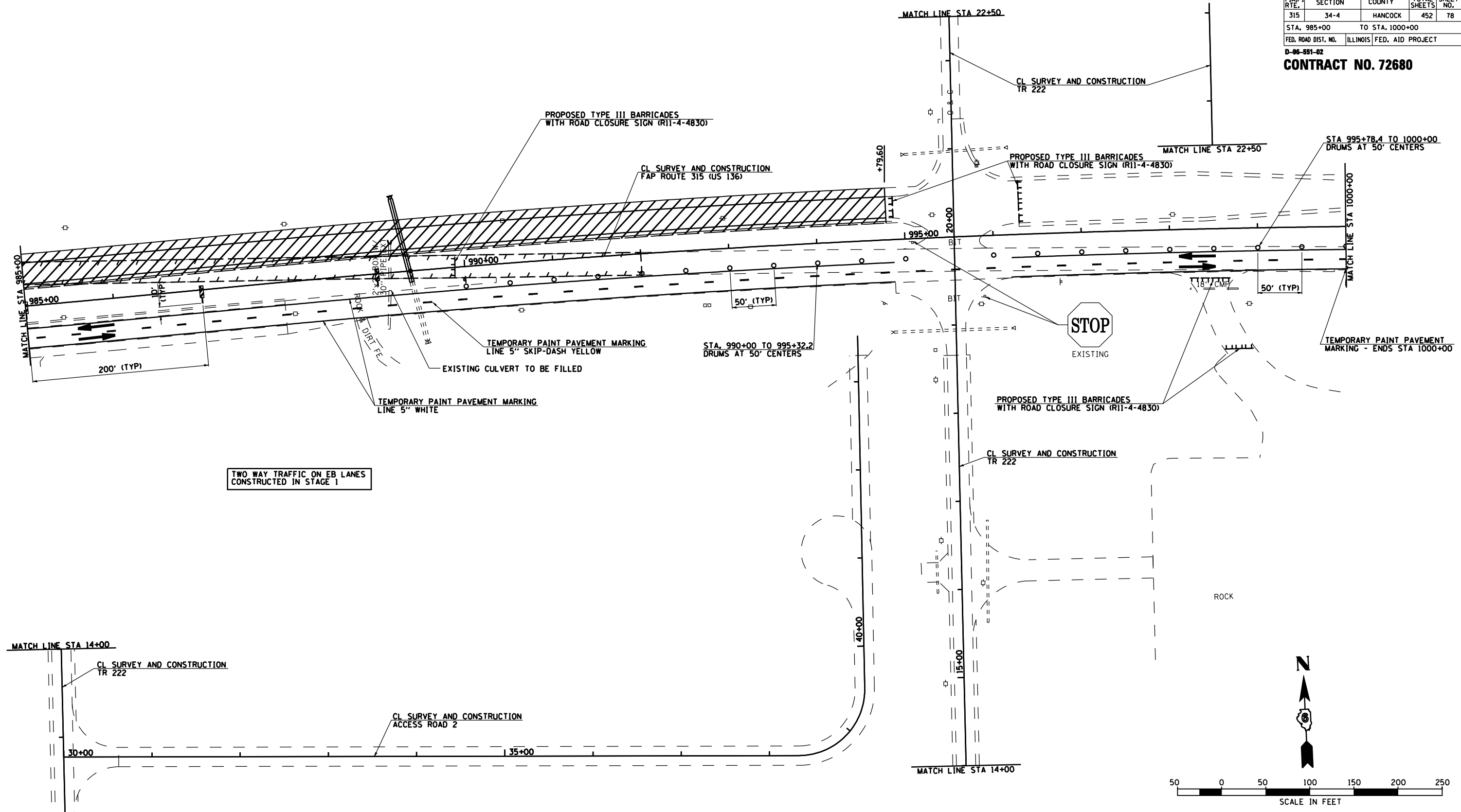

TWO WAY TRAFFIC ON EB LANES  
CONSTRUCTED IN STAGE 1

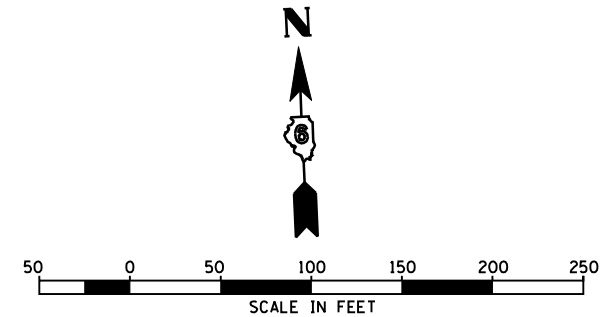

**NOTES:**  
FINAL SURFACE COURSE TO BE COMPLETED  
IN A LATER STAGE.  
TRAFFIC CONTROL AND PROTECTION ON US 136  
SHALL BE IN ACCORDANCE WITH STANDARDS  
701001, 701006, & 701011.

**LEGEND**

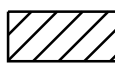
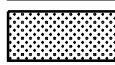
	STAGE 2A WORK AREA
	STAGE 2B WORK AREA

REVISIONS	
NAME	DATE

ILLINOIS DEPARTMENT OF TRANSPORTATION  
FAP ROUTE 315 (US RTE 136)  
TRAFFIC CONTROL DETAILS  
AND STAGING DETAILS  
STAGE 2 PLAN  
STA 985+00 TO STA 1000+00  
SCALE: 1" = 50'-0"  
DATE 1/31/06  
DRAWN BY JCG  
CHECKED BY JRB