

STAGE 3 TRAFFIC CONTROL AND PROTECTION WEST END CROSSOVER - STANDARD 701416 SPECIAL

APPROXIMATE BILL OF MATERIALS - FOR INFORMATION ONLY

ITEM	SIGN NUMBER	ESTIMATED NUMBER REQUIRED
EXPRESSWAY ENDS 1000 FT	W8-1103(O)-48	2
RIGHT LANE ENDS	W9-1R(O)-48	2
PAVEMENT WIDTH TRANSITION	W4-2R(O)-48	2
TWO WAY TRAFFIC	W6-3(O)-48	1
KEEP RIGHT	R4-7 (4860)	1
DIVIDED HIGHWAY	W6-1(O)-48	1
DIRECTIONAL BARRICADES		37
DRUMS		37

STAGE 3 TEMPORARY SIGNS

APPROXIMATE BILL OF MATERIALS - FOR INFORMATION ONLY

ITEM	SIGN NUMBER	ESTIMATED NUMBER REQUIRED
STOP	R1-1 (3636)	12
REVERSE CURVE	W1-4R(O)-48	2
LARGE ARROW	W1-6R(O)-6030	2
VERTICAL PANELS		89
DRUMS WITH STEADY BURNING LIGHTS		16
TYPE III BARRICADES WITH ROAD CLOSED SIGNS	R11-4 (4830)	102

• TYPE III BARRICADES WERE ESTIMATED ASSUMING EACH BARRICADE WILL CLOSE ONE LANE OF TRAFFIC, QUANTITY SHALL BE ADJUSTED ACCORDINGLY DEPENDING ON THE LENGTH OF BARRICADES USED.

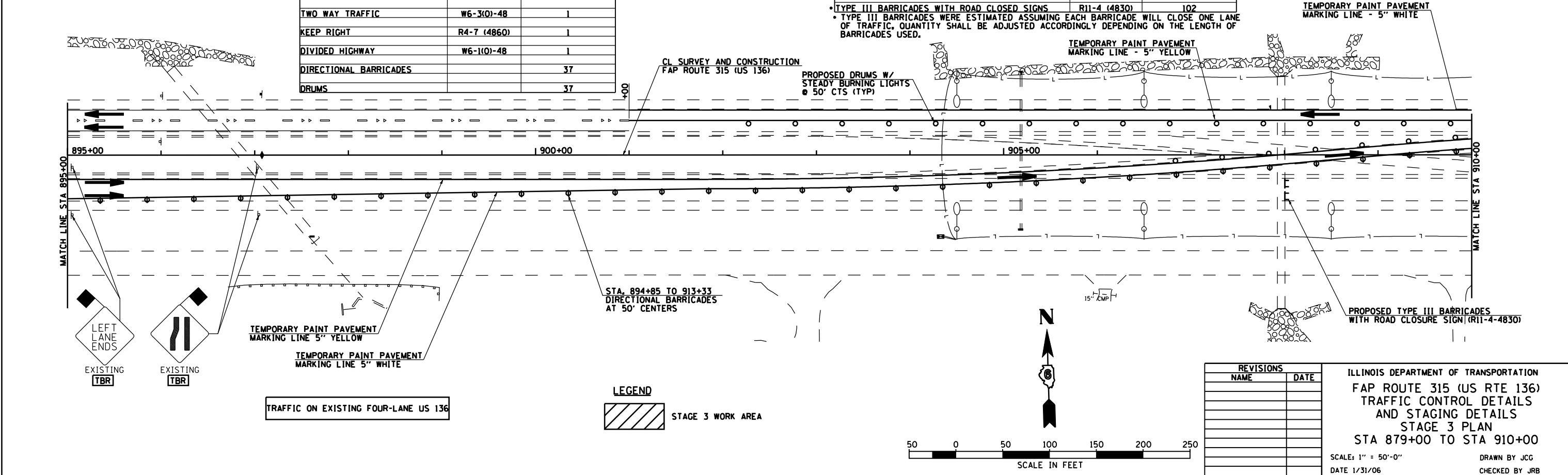

REVISIONS	
NAME	DATE

ILLINOIS DEPARTMENT OF TRANSPORTATION
 FAP ROUTE 315 (US RTE 136)
 TRAFFIC CONTROL DETAILS
 AND STAGING DETAILS
 STAGE 3 PLAN
 STA 879+00 TO STA 910+00
 SCALE: 1" = 50'-0"
 DATE 1/31/06
 DRAWN BY JCG
 CHECKED BY JRB