

F.A.P. RTE.	SECTION	COUNTY	TOTAL SHEETS	SHEET NO.
315	34-4	HANCOCK	452	130

FED. ROAD DIST. NO. ILLINOIS FED. AID PROJECT

D-98-591-02

CONTRACT NO. 72680

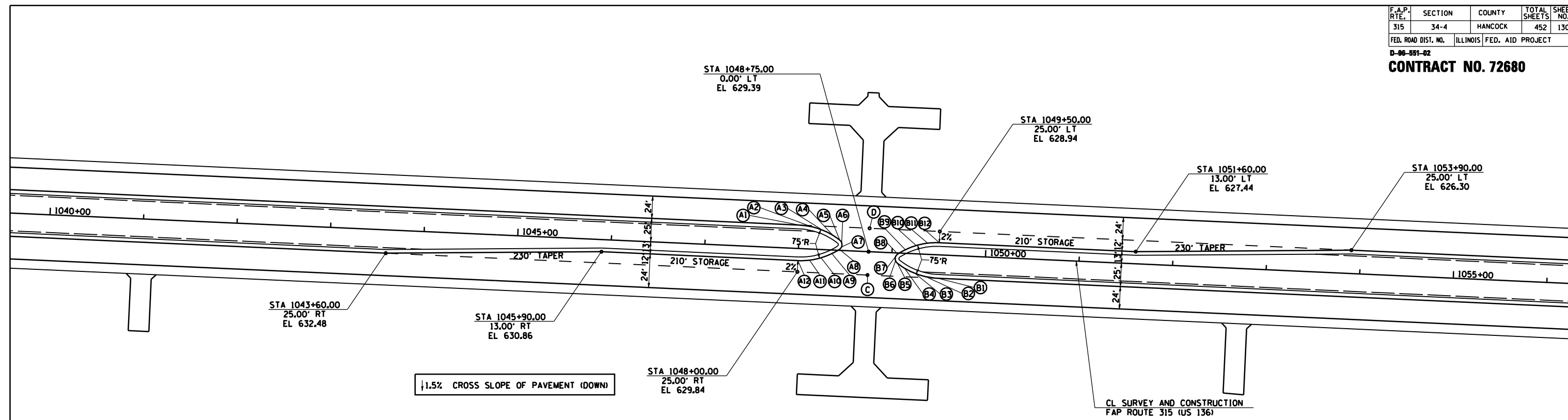

1.5% CROSS SLOPE OF PAVEMENT (DOWN)

CL SURVEY AND CONSTRUCTION
FAP ROUTE 315 (US 136)

POINT	STATION	OFFSET	ELEVATION
A1	1048+00.00	25.00' LT	629.84
A2	1048+12.44	23.96' LT	629.63
A3	1048+24.54	20.87' LT	629.42
A4	1048+35.96	15.82' LT	629.21
A5	1048+43.82	10.87' LT	629.04
A6	1048+45.81	8.40' LT	629.04
A7	1048+45.81	3.60' LT	629.05
A8	1048+43.82	1.13' LT	629.05
A9	1048+35.96	3.82' RT	629.16
A10	1048+24.54	8.87' RT	629.31
A11	1048+12.44	11.96' RT	629.45
A12	1048+00.00	13.00' RT	629.60
B1	1049+50.00	25.00' RT	628.94
B2	1049+37.50	23.95' RT	628.97
B3	1049+25.46	20.87' RT	629.01
B4	1049+14.04	15.82' RT	629.04
B5	1049+06.18	10.87' RT	629.07
B6	1049+04.19	8.40' RT	629.06
B7	1049+04.19	3.61' RT	629.05
B8	1049+06.18	1.13' RT	629.04
B9	1049+14.04	3.82' LT	628.97
B10	1049+25.46	8.87' LT	628.88
B11	1049+37.50	11.95' LT	628.79
B12	1049+50.00	13.00' LT	628.70
C	1048+75.00	25.00' RT	629.39
D	1048+75.00	25.00' LT	629.39

NOTE:
ALL MEDIAN NOSE
RADIi ARE 6'

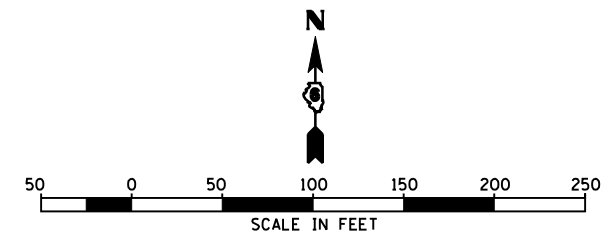

REVISIONS	
NAME	DATE

ILLINOIS DEPARTMENT OF TRANSPORTATION

FAP ROUTE 315
INTERSECTION DETAILS
CROSSOVER @ STA 1048+75.00

DATE 1/31/06
DRAWN BY JCG
CHECKED BY JRB