

F.A.P. RTE.	SECTION	COUNTY	TOTAL SHEETS	SHEET NO.
315	34-4	HANCOCK	452	134

FED. ROAD DIST. NO. ILLINOIS FED. AID PROJECT

D-98-591-02

CONTRACT NO. 72680

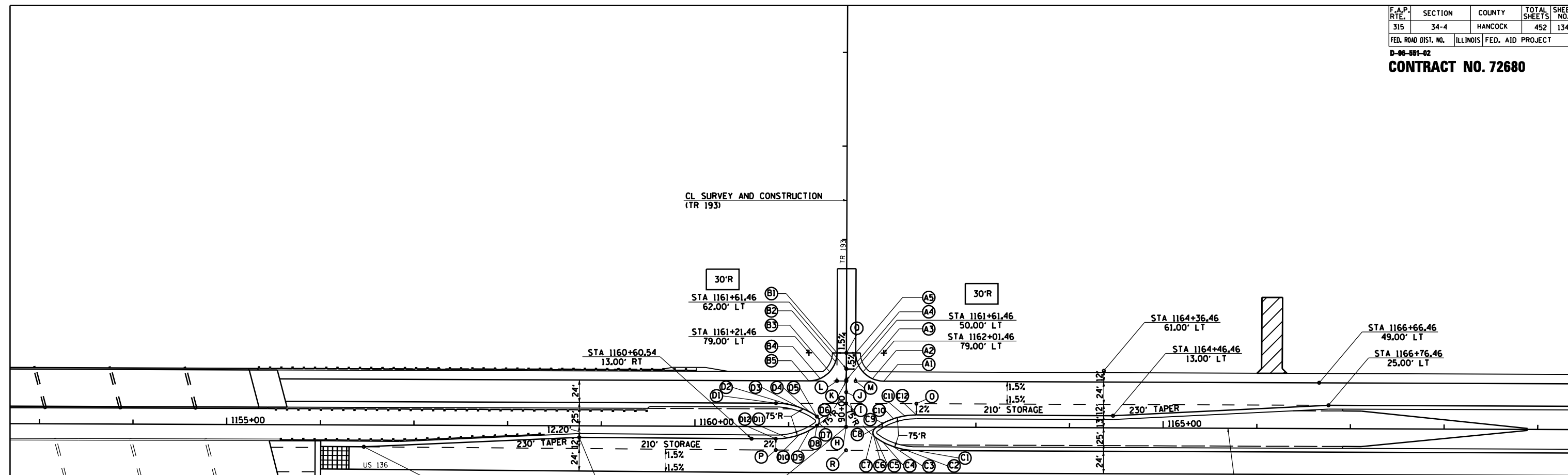

POINT	STATION	OFFSET	ELEVATION
A1	1162+01.46	49.00' LT	555.87
A2	1161+89.32	51.57' LT	555.72
A3	1161+79.25	58.83' LT	555.25
A4	90.69.55	11.53' RT	554.58
A5	90.79.00	10.00' RT	553.98
B1	90.79.00	10.00' LT	553.98
B2	90.69.55	11.53' LT	554.58
B3	1161+43.67	58.83' LT	555.32
B4	1161+33.60	51.57' LT	555.82
B5	1161+21.46	49.00' LT	556.01
C1	1162+36.46	25.00' RT	555.79
C2	1162+24.02	23.96' RT	555.74
C3	1162+11.92	20.87' RT	555.70
C4	1162+00.50	15.82' RT	555.65
C5	1162+92.64	10.87' RT	555.62
C6	1161+90.65	8.40' RT	555.62
C7	1161+90.65	3.60' RT	555.62
C8	1162+92.64	1.13' RT	555.62
C9	1162+00.50	3.82' LT	555.61
C10	1162+11.92	8.87' LT	555.61
C11	1162+24.02	11.96' LT	555.60
C12	1162+36.46	13.00' LT	555.59
D1	1160+86.46	25.00' LT	556.10
D2	1160+98.90	23.95' LT	555.97
D3	1161+11.00	20.87' LT	555.84
D4	1161+22.42	15.82' LT	555.72
D5	1161+30.27	10.87' LT	555.62
D6	1161+32.27	8.40' LT	555.62
D7	1161+32.27	3.60' LT	555.62
D8	1161+30.27	1.13' LT	555.62
D9	1161+22.42	3.82' RT	555.65
D10	1161+11.00	8.87' RT	555.70
D11	1160+98.90	11.96' RT	555.74
D12	1160+86.46	13.00' RT	555.79

POINT	STATION	OFFSET	ELEVATION
H	1161+61.46	0.00	555.93
I	1161+61.46	25.00 LT	555.93
J	1161+61.46	37.00 LT	556.11
K	1161+61.46	49.00 LT	555.93
L	1161+51.46	49.00 LT	555.95
M	1161+71.46	49.00 LT	555.91
O	1162+36.46	25.00 LT	555.83
P	1160+86.46	25.00 RT	556.03
Q	90+79.00	0.00	554.13
R	1161+61.46	25.00 RT	555.93

NOTE:
ALL MEDIAN NOSE
RADIUS ARE 6'

1.5% CROSS SLOPE OF PAVEMENT (DOWN)

FROM THE EAST END OF THE BRIDGES OVER WEST FORK LAMOINE RIVER TO THE EAST END OF THE PROJECT, THE BITUMINOUS CONCRETE SURFACE COURSE AND TOP LIFT OF SHOULDERS FOR BOTH THE EASTBOUND AND WESTBOUND LANES WILL BE PLACED BY OTHERS UNDER A SEPARATE CONTRACT. THE ELEVATIONS SHOWN HERE REFLECT THE ULTIMATE PAVEMENT SURFACE, THEREFORE, THE BINDER LAYER SHALL BE CONSTRUCTED IN A MANNER THAT WILL ALLOW THE SURFACE TO BE PLACED AT THE SPECIFIED GRADES IN THE NEXT CONTRACT.

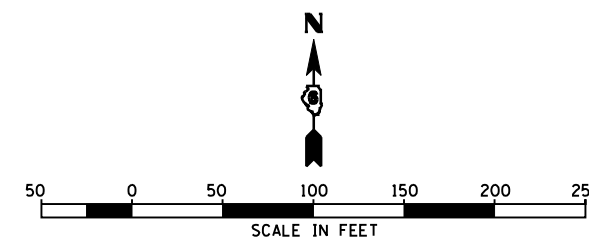

REVISIONS	
NAME	DATE

ILLINOIS DEPARTMENT OF TRANSPORTATION

FAP ROUTE 315
INTERSECTION DETAILS
(TR 193)

DATE 1/31/06

DRAWN BY JCG
CHECKED BY JRB