

F.A.P. RTE.	SECTION	COUNTY	TOTAL SHEETS	SHEET NO.
315	34-4	HANCOCK	452	142
STA. 1000+00.00		TO STA. 1030+00.00		
FED. ROAD DIST. NO.	ILLINOIS	FED. AID PROJECT		

D-96-991-02
CONTRACT NO. 72680

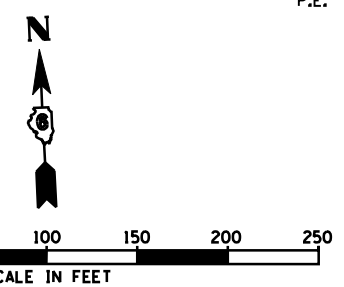
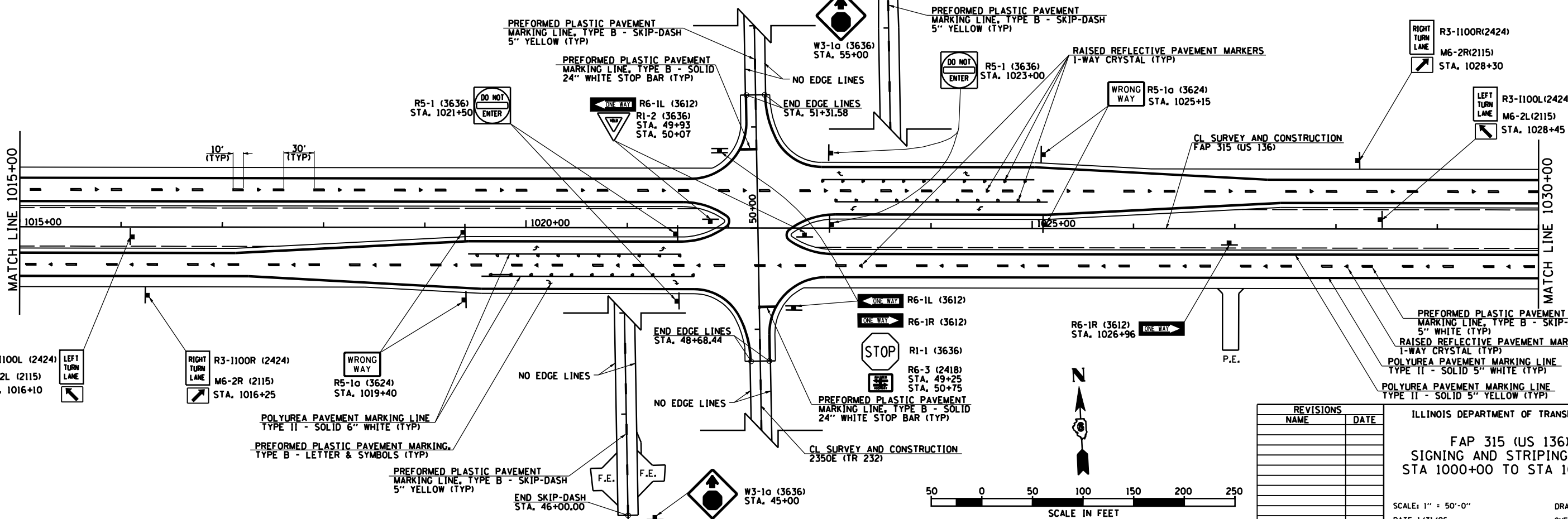
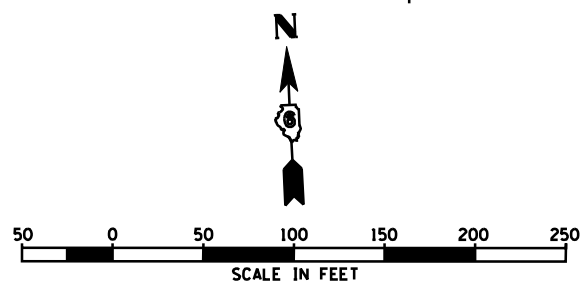
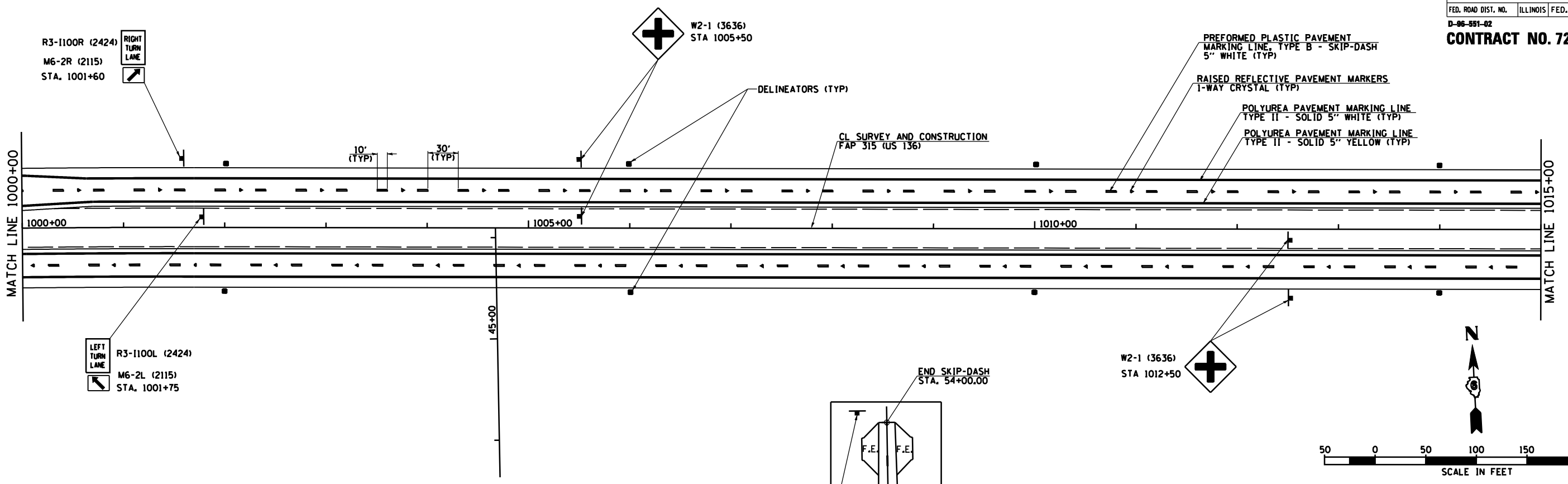

REVISIONS	
NAME	DATE

ILLINOIS DEPARTMENT OF TRANSPORTATION
FAP 315 (US 136)
SIGNING AND STRIPING PLAN
STA 1000+00 TO STA 1030+00
SCALE: 1" = 50'-0"
DATE 1/31/06
DRAWN BY JCG
CHECKED BY JRB