

| F.A. RTE. | SECTION | COUNTY | TOTAL SHEETS | SHEET NO. |
|---------------------|---------|--------------------|------------------|-----------|
| 315 | 34-4 | HANCOCK | 452 | 150 |
| STA. 1150+00.00 | | TO STA. 1174+00.00 | | |
| FED. ROAD DIST. NO. | | ILLINOIS | FED. AID PROJECT | |

CONTRACT NO. 72680

| POLE | STATION | OFFSET |
|------|---------|--------|
| T1 | 1165+79 | 79' RT |
| T2 | 1167+79 | 79' RT |
| T3 | 1169+79 | 79' RT |
| T4 | 1171+79 | 79' RT |
| T5 | 1173+79 | 79' RT |
| T6 | 1165+79 | 79' LT |
| T7 | 1167+79 | 79' LT |
| T8 | 1169+79 | 79' LT |
| T9 | 1171+79 | 79' LT |
| T10 | 1173+79 | 79' LT |

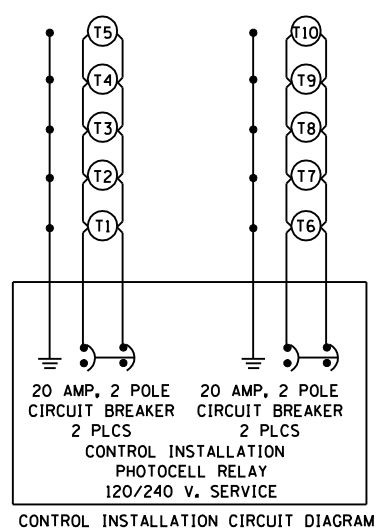
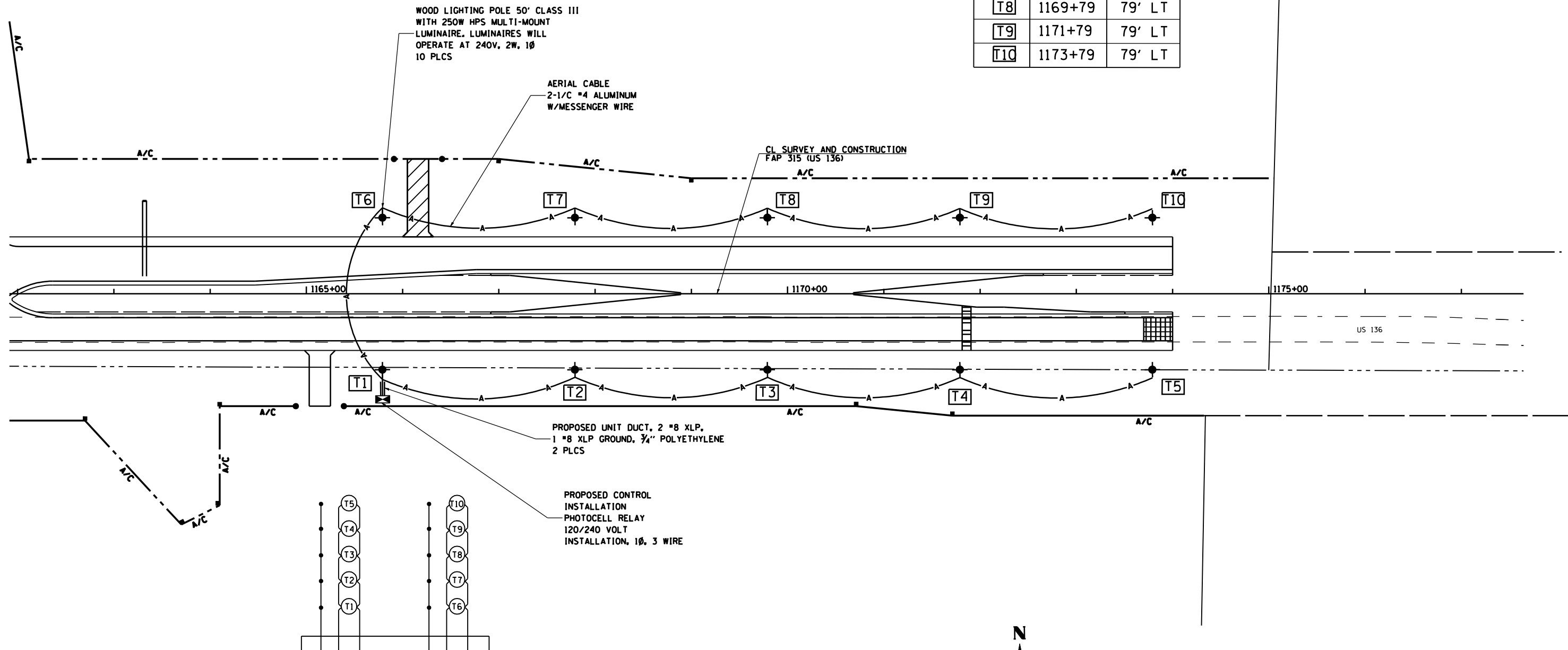

PROPOSED UNIT DUCT, 2 #8 XLP,
1 #8 XLP GROUND, 3/4" POLYETHYLENE
2 PLCS

PROPOSED CONTROL
INSTALLATION
PHOTOCELL RELAY
120/240 VOLT
INSTALLATION, 1Ø, 3 WIRE

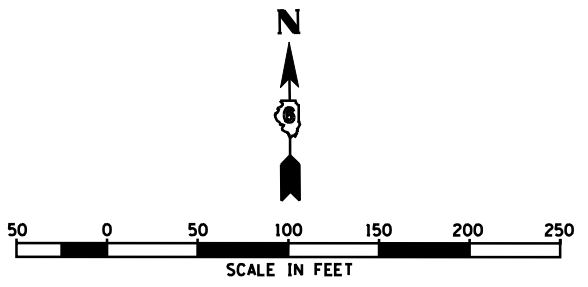

| REVISIONS | |
|-----------|------|
| NAME | DATE |
| | |
| | |
| | |
| | |
| | |
| | |
| | |
| | |
| | |
| | |

ILLINOIS DEPARTMENT OF TRANSPORTATION
**FAP 315 (US 136)
LIGHTING PLAN
CROSSOVER @ STA 1170+00**
SCALE: 1" = 50'-0"
DATE 1/31/06
DRAWN BY JCG
CHECKED BY JRB