

ROUTE NO.	SEC	COUNTY	TOTAL SHEETS	SHEET NO.
FAP 315	*	HANCOCK	452	185
FED. ROAD DIST. NO. 7	ILLINOIS	PROJECT		

SHEET NO. 8  
21 SHEETS

D-96-551-02  
**CONTRACT NO. 72680**

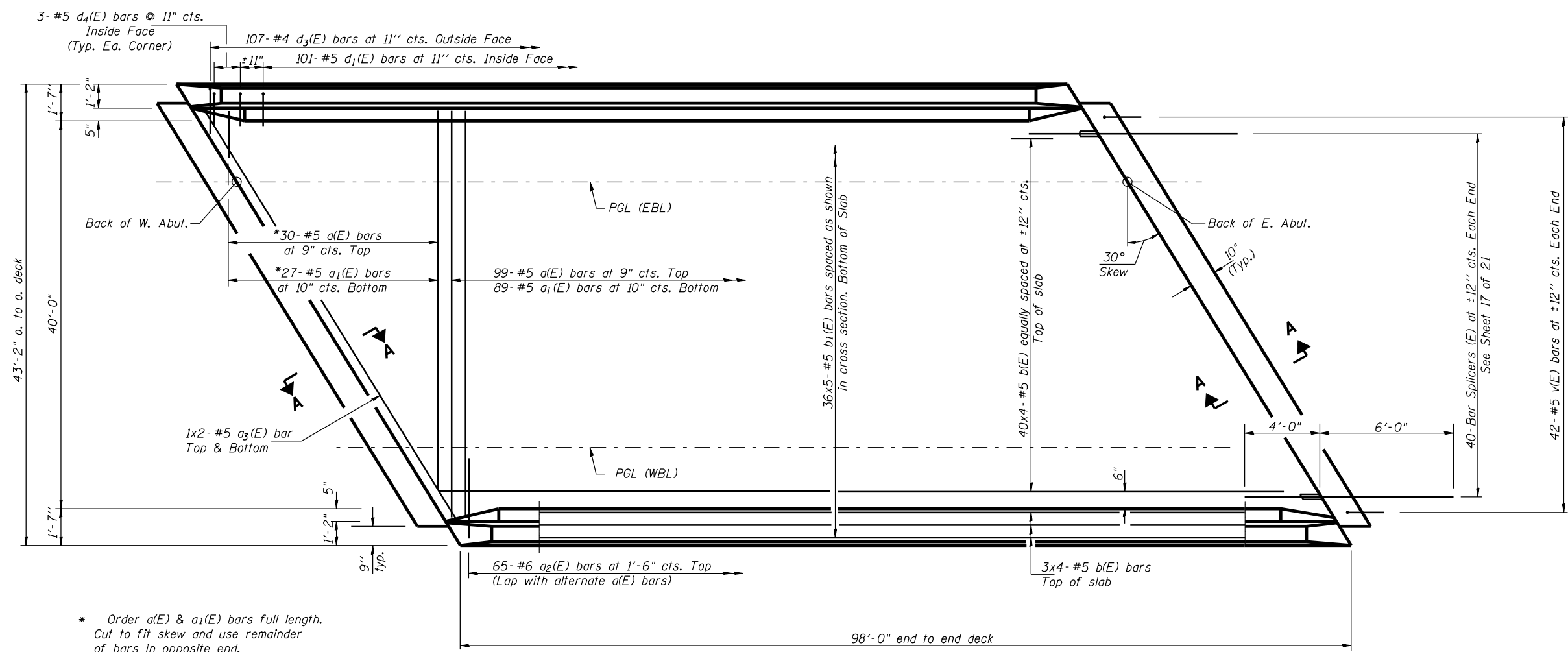

\* Order a(E) & a1(E) bars full length. Cut to fit skew and use remainder of bars in opposite end.

**Min. Lap**  
#5 bars - 2'-2"

**PLAN**  
(EBL or WBL Structure)

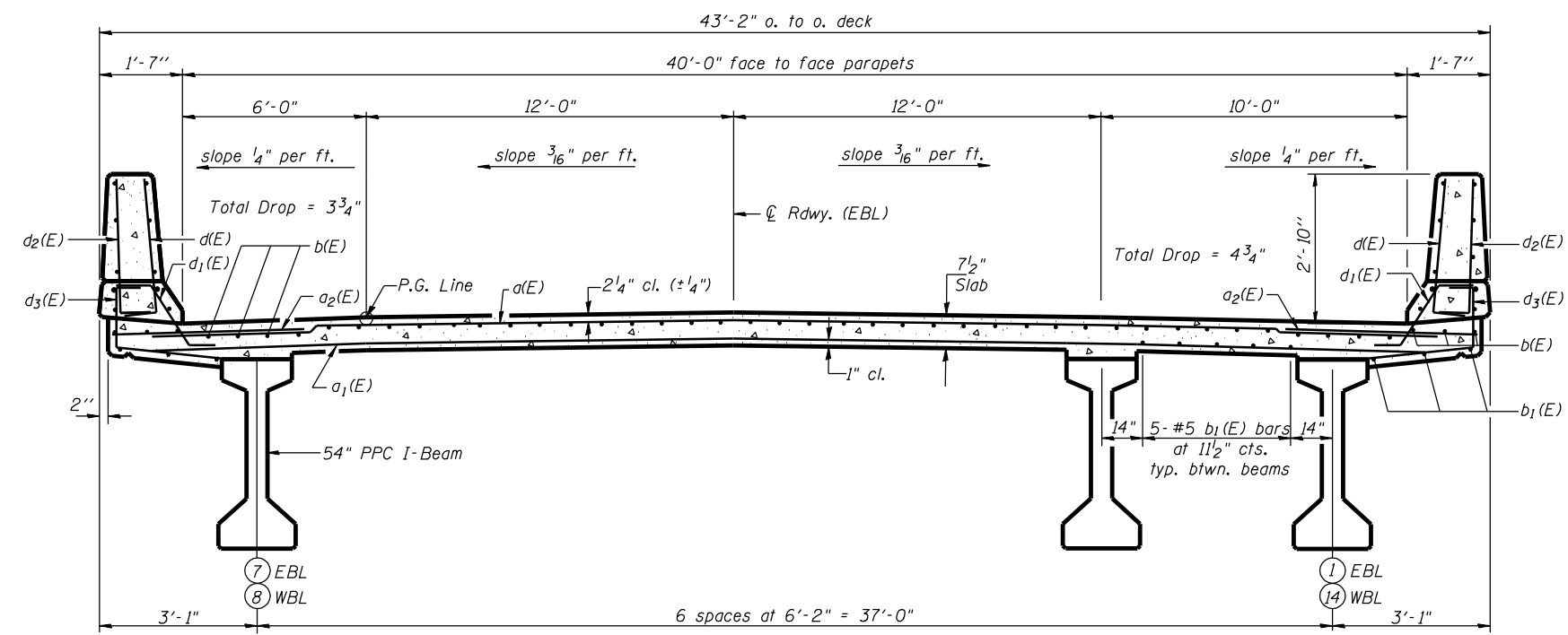

**CROSS SECTION**  
(Looking West - WBL)  
(Looking East - EBL)

Notes:  
See Sheet 9 of 21 for superstructure details and Bill of Material.  
Reinforcement bars designated (E) shall be epoxy coated.  
Bars indicated thus 20x3-#5 etc. indicates 20 lines of bars with 3 lengths per line.  
See Sheet 9 of 21 for parapet reinforcement.  
See Sheet 12 of 21 for Section A-A.

**SUPERSTRUCTURE - E.B.L. & WBL**  
**FAP ROUTE 315 OVER PRAIRIE CREEK**  
**SECTION 34-4B**  
**HANCOCK COUNTY**  
**STATION 973+28.00**  
**STR. NO. 034-0506 (WBL)**  
**STR. NO. 034-0507 (EBL)**

HUTCHISON ENGINEERING, INC.  
JACKSONVILLE, ILLINOIS  
Date: January 31, 2006