

CONTRACT NO. 72680

PILE DATA

Type: Metal Pile Shells, 14"
Capacity: 55 Tons
Est. Length: 58 Ft.
No. Required: 12

NOTES

1. Space Reinforcement in cap to miss anchor bolts.
2. All edges shall have standard 3/4" chamfers.
3. Pour steps monolithically with cap.

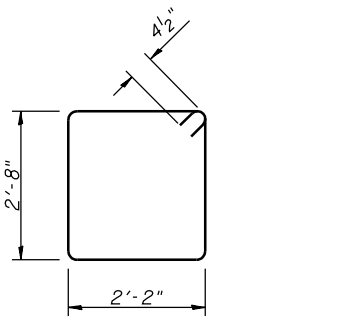
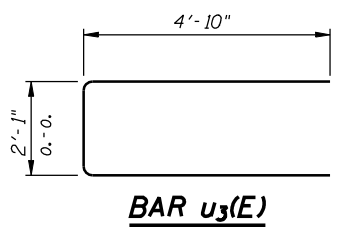
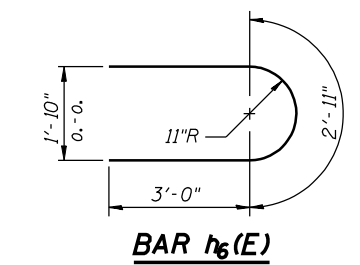
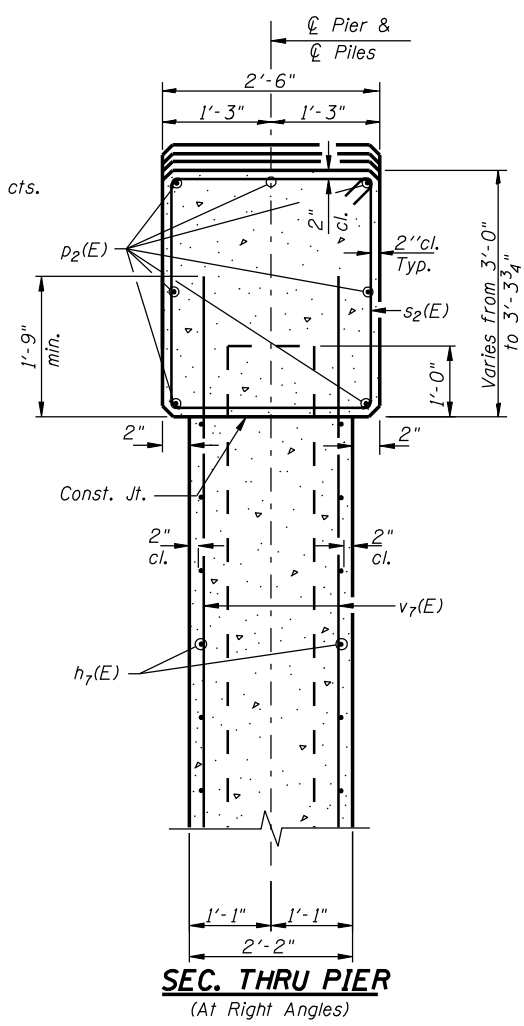
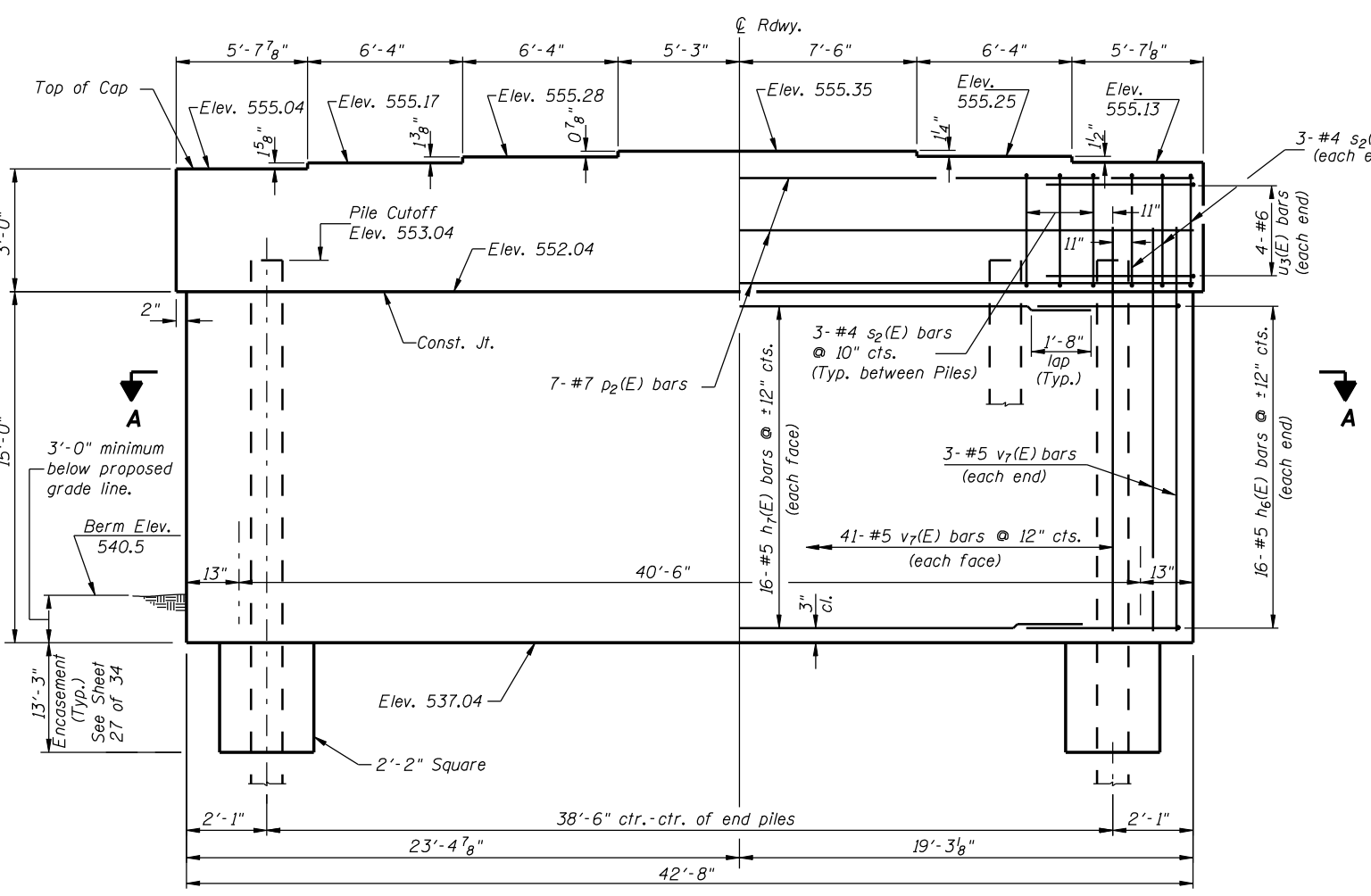
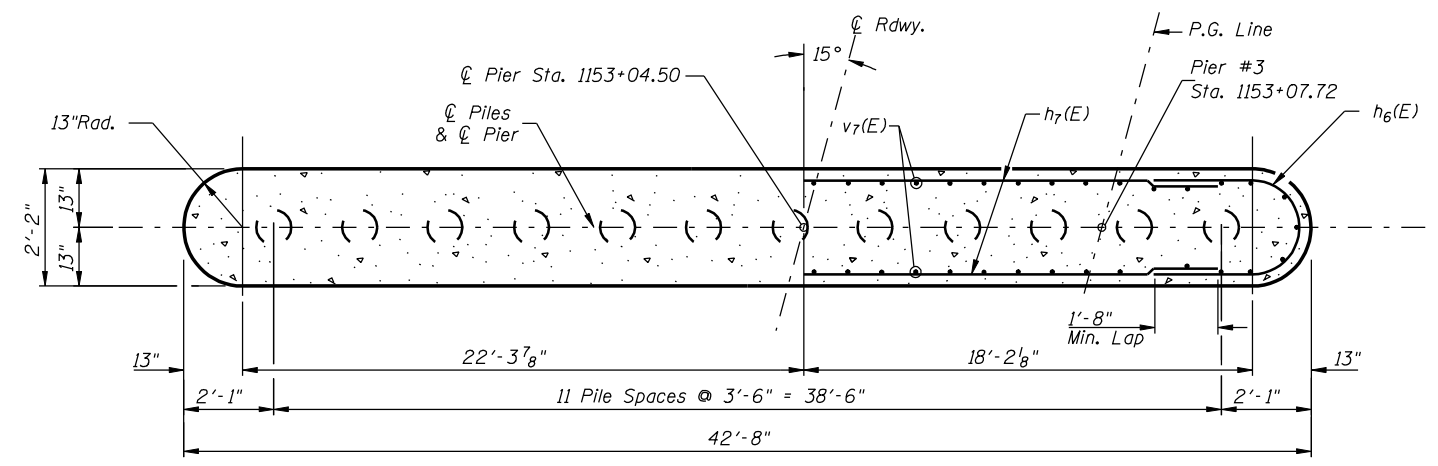
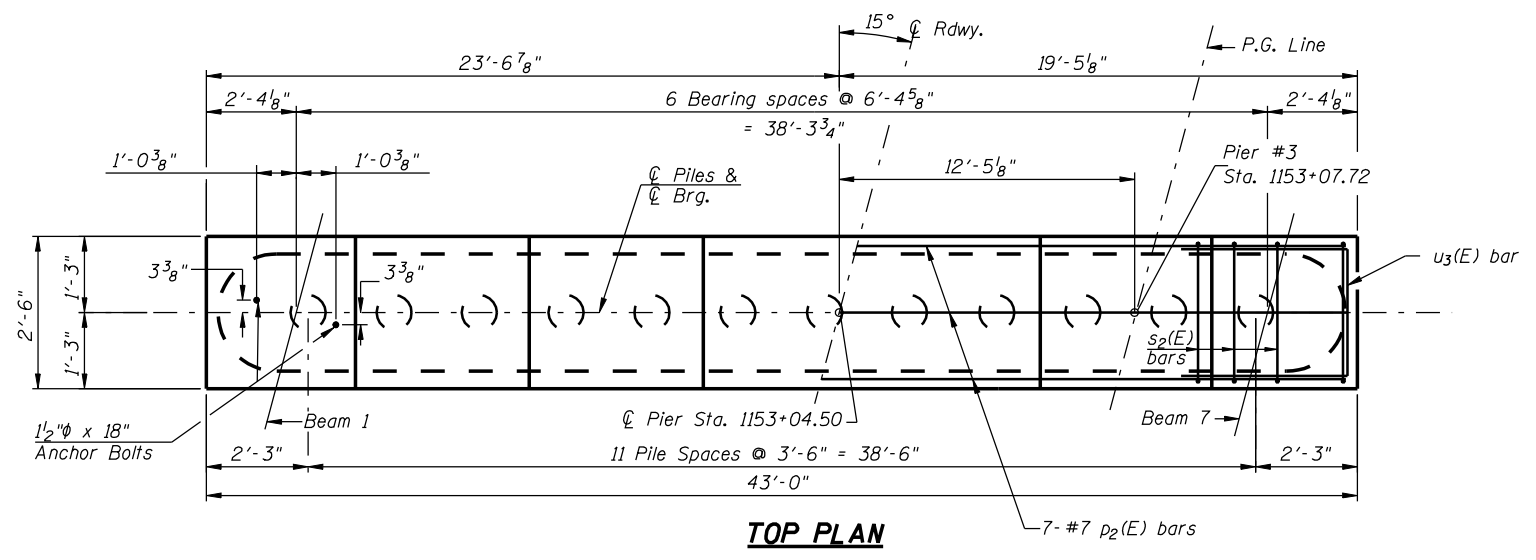

**BILL OF MATERIAL
BAR LIST FOR ONE PIER**

Bar	No.	Size	Length	Shape
h ₆ (E)	32	#5	8'-11"	—
h ₇ (E)	32	#5	38'-10"	—
p ₂ (E)	7	#7	42'-8"	—
s ₂ (E)	39	#4	10'-5"	□
u ₃ (E)	8	#6	11'-9"	—
v ₇ (E)	88	#5	16'-9"	—
Concrete Structures		CU YD	55.9	
Reinforcement Bars, Epoxy Coated		POUND	4,150	
Metal Pile Shells, 14"		FOOT	696	
Structure Excavation		CU YD	37	
Underwater Excavation Protection, Location 1		EACH	1	
Concrete Encasement		CU YD	21.3	

Reinforcement bars designated (E) shall be epoxy coated.

PIER 3
U.S. ROUTE 136 OVER
LAMOINE RIVER
F.A.P. RTE. 315 SECTION 34-4B-1
HANCOCK COUNTY
STATION 1153+07.72
STR. NO. 034-0508 (WBL)

HUTCHISON ENGINEERING, INC.
JACKSONVILLE, ILLINOIS
Date: January 31, 2006

DESIGNED	J.O.H.
CHECKED	B.R.T.
DRAWN	T.A.C.
CHECKED	J.O.H.