

F.A.P. RTE.	SECTION	COUNTY	TOTAL SHEETS	SHEET NO.
315	34-4	HANCOCK	452	304

STA. 964+00 TO STA. 965+00
 FED. ROAD DIST. NO. ILLINOIS FED. AID PROJECT

CONTRACT NO. 72680

BY	DATE

NO.

BY	DATE

NO.

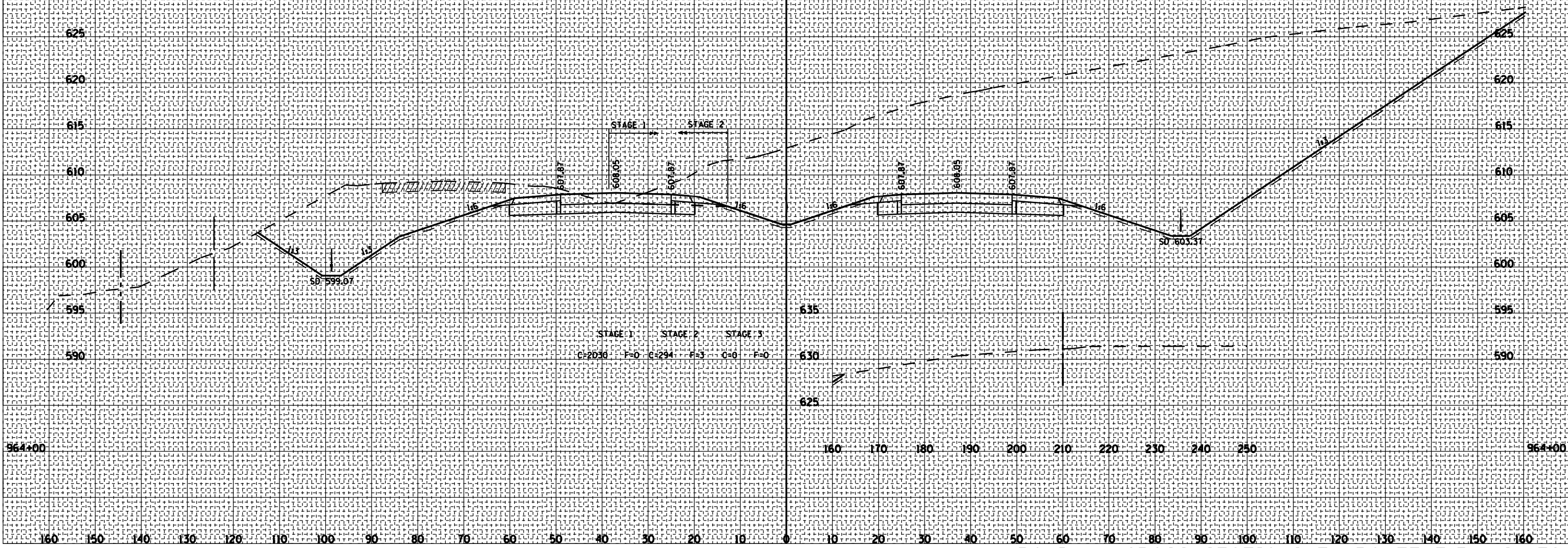
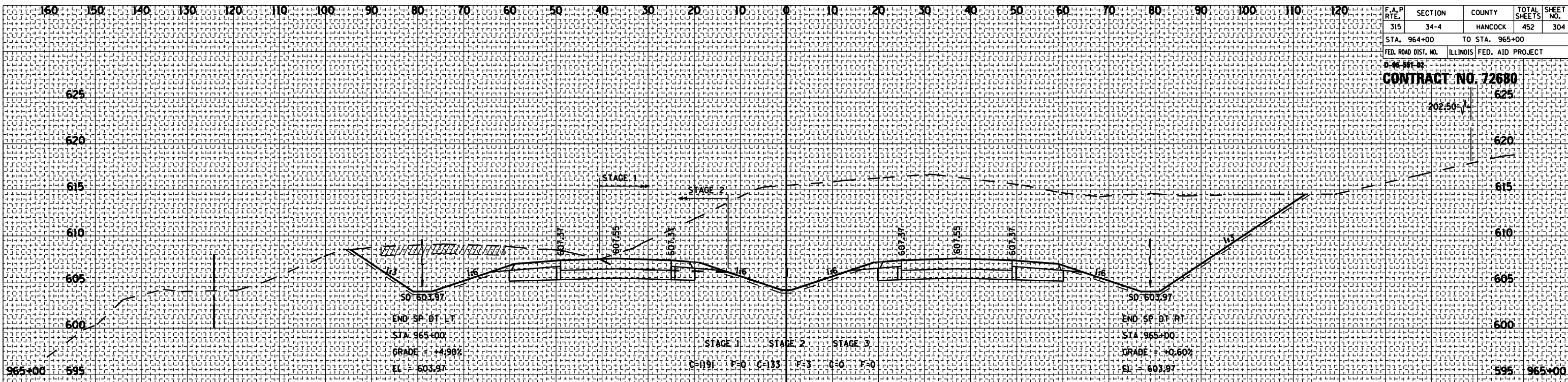

ROADWAY CROSS SECTIONS FA ROUTE 315 (US 136)