

F.A.P. RTE.	SECTION	COUNTY	TOTAL SHEETS	SHEET NO.
315	34-4	HANCOCK	452	329
STA. 997+00		TO STA. 999+00		
FED. ROAD DIST. NO.		ILLINOIS FED. AID PROJECT		

CONTRACT NO. 72680

BY	DATE

BY	DATE

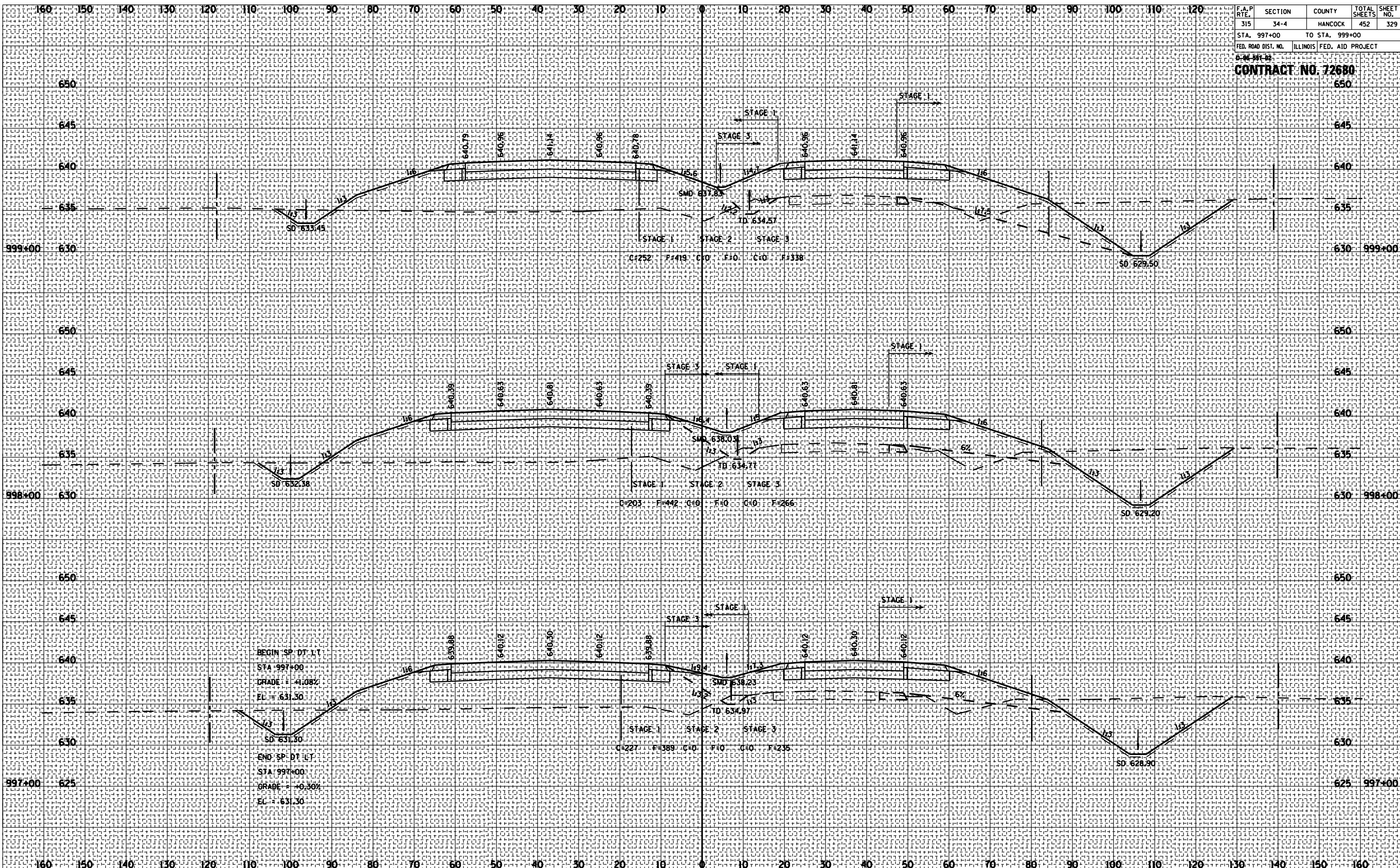

BEGIN SP. DT. LT.
 STA 997+00
 GRADE = +1.08%
 EL = 631.30
 SD 631.30

END SP. DT. LT.
 STA 997+00
 GRADE = +0.36%
 EL = 631.30

ROADWAY CROSS SECTIONS FA ROUTE 315 (US 136)