

F.A.P. RTE.	SECTION	COUNTY	TOTAL SHEETS	SHEET NO.
315	34-4	HANCOCK	452	367
STA. 1081+00		TO STA. 1081+00		
FED. ROAD DIST. NO.		ILLINOIS FED. AID PROJECT		

CONTRACT NO. 72680

BY	DATE

NO.	AREAS CHECKED

BY	DATE

NO.	AREAS CHECKED

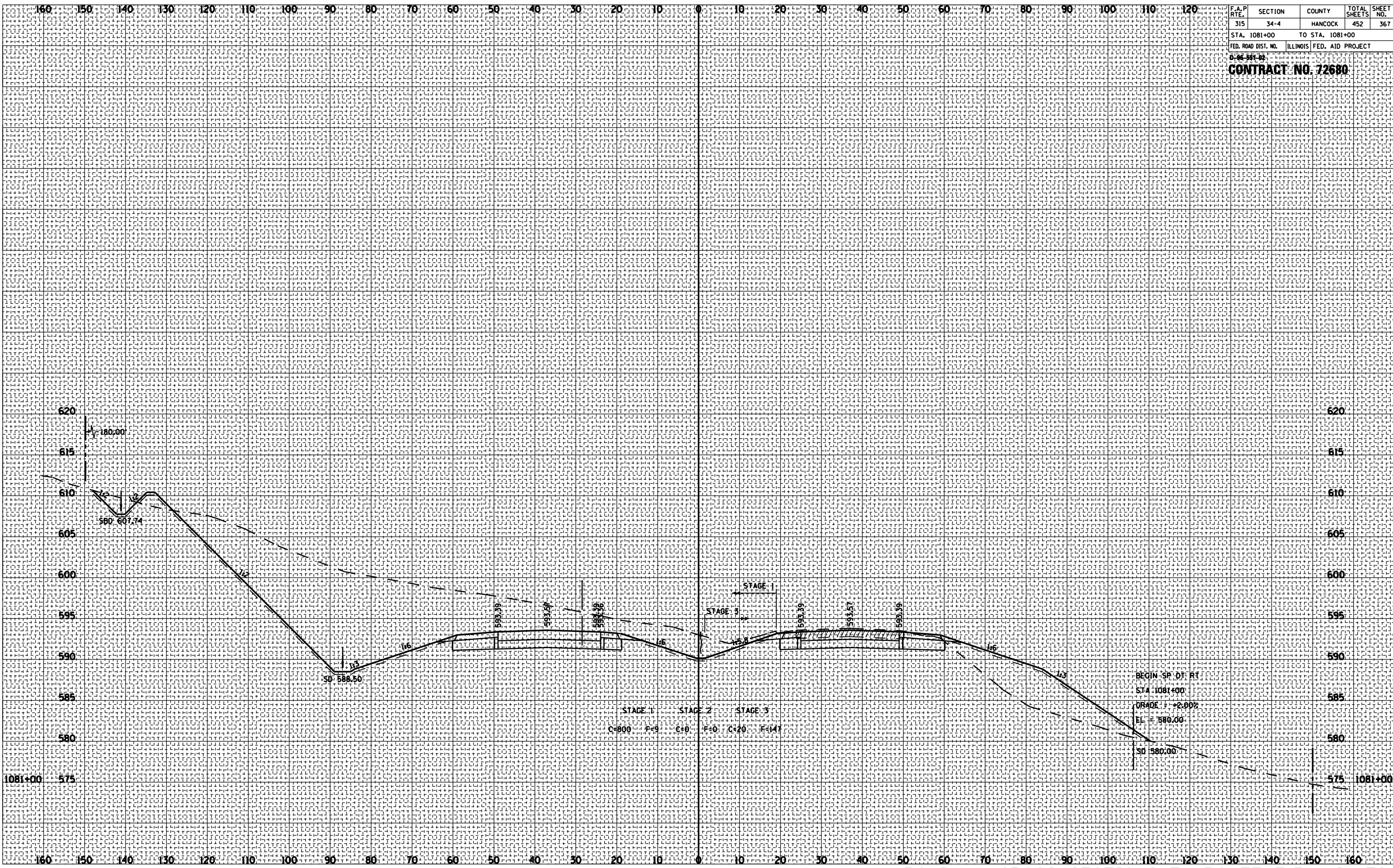

ROADWAY CROSS SECTIONS FA ROUTE 315 (US 136)