

F.A.P. RTE.	SECTION	COUNTY	TOTAL SHEETS	SHEET NO.
315	34-4	HANCOCK	452	400
STA. 1117+00		TO STA. 1118+00		
FED. ROAD DIST. NO.		ILLINOIS FED. AID PROJECT		

CONTRACT NO. 72680

BY	DATE

BY	DATE

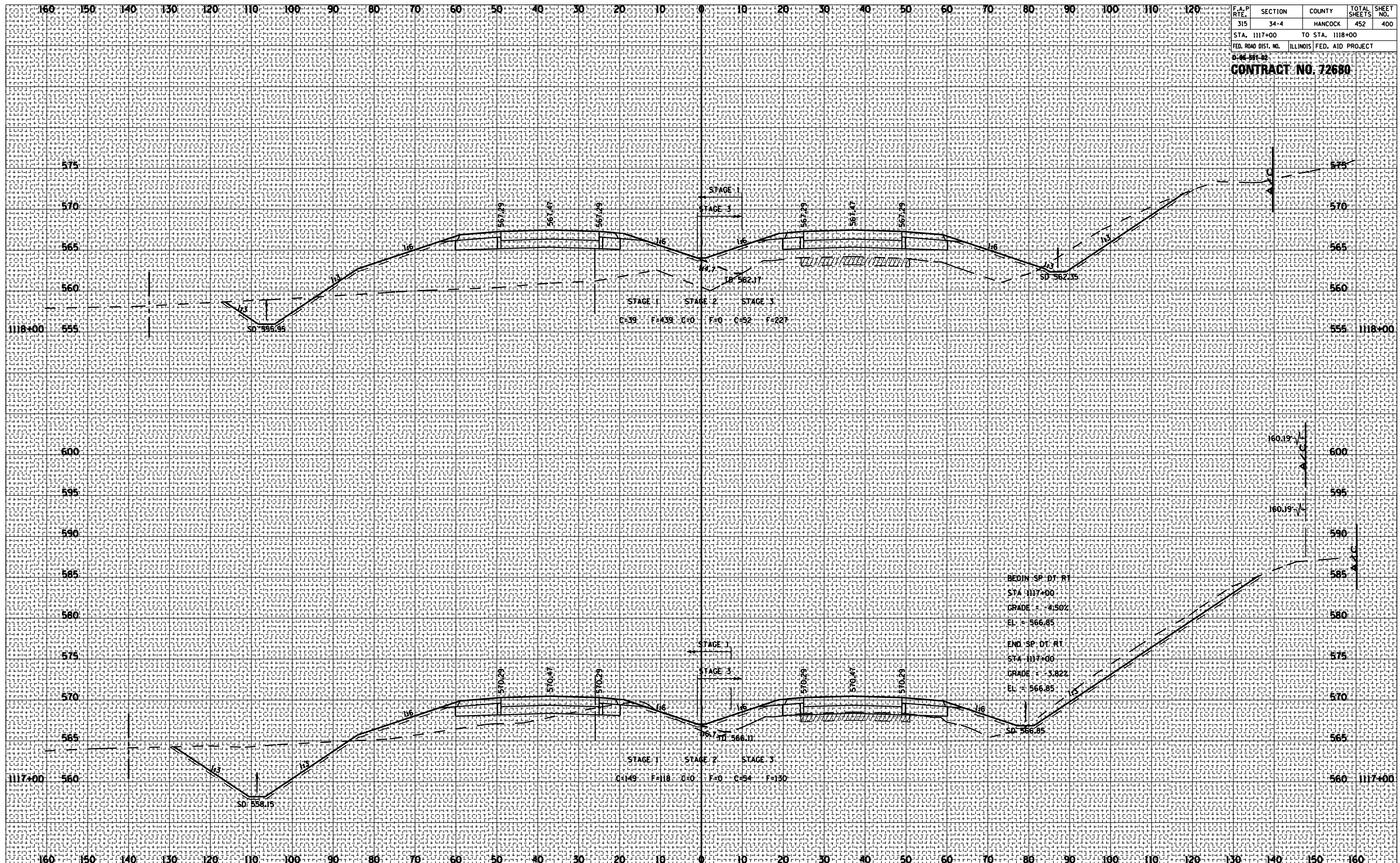

BEGIN SP-DT RT
 STA 1117+00
 GRADE = -4.50%
 EL = 566.85
 END SP-DT RT
 STA 1117+00
 GRADE = -3.82%
 EL = 566.85

ROADWAY CROSS SECTIONS FA ROUTE 315 (US 136)