

F.A. RTE.	SECTION	COUNTY	TOTAL SHEETS	SHEET NO.
103	27-1R	ST. CLAIR	382	60
STA. 135+00.00		TO STA. 147+00.00		
FED. ROAD DIST. NO. ILLINOIS FED. AID PROJECT				
CONTRACT NO. 76300				

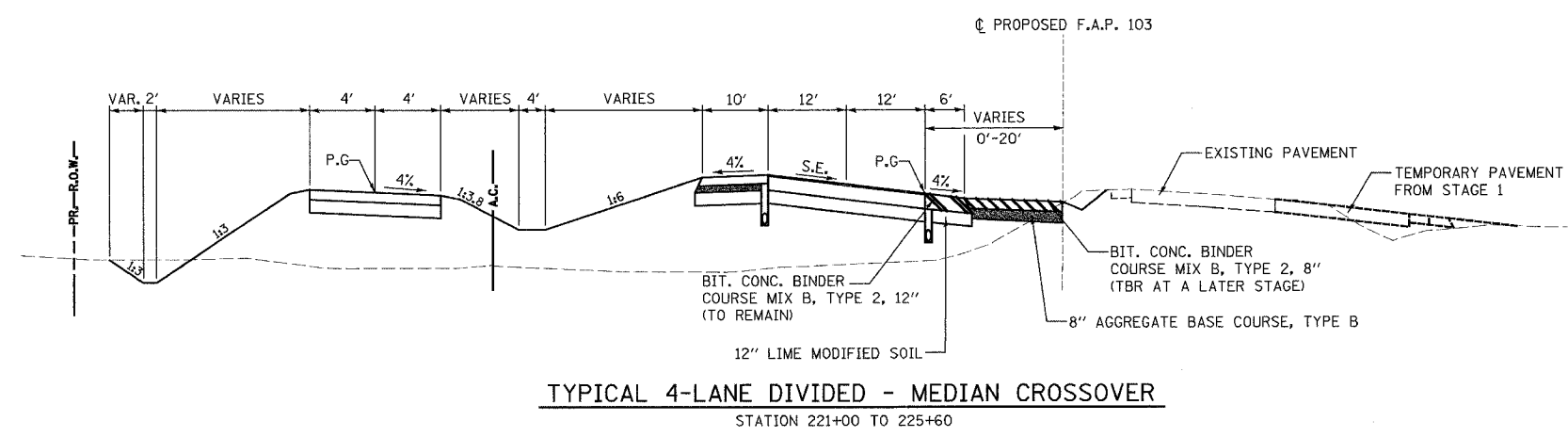

NOTES:

1. PRIOR TO CONSTRUCTING PROPOSED IMPROVEMENTS MILL EXISTING PAVEMENT AT ALL LOCATIONS WHERE THE PROPOSED PAVEMENT WIDENING EXCEEDS 2 FEET IN WIDTH AND WHERE PROPOSED CONCRETE CURBS OR MEDIANS ARE DOWELLED TO THE EXISTING PAVEMENT
2. FINAL SURFACE COURSE PLACEMENT ON THE PAVEMENT AND FINAL 2" LIFT ON THE SHOULDER TO OCCUR IN STAGE 4.

STAGE 2
DIVERT EASTBOUND TRAFFIC TO THE PROPOSED EASTBOUND LANES EAST OF GREEN MOUNT ROAD AND WIDEN, RESURFACE AND RECONSTRUCT WESTBOUND LANES FROM STA. 162+50 TO STA. 223+00 AND FROM STA. 265+10 TO STA. 292+57*. MAINTAIN TRAFFIC ON THE PROPOSED EASTBOUND LANES AND WIDEN THE EAST SIDE OF THE EXISTING PAVEMENT FROM STA. 292+57* TO STA. 338+10. COMPLETE CULVERTS AT STATIONS 167+81.52, 185+16.12, 196+21.58, 215+55.78, 274+50.00, 288+32.00 AND 300+82.43 LEFT OF CENTERLINE. CONSTRUCT ACCESS ROAD AT 163+20 LEFT

*WB EOP @ STATIONING

REFER TO SHEETS 84 THROUGH 90 FOR TRAFFIC CONTROL PLANS FOR STAGE 2 CONSTRUCTION.

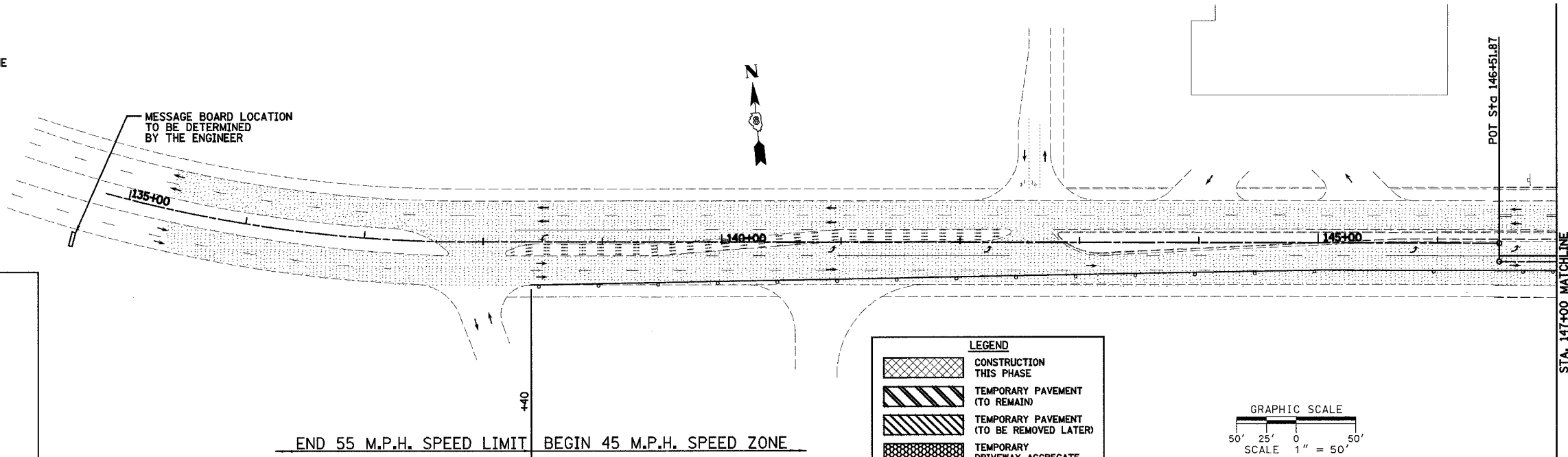

GENERAL NOTES:

THE CONTRACTOR SHALL MAINTAIN TEMPORARY ACCESS TO ALL ADJACENT PROPERTIES, PRIVATE DRIVES AND PUBLIC ROADWAYS THROUGHOUT THE LENGTH OF THE CONSTRUCTION CONTRACT. ALL EARTHWORK AND SUBGRADE PREPARATION REQUIRED FOR MAINTAINING TEMPORARY ACCESS WILL NOT BE MEASURED AND PAID FOR SEPERATELY BUT SHALL BE CONSIDERED INCLUDED IN THE CONTRACT UNIT PRICE PER TON FOR AGGREGATE FOR TEMPORARY ACCESS.

REMOVAL OF TEMPORARY ACCESS MATERIALS INCLUDING: TEMPORARY AGGREGATE, ACCESS PIPE CULVERTS AND EARTH EMBANKMENTS WILL NOT BE MEASURED AND PAID FOR SEPERATELY BUT SHALL BE CONSIDERED INCLUDED IN THE CONTRACT UNIT PRICE PER TON FOR AGGREGATE FOR TEMPORARY ACCESS, PER FOOT FOR PIPE CULVERTS(TEMPORARY) AND PER CUBIC YARD FOR EARTH EXCAVATION.

THE CONTRACTOR SHALL MAINTAIN DRAINAGE BY CONSTRUCTING TEMPORARY DITCHES AND CULVERTS AS SHOWN ON THE PLANS AND CROSS SECTIONS AND AS NECESSARY TO AVOID FLOODING OF ROADWAY AND ADJACENT PROPERTIES.

LEGEND

[Cross-hatch pattern]	CONSTRUCTION THIS PHASE
[Diagonal lines /]	TEMPORARY PAVEMENT (TO REMAIN)
[Diagonal lines \]	TEMPORARY PAVEMENT (TO BE REMOVED LATER)
[Stippled pattern]	TEMPORARY DRIVEWAY AGGREGATE
[Dotted pattern]	EXISTING PAVEMENT
[Arrow]	DIRECTION OF TRAFFIC FLOW THIS STAGE
[T-bar symbol]	TYPE III BARRICADE
[Circle with X]	DRUM OR BARRICADE W/ STEADY BURN LIGHTS
[Dashed line]	TEMPORARY DITCH
[Wavy line]	PROPOSED DITCH

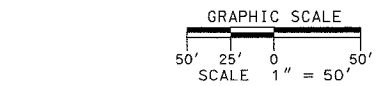

REVISIONS	
NAME	DATE

ILLINOIS DEPARTMENT OF TRANSPORTATION
CONSTRUCTION PLAN - STAGE 2
SHEET 1 OF 7
F.A.P. 103 (IL. RTE. 13/15)
SECTION 27-1R - ST. CLAIR CO.
SCALE: 1" = 50'
DATE **February 11, 2005**
DRAWN BY **CRO**
CHECKED BY **RCY**

DATE	
BY	
SURVEYED	
ALIGNED	
CHECKED	
BY	
NOTE BOOK	
NO.	
PLAN	
NO.	

DATE	
BY	
SURVEYED	
ALIGNED	
CHECKED	
BY	
NOTE BOOK	
NO.	
PLAN	
NO.	

J:\2005\02058\1000\civil\stage2\stage2_constr_stage2.dwg 3/9/2005 1:46:40 PM