

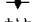



F.A. RTE.	SECTION	COUNTY	TOTAL SHEETS	SHEET NO.
103	27-1R	ST. CLAIR	382	111
STA. 324+00.00		TO STA. 336+00.00		
FED. ROAD DIST. NO.		ILLINOIS	FED. AID PROJECT	
CONTRACT NO. 76300				

- TEMPORARY EROSION CONTROL LEGEND**
-  RIPRAP TO REMAIN AFTER CONSTRUCTION
 -  TEMPORARY DITCH CHECK
 -  EROSION CONTROL FIBER BLANKET, 6 FT. WIDE MINIMUM
 -  PERIMETER EROSION BARRIER, SILT FILTER FENCE OR OTHER AS APPROVED BY THE ENGINEER
 -  INLET AND PIPE PROTECTION, STRAW BALES OR SILT FILTER FENCE
 -  FLOW DIRECTION

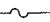
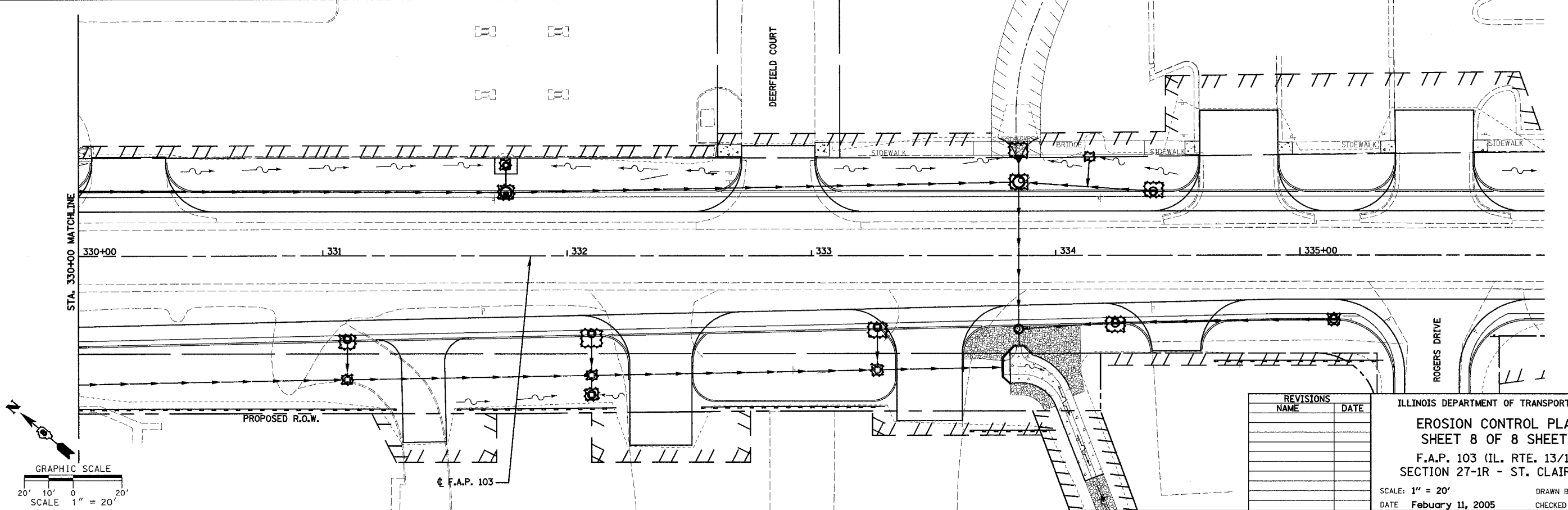
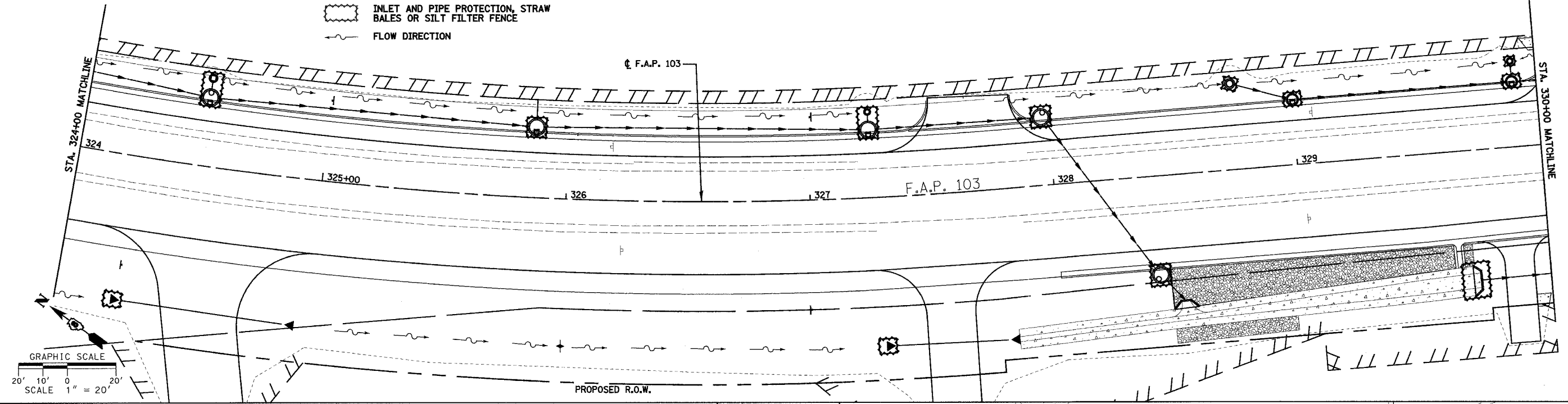

REVISIONS	
NAME	DATE

ILLINOIS DEPARTMENT OF TRANSPORTATION
EROSION CONTROL PLAN
SHEET 8 OF 8 SHEETS
 F.A.P. 103 (IL. RTE. 13/15)
 SECTION 27-1R - ST. CLAIR CO.
 SCALE: 1" = 20'
 DATE: February 11, 2005
 DRAWN BY: CRO
 CHECKED BY: RCY

I:\2002\0205R\000\CIVIL\gpr\eroc_sheets.dgn 3/9/2005 8:43 PM