

160 150 140 130 120 110 100 90 80 70 60 50 40 30 20 10 0 10 20 30 40 50 60 70 80 90 100 110 120

PROP. F.A.P. 103

F.A. RTE.	SECTION	COUNTY	TOTAL SHEETS	SHEET NO.
103	27-1R	ST. CLAIR	382	259
STA.		TO STA.		
FED. ROAD DIST. NO.		ILLINOIS FED. AID PROJECT		
CONTRACT NO. 76300				

DATE	
BY	
FINAL SURVEY	
NO. OF SHEETS	
NO. OF PAGES	
NO. OF PLANS	
NO. OF SECTIONS	
NO. OF DETAILS	
NO. OF ELEVATIONS	
NO. OF AREAS CHECKED	

DATE	
BY	
ORIGINAL SURVEY	
NO. OF SHEETS	
NO. OF PAGES	
NO. OF PLANS	
NO. OF SECTIONS	
NO. OF DETAILS	
NO. OF ELEVATIONS	
NO. OF AREAS CHECKED	

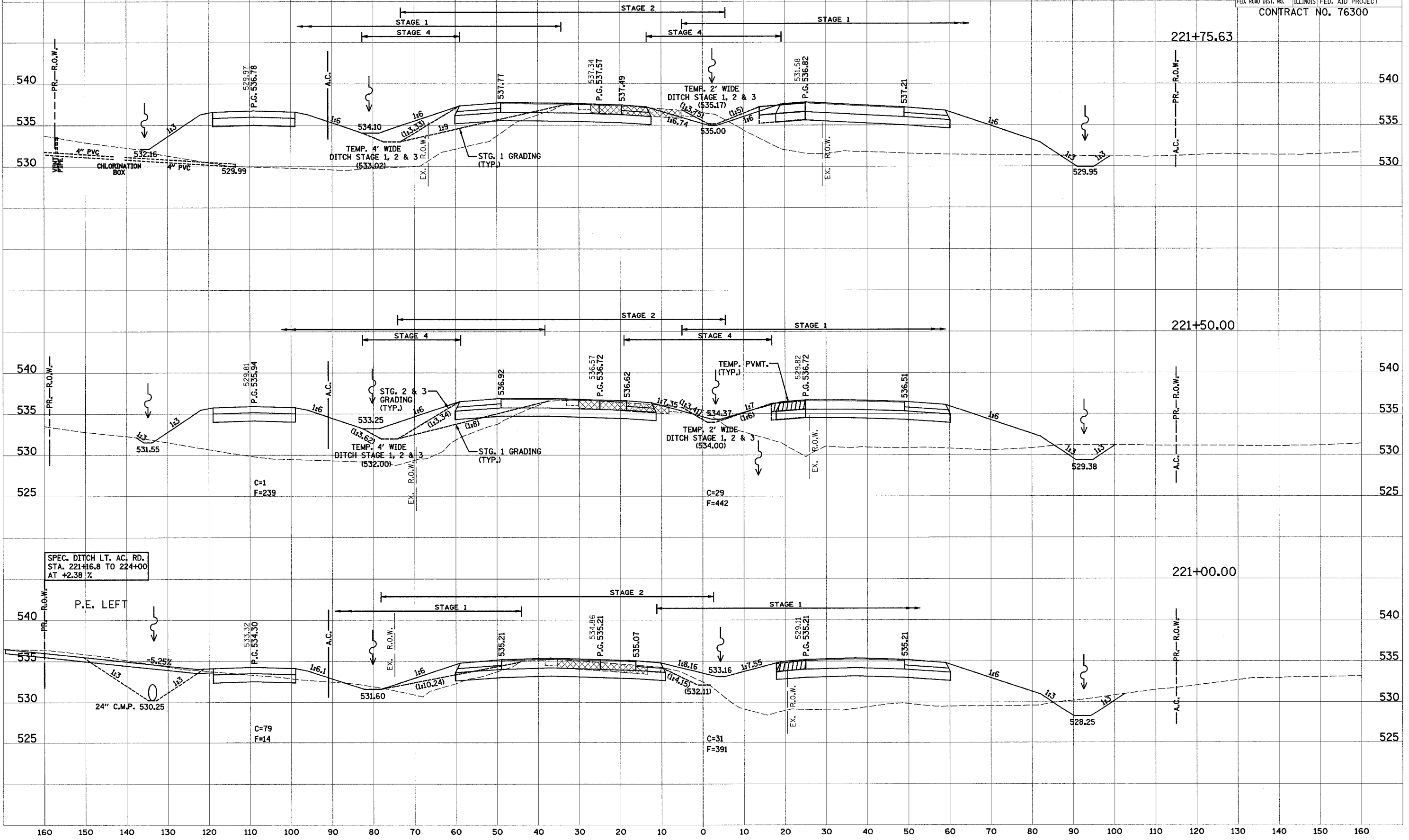

SPEC. DITCH LT. AC. RD.
 STA. 221+16.8 TO 224+00
 AT +2.38 %

P.E. LEFT

24" C.M.P. 530.25