

160 150 140 130 120 110 100 90 80 70 60 50 40 30 20 10 0 10 20 30 40 50 60 70 80 90 100 110 120

PROP. F.A.P. 103

F.A. RTE.	SECTION	COUNTY	TOTAL SHEETS	SHEET NO.
103	27-1R	ST. CLAIR	382	268
STA.		TO STA.		
FED. ROAD DIST. NO.		ILLINOIS	FED. AID PROJECT	
CONTRACT NO. 76300				

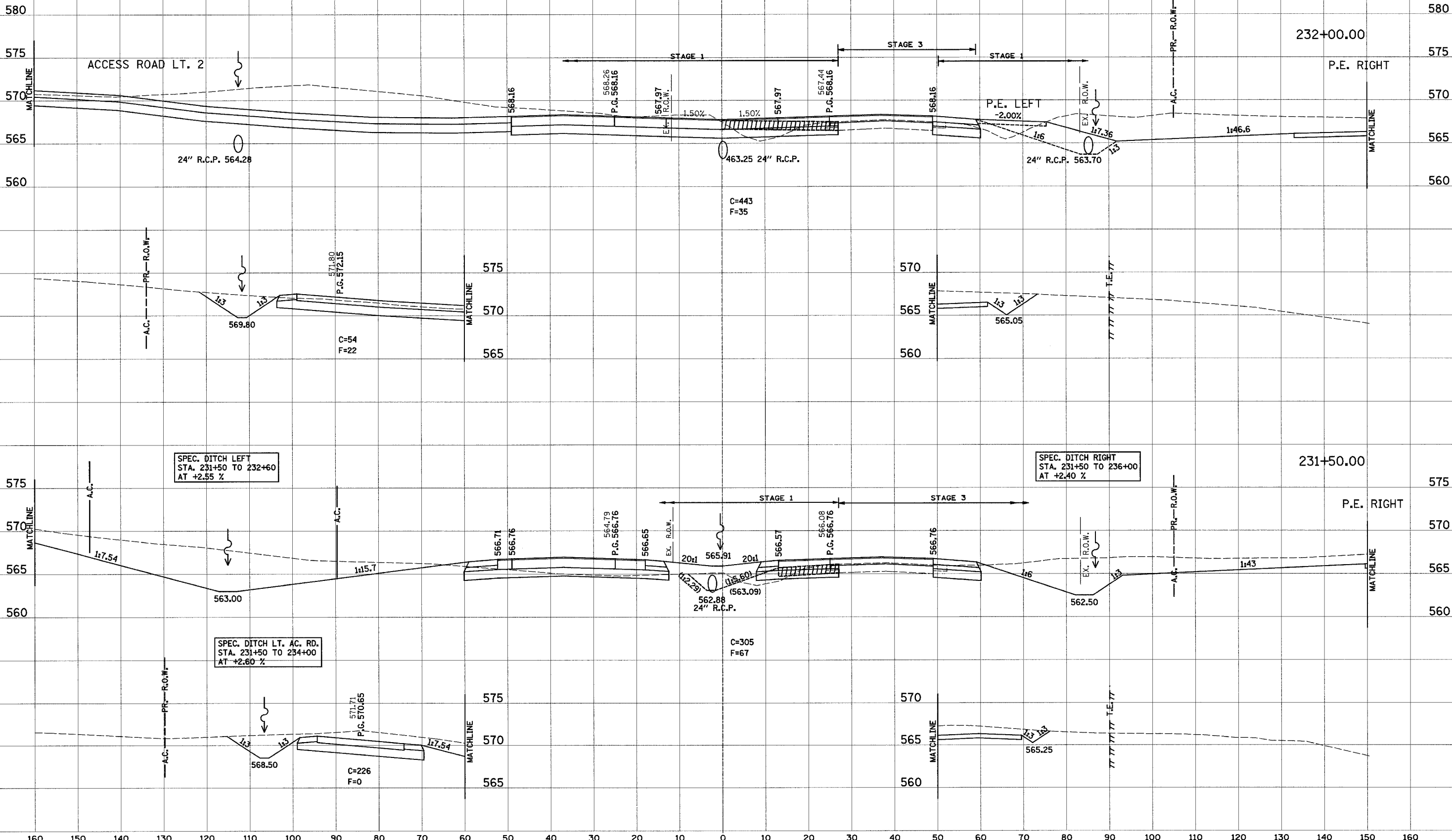

ACCESS ROAD LT. 2

STAGE 1

STAGE 3

STAGE 1

P.E. LEFT
-2.00%

232+00.00

P.E. RIGHT

24" R.C.P. 564.28

463.25 24" R.C.P.

24" R.C.P. 563.70

C=443
F=35

C=54
F=22

C=305
F=67

SPEC. DITCH LEFT
STA. 231+50 TO 232+60
AT +2.55 %

SPEC. DITCH RIGHT
STA. 231+50 TO 236+00
AT +2.40 %

SPEC. DITCH LT. AC. RD.
STA. 231+50 TO 234+00
AT +2.60 %

231+50.00

P.E. RIGHT

DATE
BY
SURVEYED
TEMPLATE
AREAS
NO. CHECKED

DATE
BY
ORIGINAL SURVEY
TEMPLATE
AREAS
NO. CHECKED