

160 150 140 130 120 110 100 90 80 70 60 50 40 30 20 10 0 10 20 30 40 50 60 70 80 90 100 110 120

PROP. F.A.P. 103

F.A. RTE.	SECTION	COUNTY	TOTAL SHEETS	SHEET NO.
103	27-1R	ST. CLAIR	382	269
STA.		TO STA.		
FED. ROAD DIST. NO.		ILLINOIS	FED. AID PROJECT	
CONTRACT NO. 76300				

232+50.00

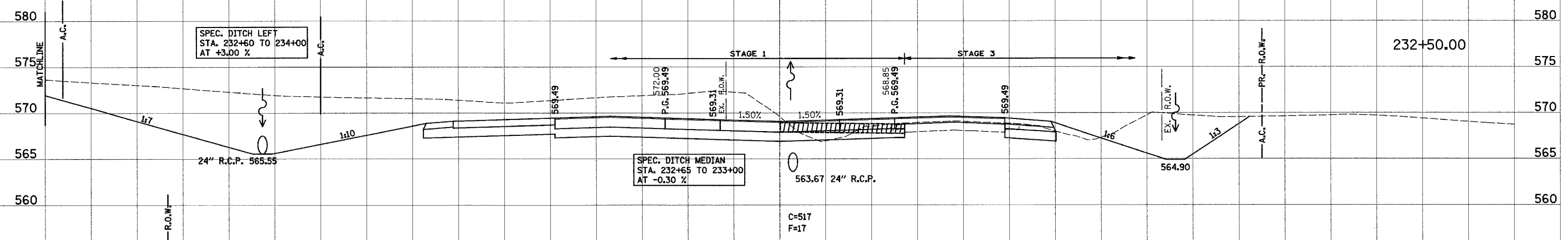

SPEC. DITCH MEDIAN
STA. 232+65 TO 233+00
AT -0.30 %

SPEC. DITCH LEFT
STA. 232+60 TO 234+00
AT +3.00 %

DATE	BY
DATE	BY
DATE	BY
DATE	BY

DATE	BY
DATE	BY
DATE	BY
DATE	BY

232+14.11

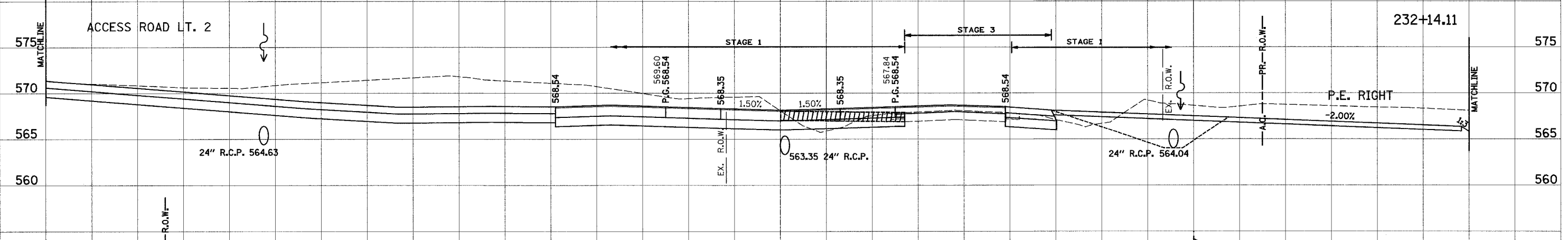

P.E. RIGHT
-2.00%

24" R.C.P. 564.63

24" R.C.P. 563.35

24" R.C.P. 564.04

DATE	BY
DATE	BY
DATE	BY
DATE	BY

160 150 140 130 120 110 100 90 80 70 60 50 40 30 20 10 0 10 20 30 40 50 60 70 80 90 100 110 120 130 140 150 160