

160 150 140 130 120 110 100 90 80 70 60 50 40 30 20 10 0 10 20 30 40 50 60 70 80 90 100 110 120

PROP. F.A.P. 103

F.A. RTE.	SECTION	COUNTY	TOTAL SHEETS	SHEET NO.
103	27-1R	ST. CLAIR	382	346
STA.		TO STA.		
FED. ROAD DIST. NO.	ILLINOIS	FED. AID PROJECT		
CONTRACT NO. 76300				

336+50.00

336+00.00

335+50.00

335+00.00

FINAL SURVEY	DATE
BY	
SURVEYED	
NOTE BOOK	
NO.	
AREAS CHECKED	

ORIGINAL SURVEY	DATE
BY	
SURVEYED	
NOTE BOOK	
NO.	
AREAS CHECKED	

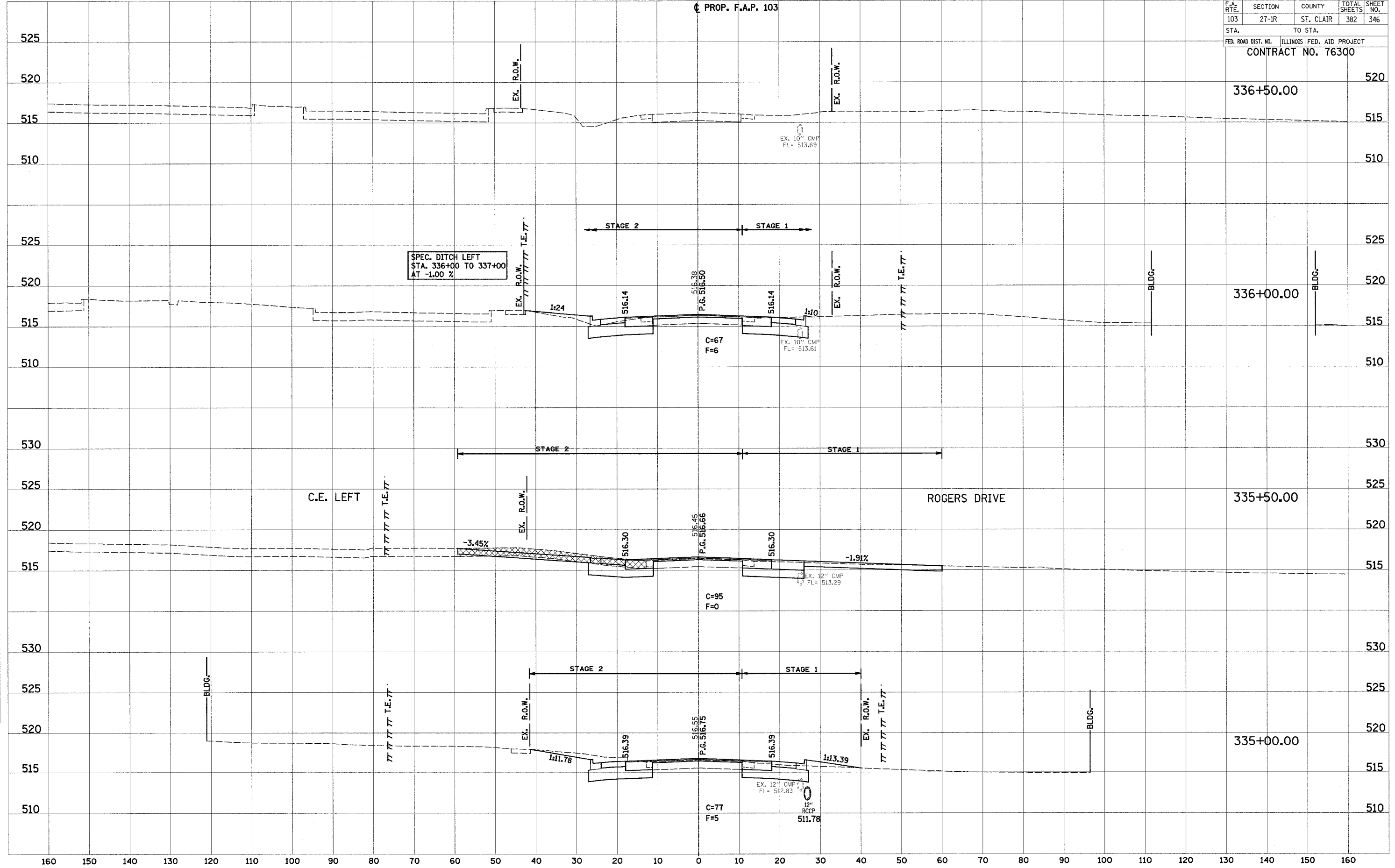

SPEC. DITCH LEFT
STA. 336+00 TO 337+00
AT -1.00 %

C.E. LEFT

ROGERS DRIVE

EX. 10" CMP
FL = 513.69

EX. 10" CMP
FL = 513.61

EX. 12" CMP
FL = 513.29

EX. 12" RCCP
FL = 512.83

12" RCCP
511.78

STAGE 2 STAGE 1

STAGE 2 STAGE 1

STAGE 2 STAGE 1

EX. R.O.W.

EX. R.O.W.

EX. R.O.W.

EX. R.O.W.

EX. R.O.W.

EX. R.O.W.

T.T. T.T. T.T. T.T.

T.T. T.T. T.T. T.T.

BLDG.

BLDG.

BLDG.

BLDG.

160 150 140 130 120 110 100 90 80 70 60 50 40 30 20 10 0 10 20 30 40 50 60 70 80 90 100 110 120 130 140 150 160