

160 150 140 130 120 110 100 90 80 70 60 50 40 30 20 10 0 10 20 30 40 50 60 70 80 90 100 110 120

PROP. F.A.P. 103

F.A. RTE.	SECTION	COUNTY	TOTAL SHEETS	SHEET NO.
103	27-1R	ST. CLAIR	382	349
STA.		TO STA.		
FED. ROAD DIST. NO.	ILLINOIS	FED. AID PROJECT		
CONTRACT NO. 76300				

99+51.00
49.00' LT.

99+10.69
89.31' LT.

99+00.00
100.00' LT.

98+75.00
125.00' LT.

98+64.00
136.00' LT.

JEFFERSON ROAD
STA. 206+36.83 LT.

FINAL SURVEY BY DATE
SURVEYED BY DATE
NOTE BOOK NO. DATE
TEMPLATE AREAS CHECKED

ORIGINAL SURVEY BY DATE
SURVEYED BY DATE
NOTE BOOK NO. DATE
TEMPLATE AREAS CHECKED

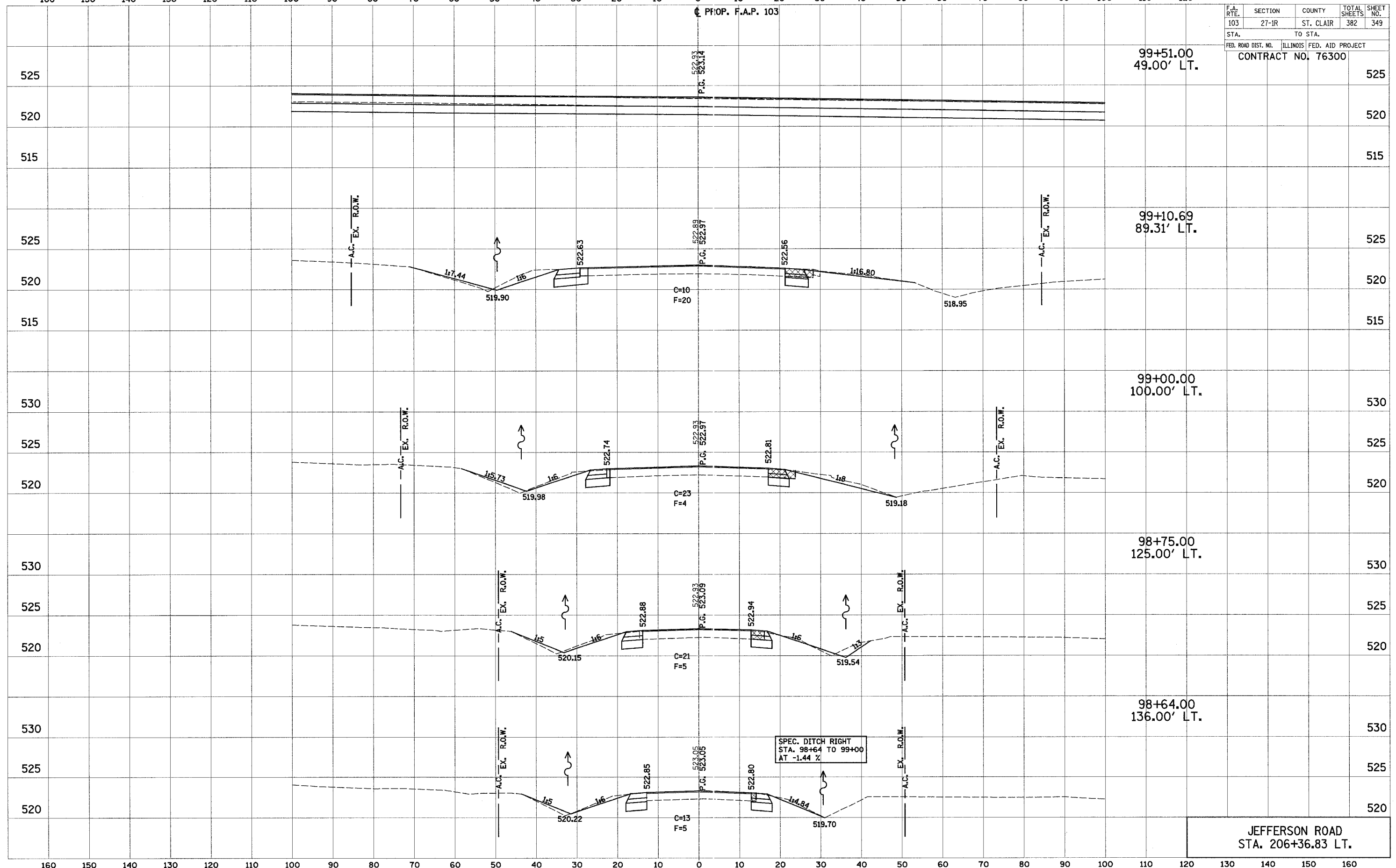

SPEC. DITCH RIGHT
STA. 98+64 TO 99+00
AT -1.44 %