

F.A.P. RTE.	SECTION	COUNTY	TOTAL SHEETS	SHEET NO.
312	66-31	MONROE	45	16
STA. 630+00 TO STA. 624+00				
FED. ROAD DIST. NO. ILLINOIS FED. AID PROJECT				

EXIST. CURVE C100  
 PI STA. = 628+33.82  
 $\Delta = 0^\circ 10' 58''$  (LT)  
 $D = 0^\circ 03' 18''$   
 $R = 104,153.24'$   
 $T = 166.19'$   
 $L = 332.37'$   
 $E = 0.13'$   
 $e = \text{-----}$   
 T.R. = -----  
 S.E. RUN = -----  
 P.C. STA. = 626+67.63  
 P.T. STA. = 630+00.00

EXIST. CURVE C200  
 PI STA. = 625+16.16  
 $\Delta = 2^\circ 42' 52''$  (RT)  
 $D = 0^\circ 53' 45''$   
 $R = 6,395.76'$   
 $T = 151.53'$   
 $L = 303.00'$   
 $E = 1.79'$   
 $e = \text{-----}$   
 T.R. = -----  
 S.E. RUN = -----  
 P.C. STA. = 623+64.63  
 P.T. STA. = 626+67.63

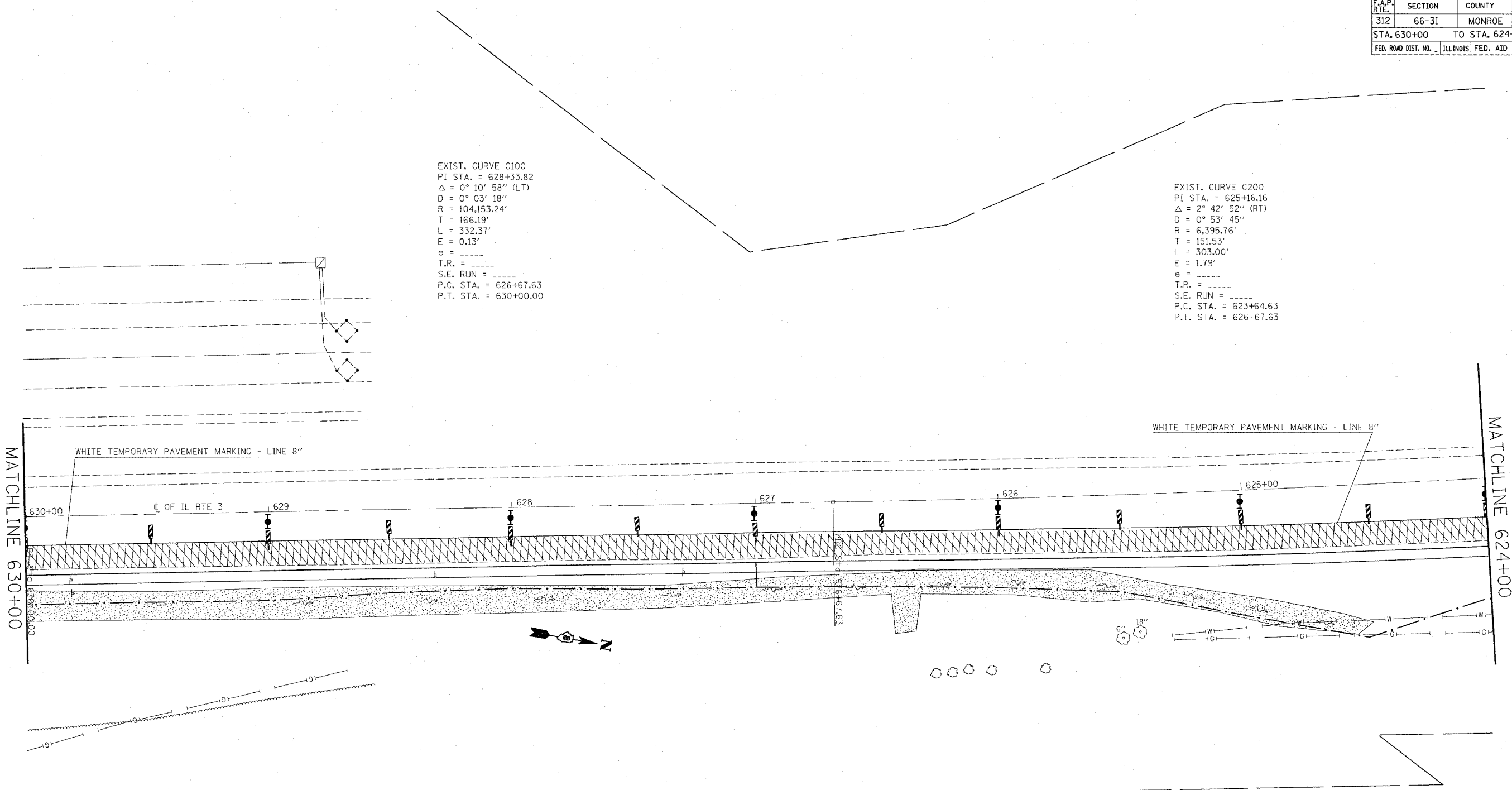

NOTES:

VERTICAL PANELS ARE TO BE INSTALLED ALONG THE EDGE OF PAVEMENT OF NORTHBOUND IL 3 DURING THE PERIOD WHEN THE TRENCH IS MORE THAN 12" DEEP; THEN EXTENDED LEG BARRICADES WITH STEADY BURNING LIGHTS SHALL BE USED IN THE DROPOFFS DURING PERIODS WHEN ALL LANES ARE OPEN TO TRAFFIC.

STANDARD 701501 SHALL BE USED ON NORTH MAIN STREET AND STANDARD 701422 SHALL BE USED ON NORTHBOUND IL 3. THE COST OF THE APPLICATION OF THESE STANDARDS AND ALL TRAFFIC CONTROL DEVICES AS HEREIN SPECIFIED AND ANY ADDITIONAL TRAFFIC CONTROL INCLUDING FLAGGERS AS DEEMED NECESSARY BY THE RESIDENT ENGINEER SHALL BE INCLUDED IN THE CONTRACT LUMP SUM PRICE FOR TRAFFIC CONTROL AND PROTECTION (SPECIAL).

- WORK AREA
- BARRICADE WITH STEADY BURNING LIGHT
- VERTICAL PANELS AT 50' CENTERS

REVISIONS	
NAME	DATE

ILLINOIS DEPARTMENT OF TRANSPORTATION  
**TRAFFIC CONTROL PLAN**  
 FAP ROUTE 312  
 SECTION 66-31  
 MONROE COUNTY

SCALE: VERT. \_\_\_\_\_  
 HORIZ. \_\_\_\_\_  
 DATE \_\_\_\_\_  
 DRAWN BY \_\_\_\_\_  
 CHECKED BY \_\_\_\_\_

PLOT DATE\$DATE\$  
 FILE NAME\$FILE\$  
 PLOT SCALE\$SCALE\$  
 REFERENCE\$REF\$