

F.A.P. RTE.	SECTION	COUNTY	TOTAL SHEETS	SHEET NO.
312	66-3I	MONROE	45	20
STA. 630+00 TO STA. 624+00				
FED. ROAD DIST. NO. ILLINOIS		FED. AID PROJECT		

EXIST. CURVE C100
 PI STA. = 628+33.82
 $\Delta = 0^\circ 10' 58''$ (LT)
 $D = 0^\circ 03' 18''$
 $R = 104,153.24'$
 $T = 166.19'$
 $L = 332.37'$
 $E = 0.13'$
 $e = \text{-----}$
 $T.R. = \text{-----}$
 $S.E. \text{ RUN} = \text{-----}$
 $P.C. \text{ STA.} = 626+67.63$
 $P.T. \text{ STA.} = 630+00.00$

EXIST. CURVE C200
 PI STA. = 625+16.16
 $\Delta = 2^\circ 42' 52''$ (RT)
 $D = 0^\circ 53' 45''$
 $R = 6,395.76'$
 $T = 151.53'$
 $L = 303.00'$
 $E = 1.79'$
 $e = \text{-----}$
 $T.R. = \text{-----}$
 $S.E. \text{ RUN} = \text{-----}$
 $P.C. \text{ STA.} = 623+64.63$
 $P.T. \text{ STA.} = 626+67.63$

MATCHLINE 630+00

MATCHLINE 624+00

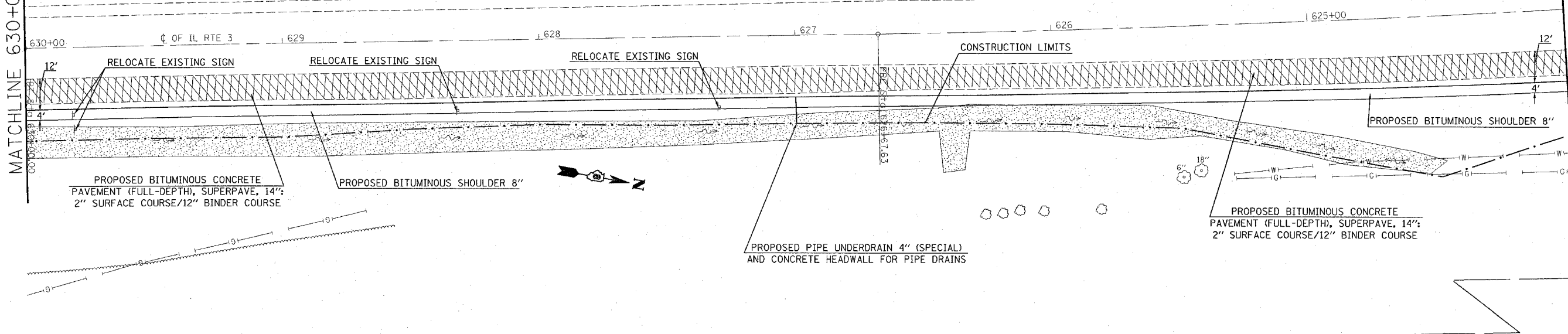

NOTES:

MODIFIED SOIL 12" SHALL BE PREPARED FOR PLACEMENT OF PROPOSED BITUMINOUS CONCRETE PAVEMENT (FULL-DEPTH), SUPERPAVE, 14".

REMOVAL OF EXISTING UNDERDRAINS, OUTLETS, CONCRETE HEADWALL FOR UNDERDRAIN, AND DELINEATORS SHALL BE INCLUDED IN THE COST OF EARTHWORK.

 PAVED SHOULDER REMOVAL

REVISIONS	
NAME	DATE

ILLINOIS DEPARTMENT OF TRANSPORTATION

PLAN SHEET

FAP ROUTE 312
 SECTION 66-3I
 MONROE COUNTY

SCALE: VERT. _____
 HORIZ. _____
 DATE _____

DRAWN BY _____
 CHECKED BY _____

PLOT DATE = #DATE*
 FILE NAME = #FILE*
 PLOT SCALE = #SCALE*
 REFERENCE = #REF*