

F.A.P. RTE.	SECTION	COUNTY	TOTAL SHEETS	SHEET NO.
312	66-3I	MONROE	45	26
STA. 116+55.54 TO STA. 115+50				
FED. ROAD DIST. NO. ILLINOIS		FED. AID PROJECT		

NOTE:

ALL PAVEMENT MARKINGS SHALL BE IN ACCORDANCE WITH STANDARD 780001 UNLESS SHOWN OTHERWISE.

EXIST. CURVE C1
 PI STA. = 115+12.13
 $\Delta = 40^\circ 26' 05''$ (RT)
 $D = 13^\circ 28' 53''$
 $R = 425.00'$
 $T = 156.52'$
 $L = 299.93'$
 $E = 27.90'$
 $e = \text{-----}$
 $T.R. = \text{-----}$
 $S.E. \text{ RUN} = \text{-----}$
 $P.C. \text{ STA.} = 113+55.61$
 $P.T. \text{ STA.} = 116+55.54$

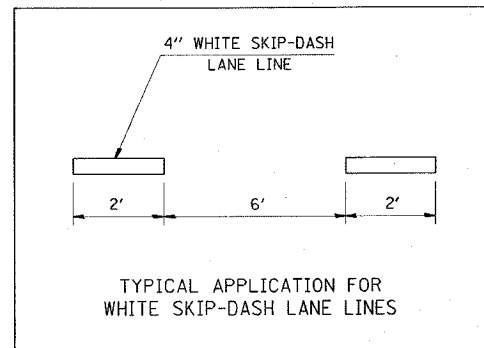
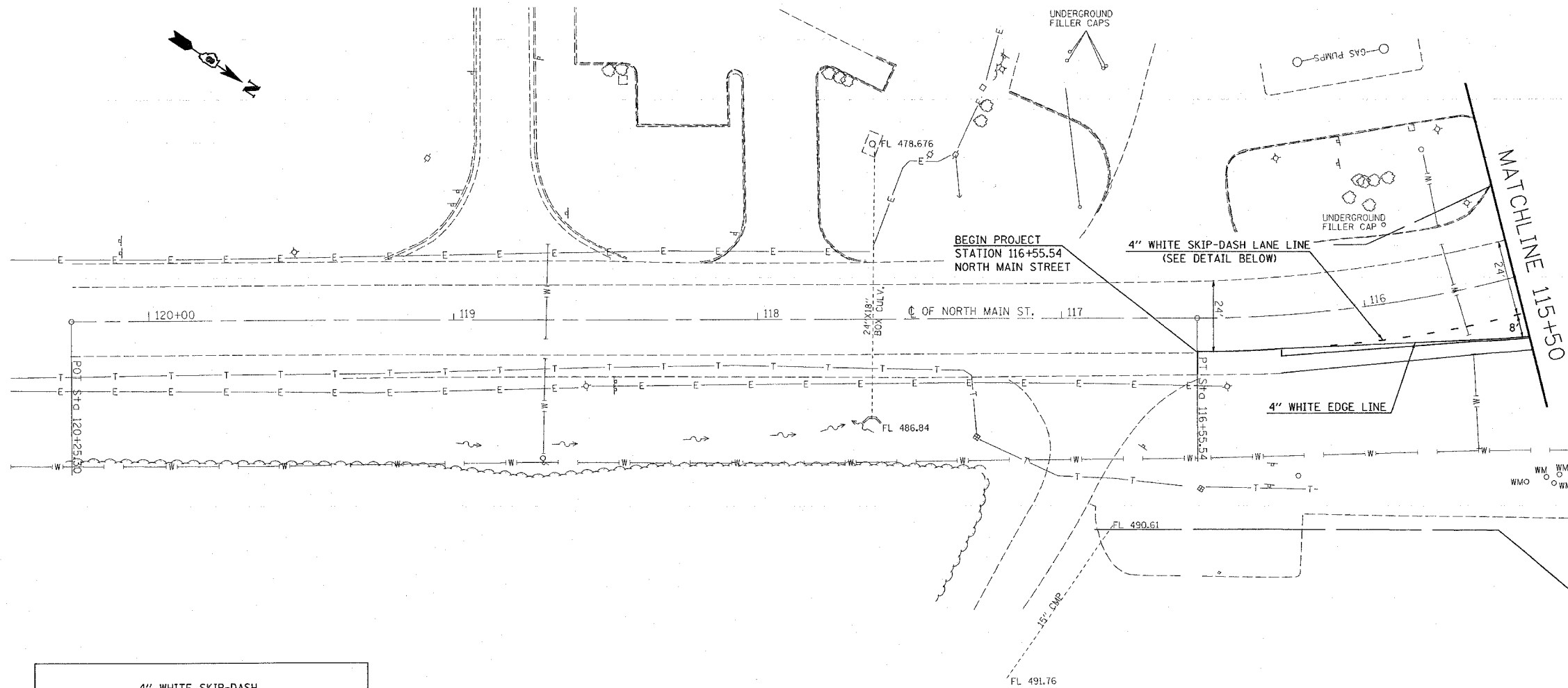

PLOT DATE = 04/27/08
 FILE NAME = #FILE#
 PLOT SCALE = #SCALE#
 REFERENCE = #REF#

REVISIONS	
NAME	DATE

ILLINOIS DEPARTMENT OF TRANSPORTATION
PAVEMENT MARKING AND SIGNING PLAN
 FAP ROUTE 312
 SECTION 66-3I
 MONROE COUNTY

SCALE: VERT. _____
 HORIZ. _____
 DATE _____

DRAWN BY _____
 CHECKED BY _____