

F&M ROUTE	SECTION	COUNTY	TOTAL SHEETS	SHEET NO.
0306	*	WILL	118	49
FHWA REGION NO.	ILLINOIS	PROJECT M-8003(200)		
* 01-00029-00-FP			CONTRACT NO. 83825	

- [A] SANITARY MANHOLES TO BE ADJUSTED
- [B] VALVE VAULTS TO BE ADJUSTED
- [C] INLETS TO BE ADJUSTED
- [D] CATCH BASINS TO BE ADJUSTED
- [E] FIRE HYDRANTS TO BE RELOCATED
- [F] REMOVING CATCH BASINS
- [G] VALVE BOXES TO BE ADJUSTED
- [H] REMOVING MANHOLES

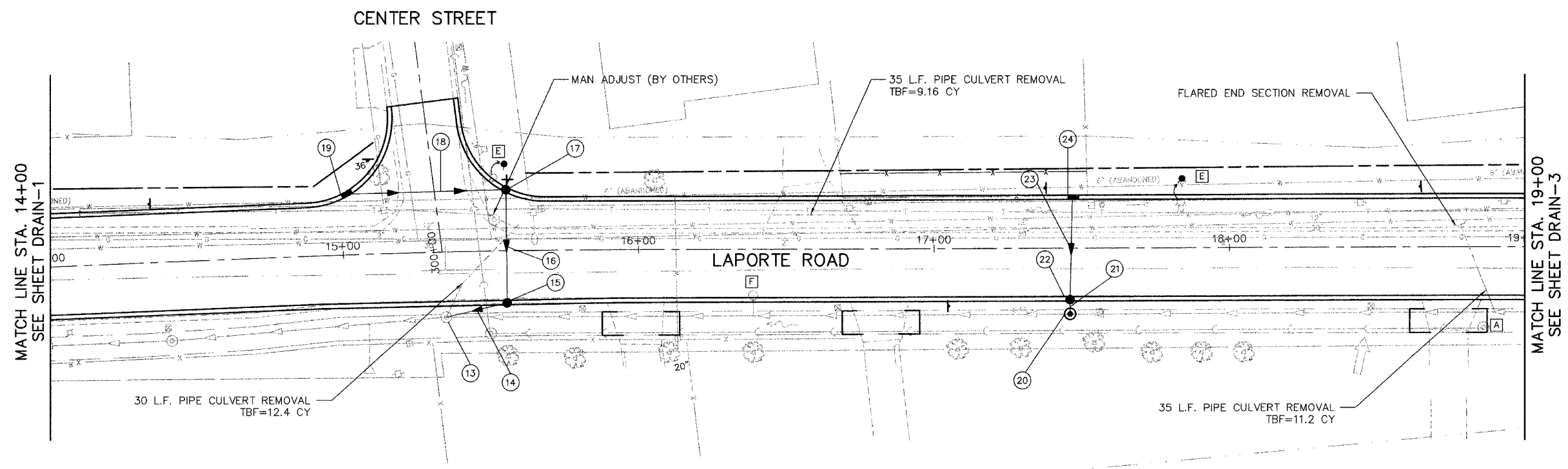

- 13 STA. 15+34, 22 FT RT. EXISTING MANHOLE  
T/F=715.75  
INV.=711.55 (E)(W)(EXISTING)  
INV. 711.75 (NE)
- 14 STORM SEWER, RG, CLASS A, TYPE 1  
20' -12" @ 0.5%  
TBF=6.5 CY
- 15 STA. 15+55, 17 FT RT. CATCH BASIN, T-A, 4' DIA., T-4 F&G  
T/F=715.56  
INV.=711.85 (SW)(N)
- 16 STORM SEWER, RG, CLASS A, TYPE 1  
40' -12" @ 0.5%  
TBF=11.8 CY
- 17 STA. 15+55, 20 FT LT. CATCH BASIN T-A, 4' DIA., T-4 F&G  
T/F=715.45  
INV.=712.05 (S)(W)
- 18 STORM SEWER, RG, CLASS A, TYPE 1  
54' -12" @ 0.5%  
TBF=12.7 CY
- 19 STA. 15+02, 20 FT LT. INLET T-A, T-4 F&G  
T/F=714.82  
INV.=712.32
- 20 STA. 17+46, 22 FT RT. MANHOLE, T-A, 4' DIA., T-1 F CL  
T/F=717.31  
INV.=713.44
- 21 STORM SEWER, RG, CLASS A, TYPE 1  
5' -12" @ 0.5%  
TBF=1.6 CY
- 22 STA. 17+45, 16.5 FT RT. CATCH BASIN, T-A, 4' DIA., T-4 F&G  
T/F=717.24  
INV.=713.47 (N)(S)
- 23 STORM SEWER, RG, CLASS A, TYPE 1  
35' -12" @ 0.5%  
TBF=10.8 CY
- 24 STA. 17+47, 16.5 FT LT. INLET T-A, T-4 F&G  
T/F=717.26  
INV.=713.64

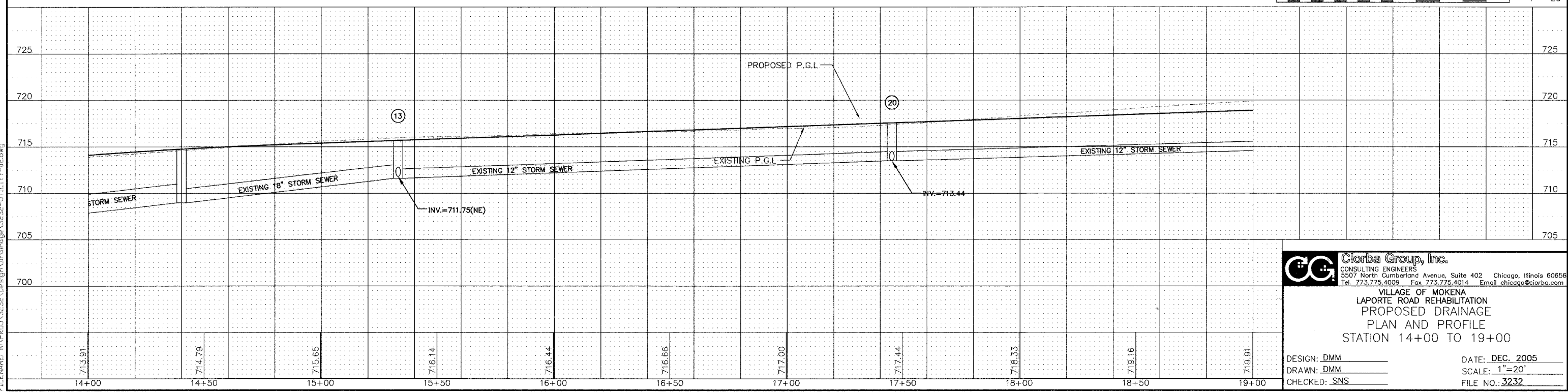
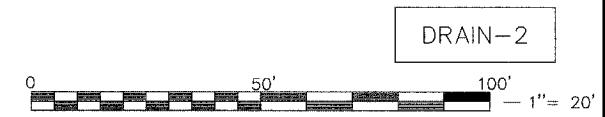

**CG** Ciorba Group, Inc.  
CONSULTING ENGINEERS  
5507 North Cumberland Avenue, Suite 402 Chicago, Illinois 60656  
Tel. 773.775.4008 Fax 773.775.4014 Email chicago@ciorba.com

VILLAGE OF MOKENA  
LAPORTE ROAD REHABILITATION  
PROPOSED DRAINAGE  
PLAN AND PROFILE  
STATION 14+00 TO 19+00

DESIGN: DMM  
DRAWN: DMM  
CHECKED: SNS

DATE: DEC. 2005  
SCALE: 1"=20'  
FILE NO.: 3232

PLU1 DATE: Dec 22, 2005 - 4:03pm  
FILENAME: N:\PROJ\3232\Design\Drainage\3232-UTILITY-02.dwg