

F.A.U. R.T.E.	SECTION	COUNTY	TOTAL SHEETS	SHEET NO.
3873 00-00243-00-FP		MCHENRY	84	22
STA.	314+00	TO STA.	324+50	
FED. ROAD DIST. NO. 1	ILLINOIS HIGHWAY PROJECT		83840	

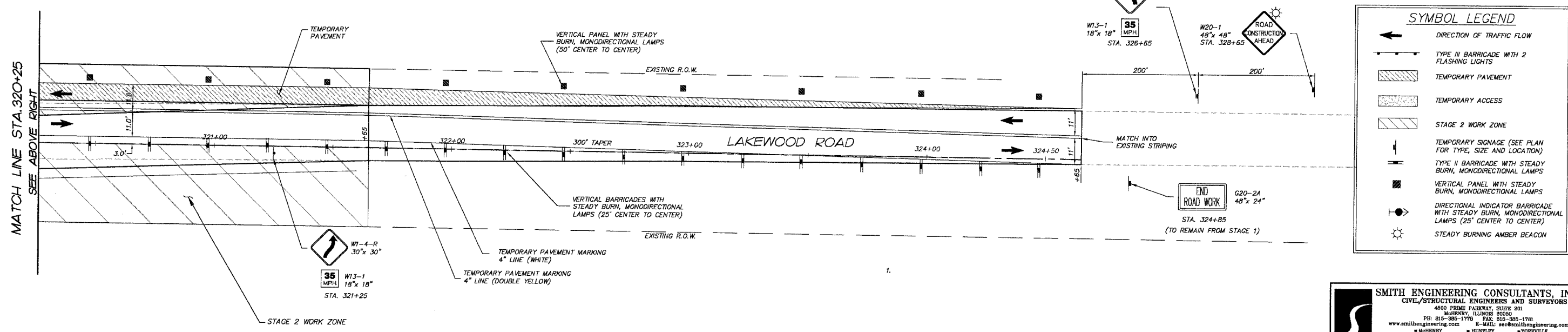
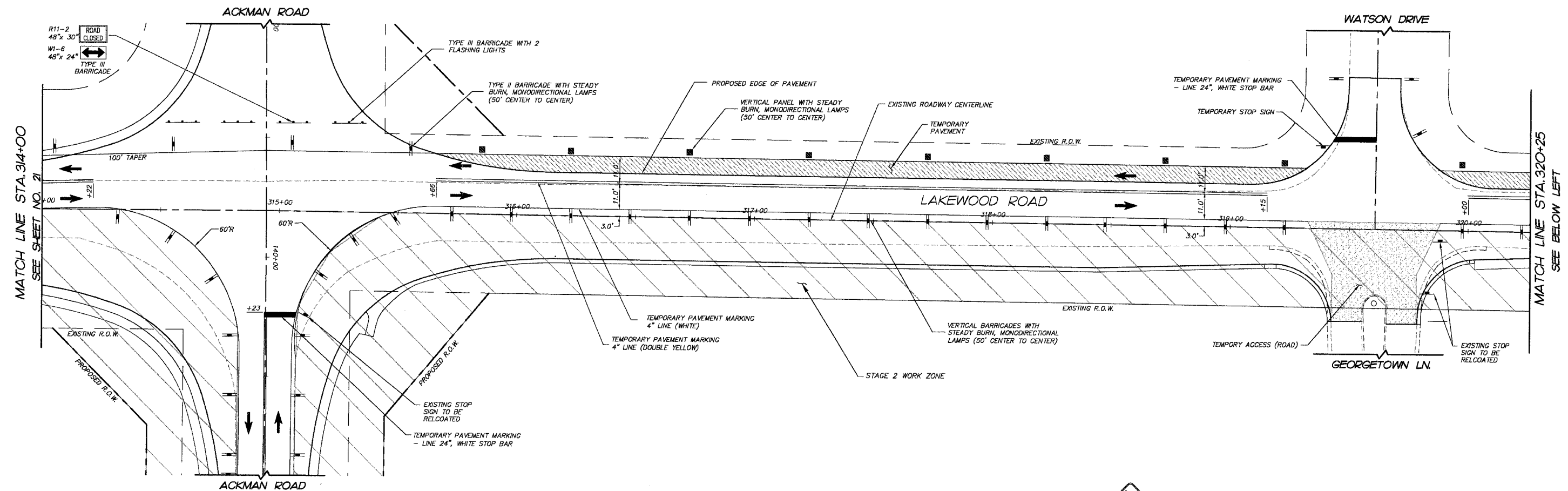

	DIRECTION OF TRAFFIC FLOW
	TYPE III BARRICADE WITH 2 FLASHING LIGHTS
	TEMPORARY PAVEMENT
	TEMPORARY ACCESS
	STAGE 2 WORK ZONE
	TEMPORARY SIGNAGE (SEE PLAN FOR TYPE, SIZE AND LOCATION)
	TYPE II BARRICADE WITH STEADY BURN, MONODIRECTIONAL LAMPS
	VERTICAL PANEL WITH STEADY BURN, MONODIRECTIONAL LAMPS
	DIRECTIONAL INDICATOR BARRICADE WITH STEADY BURN, MONODIRECTIONAL LAMPS (25' CENTER TO CENTER)
	STEADY BURNING AMBER BEACON

NO.	NAME	DATE
7.		
6.		
5.		
4.		
3.		
2.		
1.		

SMITH ENGINEERING CONSULTANTS, INC.
 CIVIL/STRUCTURAL ENGINEERS AND SURVEYORS
 4900 PRIME PARKWAY, SUITE 201
 MCHENRY, ILLINOIS 60050
 PH: 815-385-1770 FAX: 815-385-1781
 www.smithengineering.com E-MAIL: see@smithengineering.com

ILLINOIS PROFESSIONAL DESIGN FIRM # 184-000108

MCHENRY COUNTY DIVISION OF TRANSPORTATION
 ACKMAN ROAD EXTENSION

SUGGESTED CONSTRUCTION STAGING
 FOR LAKEWOOD ROAD
 STAGE 2

SCALE: 1"=20'
 DATE 10-05-2005

DRAWN BY DCJ
 CHECKED BY GFR

PLOT FILE: STANDARD 22
 COMP. FILE: 081010-318-1.dwg