

F.A.I.D. RTE.	SECTION	COUNTY	TOTAL SHEETS	SHEET NO.
89	04-00229-00-FF	OGLE	42	17
STA. 52+00		TO STA. 67+00		
FED. ROAD DIST. NO. ILLINOIS		FED. AID PROJECT		

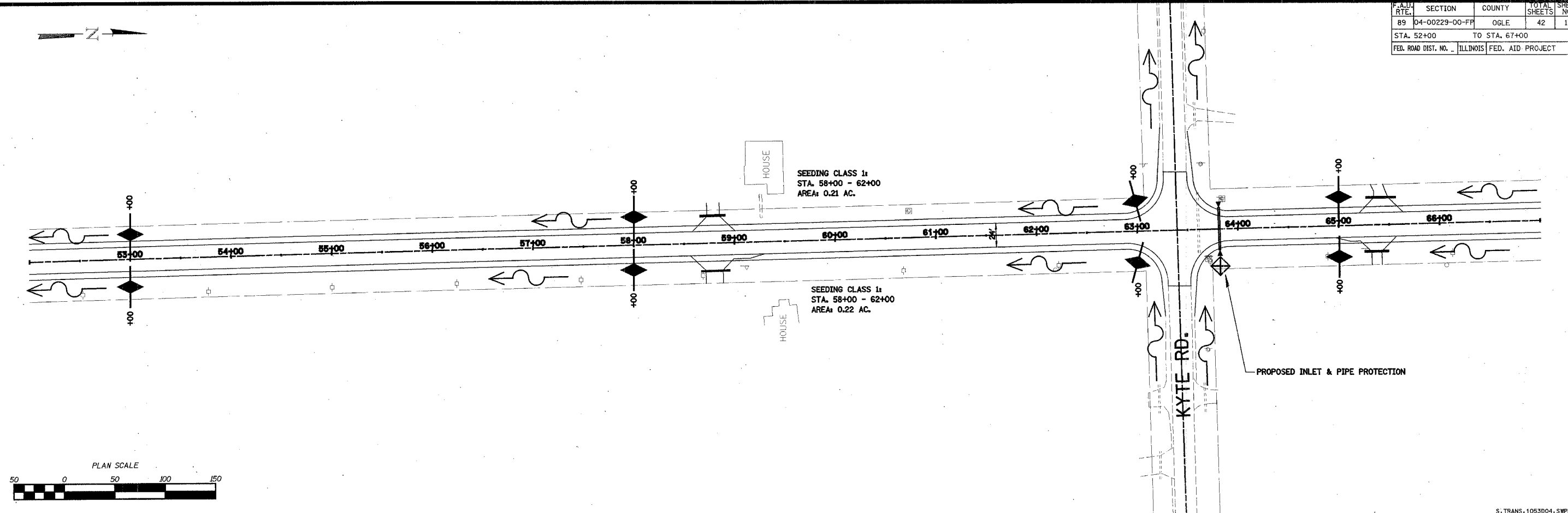

S:TRANS-1053D04.SWPP4

SEDIMENT COLLECTED DURING CONSTRUCTION OF THE VARIOUS TEMPORARY EROSION CONTROL SYSTEMS SHALL BE DISPOSED OF ON THE SITE ON A REGULAR BASIS AS DIRECTED BY THE ENGINEER. THE COST OF THIS MAINTENANCE SHALL BE INCLUDED IN THE UNIT BID PRICE FOR EARTH EXCAVATION FOR EROSION CONTROL.

THE TEMPORARY EROSION CONTROL SYSTEMS SHALL BE REMOVED AS DIRECTED BY THE ENGINEER AFTER USE IS NO LONGER NEEDED OR NO LONGER FUNCTIONING. THE COST OF THIS REMOVAL SHALL BE INCLUDED IN THE UNIT BID PRICE FOR VARIOUS TEMPORARY EROSION CONTROL PAY ITEMS.

DESCRIPTION OF STRUCTURAL PRACTICES AFTER FINAL GRADING :

1. TEMPORARY EROSION CONTROL SYSTEMS SHALL BE LEFT IN PLACE WITH PROPER MAINTENANCE UNTIL PERMANENT EROSION CONTROL IS IN PLACE AND WORKING PROPERLY AND ALL PROPOSED TURF AREAS SEEDED AND ESTABLISHED.
2. ONCE PERMANENT EROSION CONTROL SYSTEMS AS PROPOSED IN THE PLANS ARE FUNCTIONAL AND ESTABLISHED, TEMPORARY ITEMS SHALL BE REMOVED, CLEANED UP, AND DISTURBED TURF RESEDED.

MAINTENANCE AFTER CONSTRUCTION :

1. CONSTRUCTION IS COMPLETE AFTER ACCEPTANCE BY I.D.O.T. FINAL INSPECTION. MAINTENANCE UP TO THIS DATE WILL BE BY THE CONTRACTOR.

MISCELLANEOUS:

1. TEMPORARY DITCH CHECKS SHALL BE INSTALLED AT THE DIRECTION OF THE ENGINEER.
2. TEMPORARY EROSION CONTROL SEEDING SHALL BE APPLIED AT A RATE OF 114 LBS/ACRES (SEEDING CLASS 7).
3. STRAW BALES, HAY BALES, PERIMETER EROSION BARRIER AND SILT FENCES WILL BE PERMITTED FOR TEMPORARY OR PERMANENT DITCH CHECKS. DITCH CHECKS MAY BE COMPOSED OF AGGREGATE, SILT PANELS, ROLLED EXCELSIOR, URETHANE FOAM/GEOTEXTILE (SILT SEDGES), AND/OR ANY OTHER MATERIAL APPROVED BY THE EROSION AND SEDIMENT CONTROL COORDINATOR.
4. SEDIMENT COLLECTED DURING CONSTRUCTION BY THE VARIOUS TEMPORARY EROSION CONTROL SYSTEMS SHALL BE DISPOSED OF ON THE SITE ON A REGULAR BASIS, AS DIRECTED BY THE ENGINEER. THE COST OF THIS MAINTENANCE SHALL BE PAID FOR AT THE CONTRACT UNIT PRICE PER CUBIC YARD FOR EARTH EXCAVATION (SPECIAL).
5. ALL EROSION CONTROL PRODUCTS FURNISHED SHALL BE SPECIFICALLY RECOMMENDED BY THE MANUFACTURER FOR THE USE SPECIFIED IN THE EROSION CONTROL PLAN. PRIOR TO THE APPROVAL AND USE OF THE PRODUCT, THE CONTRACTOR SHALL SUBMIT TO THE ENGINEER A NOTARIZED CERTIFICATION BY THE PRODUCER STATING THE INTENDED USE OF THE PRODUCT AND THAT THE PHYSICAL PROPERTIES REQUIRED FOR THIS APPLICATION ARE MET OR EXCEEDED. THE CONTRACTOR SHALL PROVIDE MANUFACTURER INSTALLATION PROCEDURES TO FACILITATE THE ENGINEER IN CONSTRUCTION INSPECTION.

LEGEND

- ◆ TEMPORARY DITCH CHECK
- ▬ PERIMETER EROSION BARRIER - SILT FILTER FENCE OR OTHER AS APPROVED BY THE ENGINEER
- ▨ EROSION CONTROL BLANKET
- ⊕ INLET & PIPE PROTECTION

STORM WATER
POLLUTION
PREVENTION PLAN
SHEET 4
WHA #1053D04