

F.A.S. RTE.	COUNTY	TOTAL SHEETS	SHEET NO.
168	KENDALL	2	1

CONTRACT NO. 87318

STATE OF ILLINOIS

DEPARTMENT OF TRANSPORTATION

DIVISION OF HIGHWAYS

PLANS FOR PROPOSED
FEDERAL AID HIGHWAY

F.A.S. 168 (C.H. 12 - LITTLE ROCK ROAD)
SECTION 04-00075-00-RS
PROJECT NO. RS-168(106)
JOB NO. C-93-043-06
KENDALL COUNTY

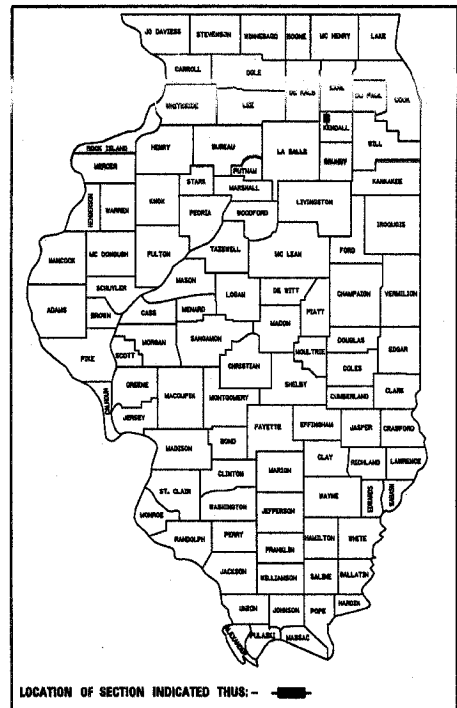

LOCATION OF SECTION INDICATED THUS: -



SCALE
1" = 1760'

HIGHWAY STANDARDS

- 701011-01 OFF-RD MOVING OPERATIONS 2L, 2W, DAY ONLY
- 701301-02 LANE CLOSURE, 2L, 2W SHORT TERM OPERATIONS
- 701306-01 LANE CLOSURE, 2L, 2W SLOW MOVING OPERATIONS, DAY ONLY, FOR SPEEDS ≥ 45 MPH
- 701311-02 LANE CLOSURE, 2L, 2W MOVING OPERATIONS - DAY ONLY
- 702001-06 TRAFFIC CONTROL DEVICES

INDEX OF SHEETS

- 1. COVER SHEET
- 2. SUMMARY OF QUANTITIES
- TYPICAL SECTION
- SIDE ROAD DETAIL
- PAVEMENT DESIGN

PROJECT ENDS
STA 226+86

STATION EQUATION
STA 44+82.8 BK=
STA 41+67.6 AHD.

PROJECTS BEGINS
STA 38+05

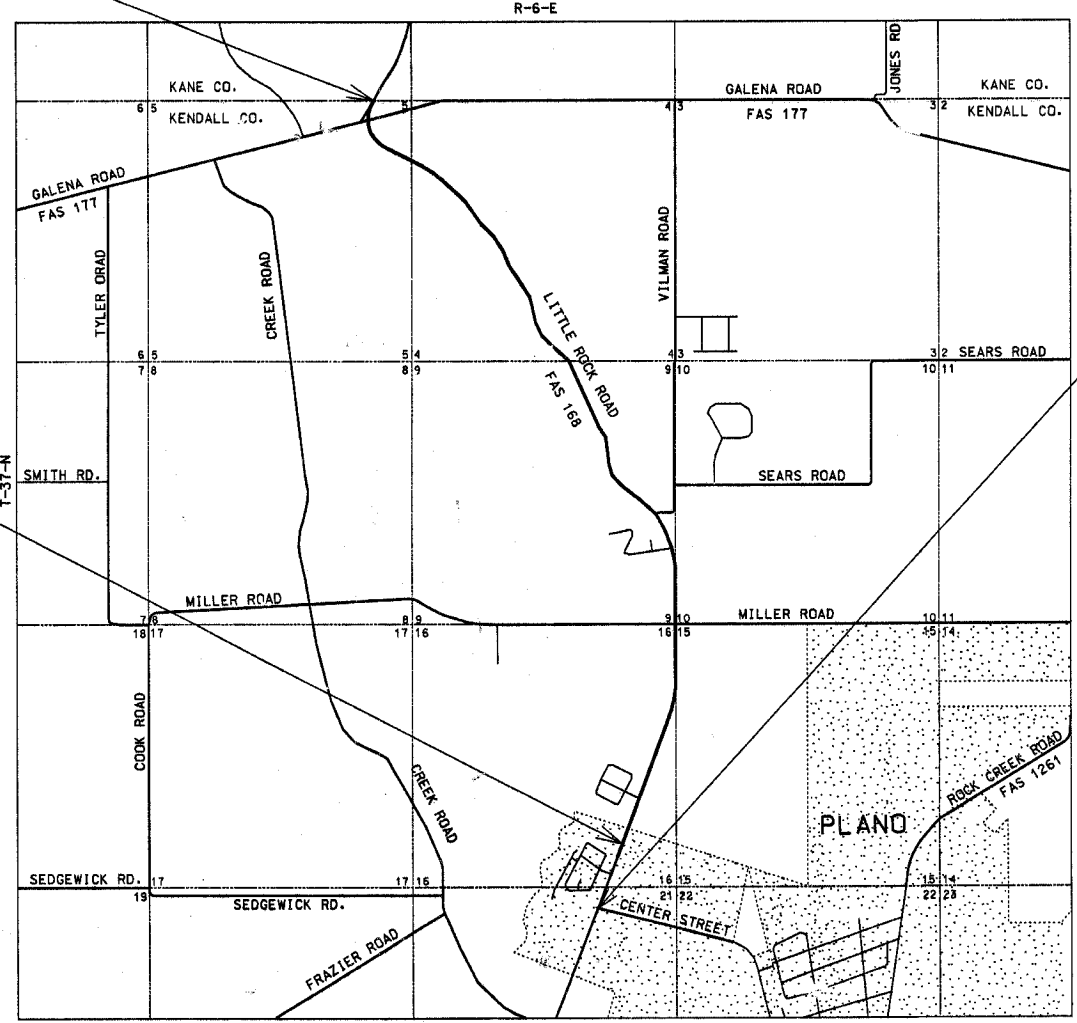

GROSS & NET LENGTH = 19,170 FEET = 3.63 MILES

FUNCTIONAL CLASSIFICATION: MAJOR COLLECTOR

CURRENT ADT (2006): 4315

PLANS DEVELOPED IN ACCORDANCE WITH
LOCAL AGENCY PAVEMENT PRESERVATION POLICY

J.U.L.E.
JOINT UTILITY LOCATION INFORMATION FOR EXCAVATION
1-000-02-0123

STATE OF ILLINOIS
DEPARTMENT OF TRANSPORTATION
DIVISION OF HIGHWAYS

SUBMITTED FEBRUARY 10 20 06

Francis C. Klasing
KENDALL COUNTY ENGINEER

February 17 20 06
Benjamin R. Long
DISTRICT ENGINEER of LOCAL ROADS and STREETS

FEBRUARY 17 20 06
Gregory M. ...
DEPUTY DIRECTOR of HIGHWAYS, REGION 2 ENGINEER

Date: 2-10-06

By: *Francis C. Klasing*

License Exp: 11-30-07