

F.A.S. RTE.	COUNTY	TOTAL SHEETS	SHEET NO.
168	KENDALL	2	1

CONTRACT NO. 87318

STATE OF ILLINOIS  
DEPARTMENT OF TRANSPORTATION  
DIVISION OF HIGHWAYS

**PLANS FOR PROPOSED  
FEDERAL AID HIGHWAY**

F.A.S. 168 (C.H. 12 - LITTLE ROCK ROAD)  
SECTION 04-00075-00-RS  
PROJECT NO. RS-168(106)  
JOB NO. C-93-043-06  
KENDALL COUNTY

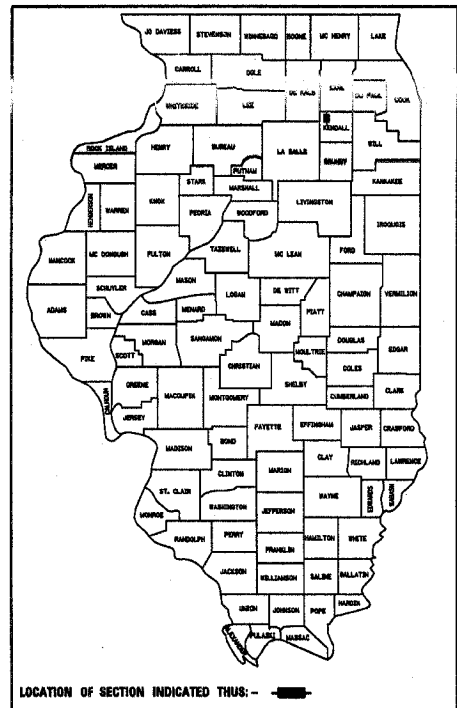

N  
SCALE  
1" = 1760'

**HIGHWAY STANDARDS**

- 701011-01 OFF-RD MOVING OPERATIONS 2L, 2W, DAY ONLY
- 701301-02 LANE CLOSURE, 2L, 2W SHORT TERM OPERATIONS
- 701306-01 LANE CLOSURE, 2L, 2W SLOW MOVING OPERATIONS, DAY ONLY, FOR SPEEDS ≥ 45 MPH
- 701311-02 LANE CLOSURE, 2L, 2W MOVING OPERATIONS - DAY ONLY
- 702001-06 TRAFFIC CONTROL DEVICES

**INDEX OF SHEETS**

- 1. COVER SHEET
- 2. SUMMARY OF QUANTITIES
- TYPICAL SECTION
- SIDE ROAD DETAIL
- PAVEMENT DESIGN

PROJECT ENDS  
STA 226+86

STATION EQUATION  
STA 44+82.8 BK=  
STA 41+67.6 AHD.

PROJECTS BEGINS  
STA 38+05

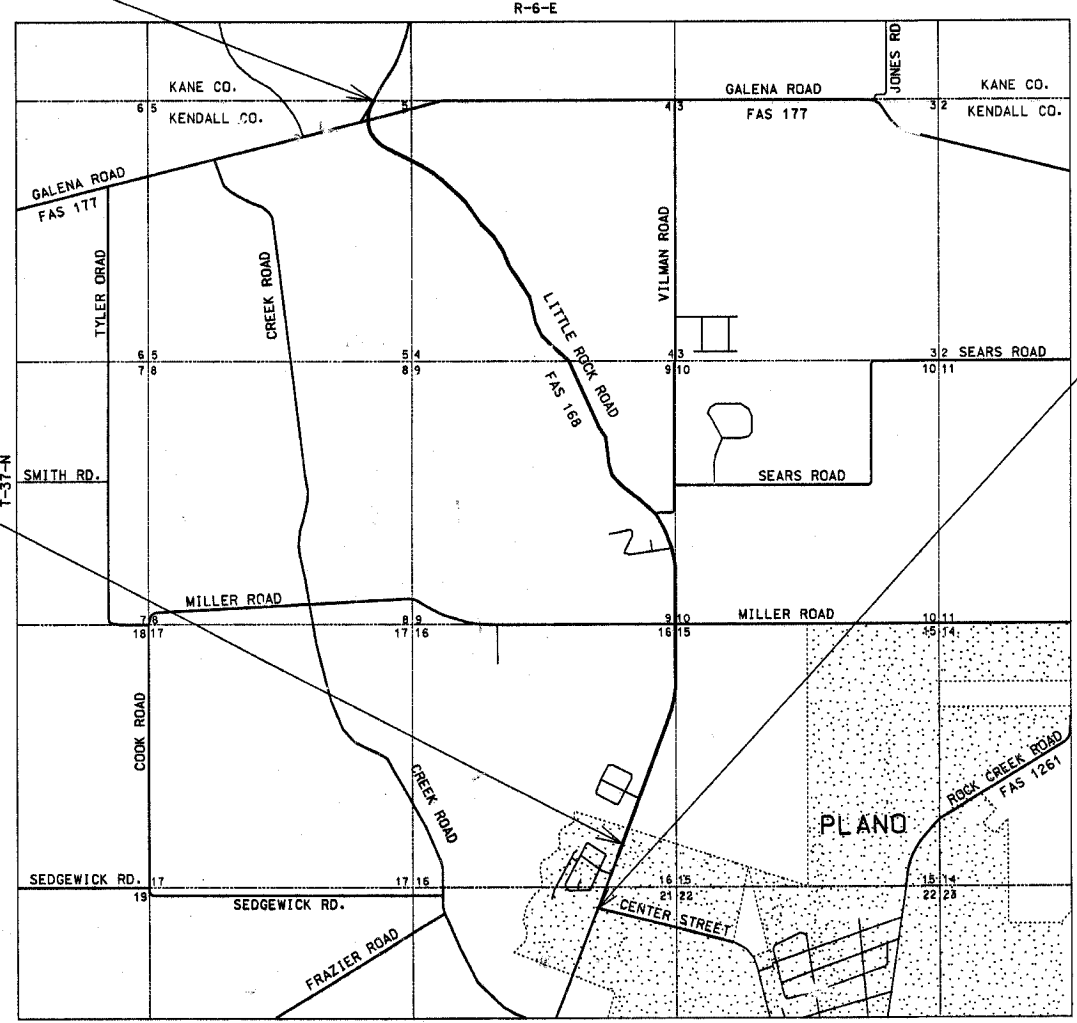

GROSS & NET LENGTH = 19,170 FEET = 3.63 MILES

FUNCTIONAL CLASSIFICATION: MAJOR COLLECTOR

CURRENT ADT (2006): 4315

PLANS DEVELOPED IN ACCORDANCE WITH  
LOCAL AGENCY PAVEMENT PRESERVATION POLICY

J.U.L.I.E.  
JOINT UTILITY LOCATION INFORMATION FOR EXCAVATION  
1-000-02-0123

STATE OF ILLINOIS  
DEPARTMENT OF TRANSPORTATION  
DIVISION OF HIGHWAYS

SUBMITTED FEBRUARY 10 20 06  
*Francis C. Klasing*  
KENDALL COUNTY ENGINEER

February 17 20 06  
*Benjamin R. Long*  
DISTRICT ENGINEER of LOCAL ROADS and STREETS

FEBRUARY 17 20 06  
*Gregory M. ...*  
DEPUTY DIRECTOR of HIGHWAYS, REGION 2 ENGINEER

Date: 2-10-06

By: *Francis C. Klasing*

License Exp: 11-30-07

### SUMMARY OF QUANTITIES

FUND CODE 1000

CODE NO.	ITEM	UNIT	QUANTITY
* 20201100	GRADING EXISTING SHOULDER	UNIT	383.40
40600100	BITUMINOUS MATERIALS PRIME COAT	GALLON	4686
40600300	AGGREGATE (PRIME COAT)	TON	12.70
40600990	TEMPORARY RAMP	SQ YD	73.33
40800040	INCIDENTAL BITUMINOUS SURFACE	TON	188
44000006	BITUMINOUS SURFACE REMOVAL 1 1/2"	SQ YD	46,860
48101200	AGGREGATE SHOULDERS, TYPE B	TON	1460
67100100	MOBILIZATION	L SUM	1
Δ 70100460	TRAFFIC CONTROL PROTECTION, 701306	L SUM	1
70300100	SHORT-TERM PAVEMENT MARKING	FOOT	3834
70301000	WORK ZONE PAVEMENT MARKING REMOVAL	SQ FT	1600
Δ 78005110	EPOXY PAVEMENT MARKING, LINE 4"	FOOT	65,500
* X4066414	BITUMINOUS CONCRETE SURFACE COURSE, SUPERPAVE, MIX "C", N 50	TON	4195
* X4066765	LEVEL BINDER, MACHINE METHOD, SUPERPAVE, N 50	TON	5878

\* SEE SPECIAL PROVISIONS  
 Δ SPECIALTY ITEMS

### SIDE ROAD / ENTRANCE SCHEDULE

DESCRIPTION	NUMBER	TONS / EACH	BIT CONC BIND CSE SUP IL 19 N 50	BIT CONC SURF CSE SUP "C" N50	INCIDENTAL BIT SURFACING
MAILBOX TURNOUTS	26	0.60 (binder) 0.42 (surface)	16	11	
FIELD ENTRANCES	22	0.55 (binder) 0.40 (surface)	12	9	
PRIVATE ENTRANCES	32	4.0 (surface)			128
SIDE ROADS	10	6.0 (surface)			60
		<b>TOTALS</b>	<b>28*</b>	<b>20*</b>	<b>188</b>

\* PAID FOR AS PART OF MAINLINE QUANTITIES

### STRUCTURAL DESIGN INFORMATION

#### LITTLE ROCK ROAD SECTION 04-00075-00-RS

ROAD CLASSIFICATION: COLLECTOR, CLASS II

STRUCTURAL DESIGN YEAR: 2006 (8-YR DESIGN)

2006 ADT: 4315 PV=4186 SU=86 MU=43

TRAFFIC FACTOR=0.087 IBR=3

STRUCTURAL NUMBER = 2.85

#### PAVEMENT STRUCTURE MATERIALS

Aggregate Base Course (Existing)	(9.00")(0.08) =	0.7200
Bituminous Plant Mix (Existing)	(3.00")(0.17) =	0.5100
Bituminous Surface Treatment (Existing)	(0.75")(0.15) =	0.1125
Bituminous Class 1 (Existing After Grinding)	(1.25)(0.30) =	0.3750
Bituminous Binder /Surface (Proposed)	(3.00")(0.40) =	1.2000
		2.9175

### SUPERELEVATION CORRECTIONS

Curve Station	Existing Super	Proposed Super	Corrective Action
82+30.75	+/- 2%	3.0%	Correct w/mainline paving
117+44.50	3.5% to 5.5% & var.	7.0%	Rotomill the low side of the super Correct with mainline paving
130+92.7	4.5% to 5.5% & var.	8.0%	Rotomill the low side of the super Correct with mainline paving
140+40.8	+/- 4%	8.0%	Rotomill the low side of the super Correct with mainline paving
159+73.4	2.5% to 3.5% & var.	4.0%	Correct w/mainline paving
182+65.7	0.5% to 2.0% & var.	4.5%	Rotomill the low side of the super Correct with mainline paving
208+29.7	3.5% to 4.0% & var.	8.0%	Rotomill the low side of the super Correct with mainline paving
223+13.4	4.0% to 8.0% & var.	6.0%	Correct w/mainline paving

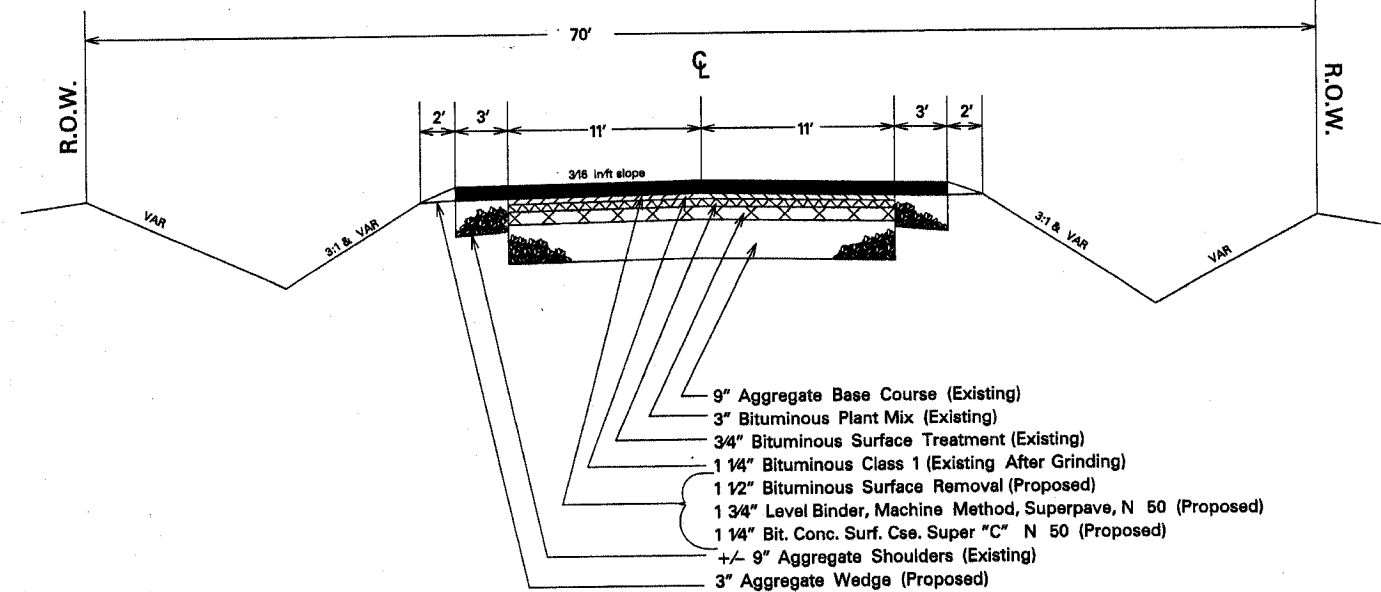

**TYPICAL SECTION  
LITTLE ROCK ROAD**

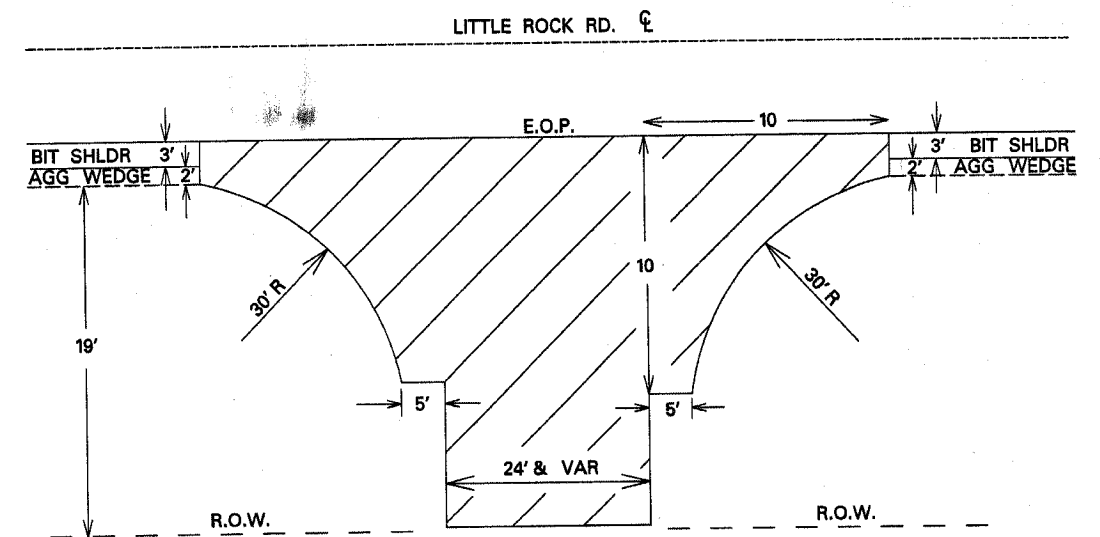

**SIDE ROAD DETAIL**