

F.A. RTE.	SECTION	COUNTY	CONTRACT NO.
FAU 6579	02-00065-00-PV	PEORIA	89358
FED. RD. DIST. NO.	ILLINOIS	PROJECT NO. M 503 102	

△ BITUMINOUS CONCRETE SURFACE COURSE MIX D, N 50, 2"
 LEVELING BINDER, 1"
 BASE COURSE WIDENING, 6"
 AGGREGATE BASE COURSE TYPE B, 4"
 △ BITUMINOUS CONCRETE SURFACE COURSE MIX D, N 50, 2"
 LEVELING BINDER, 1"
 △ BITUMINOUS CONCRETE SURFACE COURSE MIX D, N 50, 2"
 BITUMINOUS CONCRETE BINDER COURSE MIX D, N 50, 3"
 AGGREGATE BASE COURSE TYPE A, 8"

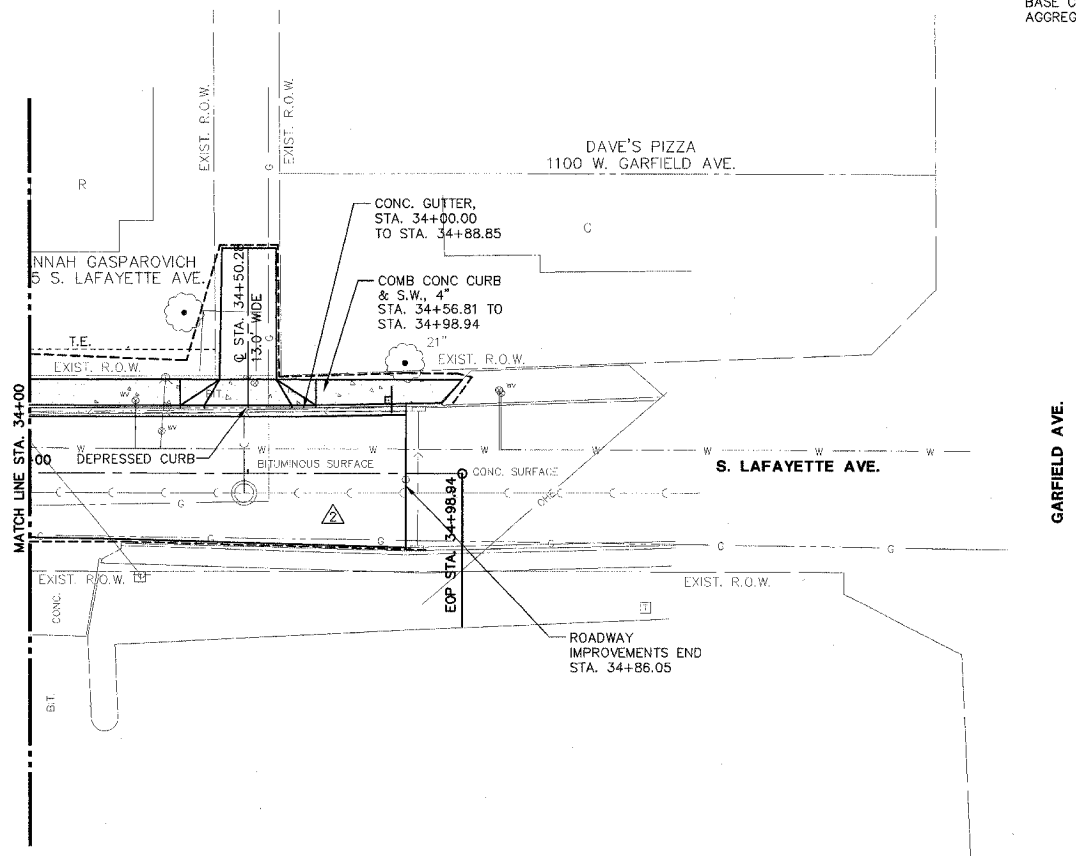

SCALES:
 1" = 20' HOR
 1" = 5' VER

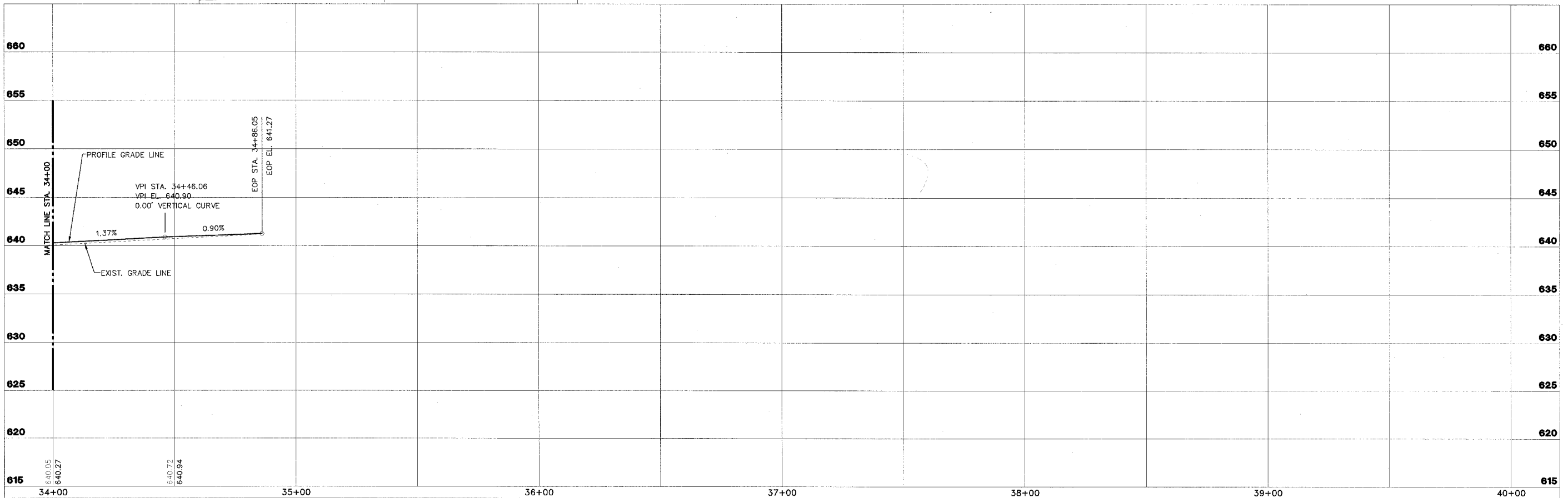

L:\BART0001\DWG\PP05.DWG 1:1:0

SHEET
28
 OF
83

 STS CONSULTANTS 111 NE Jefferson Ave. Peoria, Illinois 61602 Ph: (309) 76-8484 Fax: (309) 76-3445 IL Design Firm Reg. No. 184-001518	LAFAYETTE AVE. BARTONVILLE IL.		PLAN AND PROFILE STA. 34+00 TO STA. 34+86.02		SURVEY DESIGN DRAWN	CHECKED APPROVED CSA	ISSUE DATE 01/06/06 PRELIM. DATE 11/21/05 PROJECT NO. BART0001