

**LEGEND**

- △ STRUCTURE NUMBER
- PIPE NUMBER

| STRUCTURE SCHEDULE |               |        |       |   |            |         |        |        |        |        |         |
|--------------------|---------------|--------|-------|---|------------|---------|--------|--------|--------|--------|---------|
| STR. NO.           | STATION       | OFFSET | RT/LT | TYPE  | F&G        | RIM EL. | INV. N | INV. S | INV. E | INV. W | REMARKS |
| 14                 | STA. 22+68.16 | 13.00  | LT    | INLET-MANHOLE, TYPE G-1, 4'-DIAMETER                    | DIAGONAL   | 639.63  | 636.00 | 635.90 |        |        |         |
| 15                 | STA. 23+03.13 | 14.31  | LT    | MANHOLES, TYPE A, 4'-DIAMETER, TYPE 1 FRAME, CLOSED LID | FG TY 1 CL | 639.87  | 636.35 | 636.35 | 636.51 | 636.68 |         |
| 20                 | STA. 23+02.59 | 13.00  | RT    | INLETS, TYPE G-1  | DIAGONAL   | 639.81  |        |        |        | 636.63 |         |
| 21                 | STA. 23+03.13 | 45.53  | LT    | MANHOLES, TYPE A, 4'-DIAMETER, TYPE 1 FRAME, OPEN LID   | FG TY 1 OL | 639.80  |        | 637.00 | 637.00 |        |         |
| 22                 | STA. 23+38.82 | 45.60  | LT    | INLETS, TYPE A  | TY 8       | 640.80  |        | 638.01 | 638.01 |        |         |
| 17                 | STA. 24+76.53 | 13.00  | LT    | INLETS, TYPE G-1  | DIAGONAL   | 641.46  | 638.47 | 638.47 | 638.47 |        |         |
| 18                 | STA. 24+76.53 | 13.00  | RT    | INLETS, TYPE G-1  | DIAGONAL   | 641.46  |        |        |        | 638.61 |         |

|                    |                |                       |              |
|--------------------|----------------|-----------------------|--------------|
| F.A. RTE.          | SECTION        | COUNTY                | CONTRACT NO. |
| FAU 6579           | 02-00065-00-PV | PEORIA                | 89358        |
| FED. RD. DIST. NO. | ILLINOIS       | PROJECT NO. M 503 102 |              |

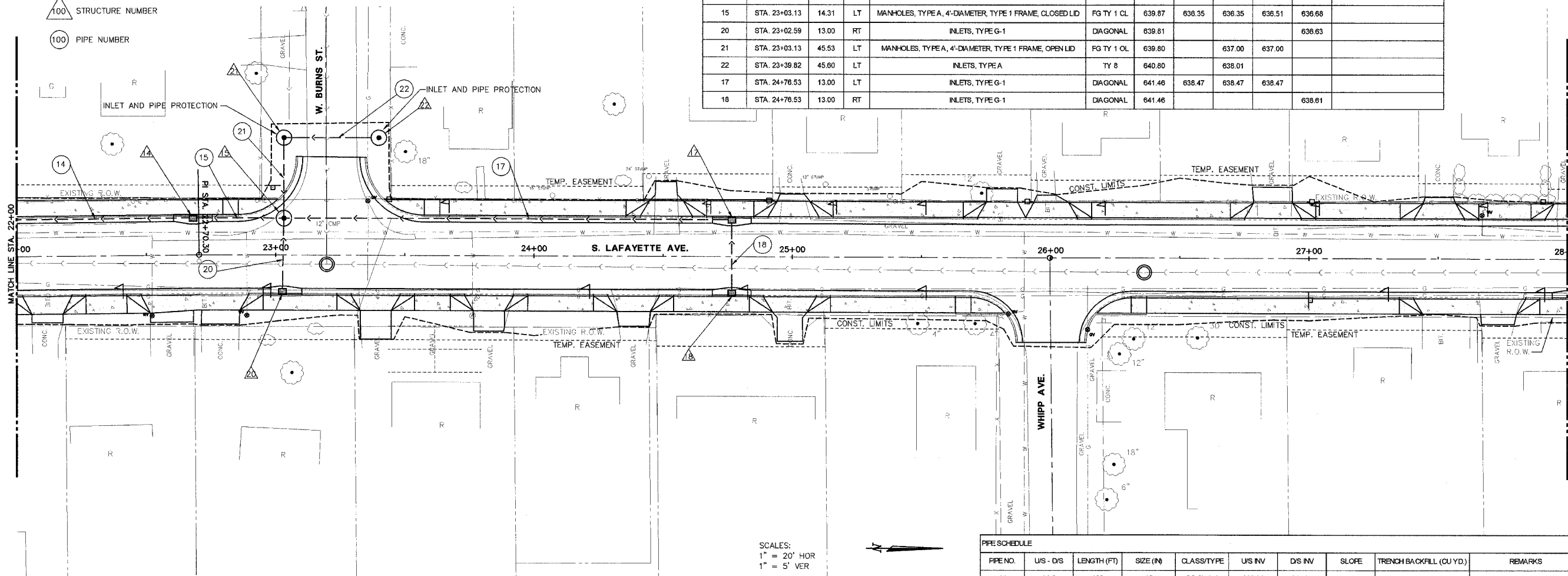

SCALES:  
1" = 20' HOR  
1" = 5' VER

| PIPE SCHEDULE |           |             |           |            |         |         |       |                         |         |  |
|---------------|-----------|-------------|-----------|------------|---------|---------|-------|-------------------------|---------|--|
| PIPE NO.      | UIS - DIS | LENGTH (FT) | SIZE (IN) | CLASS/TYPE | U/S INV | D/S INV | SLOPE | TRENCH BACKFILL (CU YD) | REMARKS |  |
| 14            | 14-6      | 128         | 12        | SS CL A 1  | 635.90  | 634.50  | 1.10% | 24.8                    |         |  |
| 15            | 15-14     | 32          | 12        | SS CL A 1  | 636.35  | 636.00  | 1.12% | 6.7                     |         |  |
| 20            | 20-15     | 25          | 12        | SS CL A 1  | 636.63  | 636.51  | 0.50% | 4.0                     |         |  |
| 21            | 21-15     | 28          | 12        | SS CL A 1  | 637.00  | 636.68  | 1.18% | 3.7                     |         |  |
| 22            | 22-21     | 34          | 12        | SS CL A 1  | 638.01  | 637.00  | 3.00% | 4.5                     |         |  |
| 17            | 17-15     | 170         | 12        | SS CL A 1  | 638.47  | 636.35  | 1.25% | 28.9                    |         |  |
| 18            | 18-17     | 27          | 12        | SS CL A 1  | 638.61  | 638.47  | 0.50% | 3.6                     |         |  |

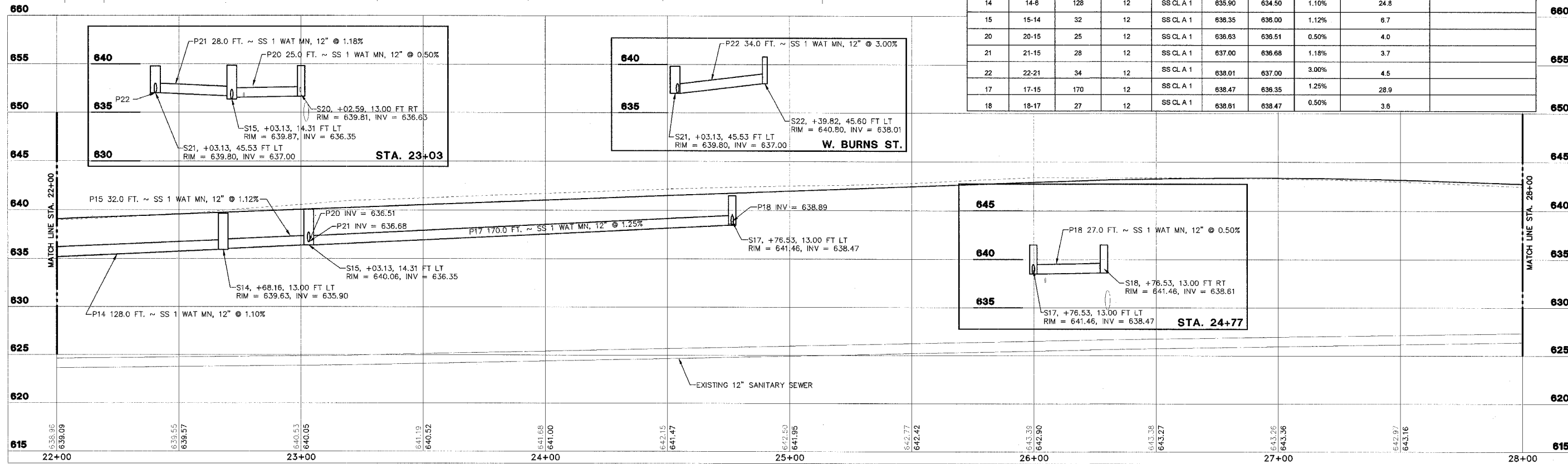

**STS CONSULTANTS**  
111 E. Jefferson Ave.  
Peoria, Illinois 61602  
Ph: (309) 767-8464  
Fax: (309) 767-8445  
IL Design Firm Reg. No. 184-001518

**LAFAYETTE AVE.  
BARTONVILLE IL.**

**DRAINAGE  
PLAN AND PROFILE  
STA. 22+00 TO STA. 28+00**

|        |          |              |
|--------|----------|--------------|
| SURVEY | CHECKED  | ISSUE DATE   |
| DESIGN | APPROVED | PRELIM. DATE |
| DRAWN  | CSA      | PROJECT NO.  |

SHEET  
**33**  
OF  
**83**

L:\BARTONVILLE\DWG\DRN.DWG 1-11