

24 22 20 18 16 14 12 10 8 6 4 2 C 2 4 6 8 10 12 14 16 18 20 22 24

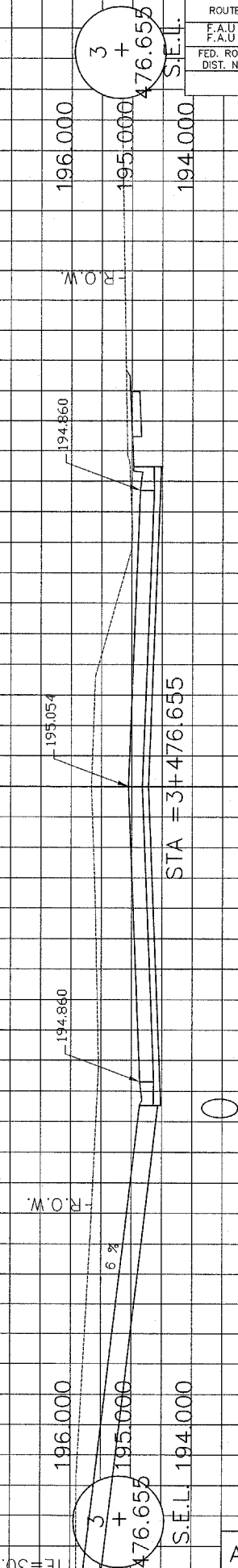
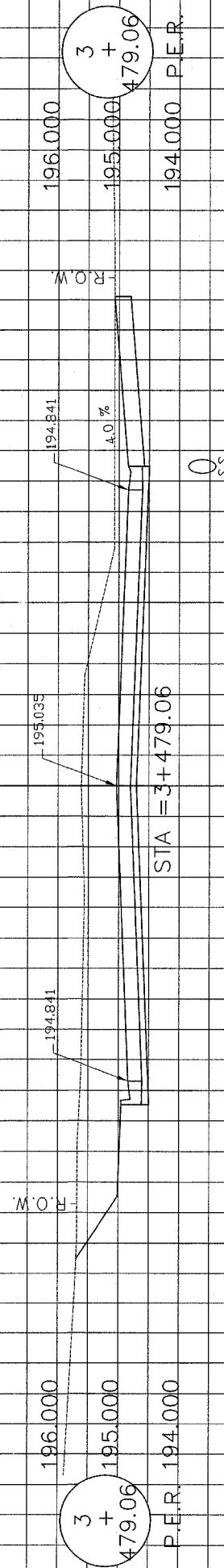
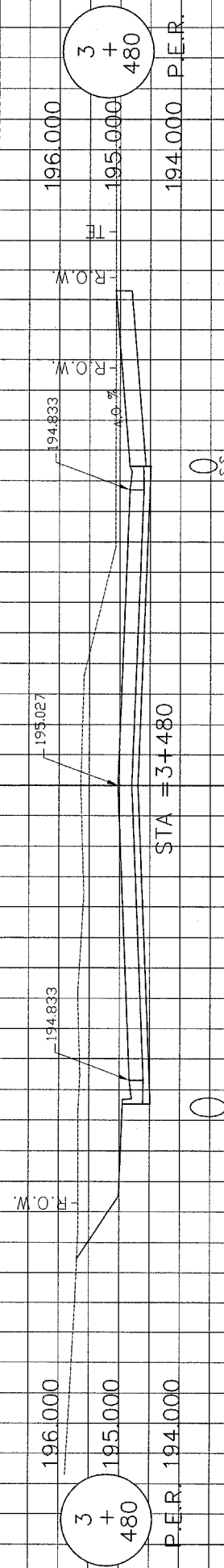
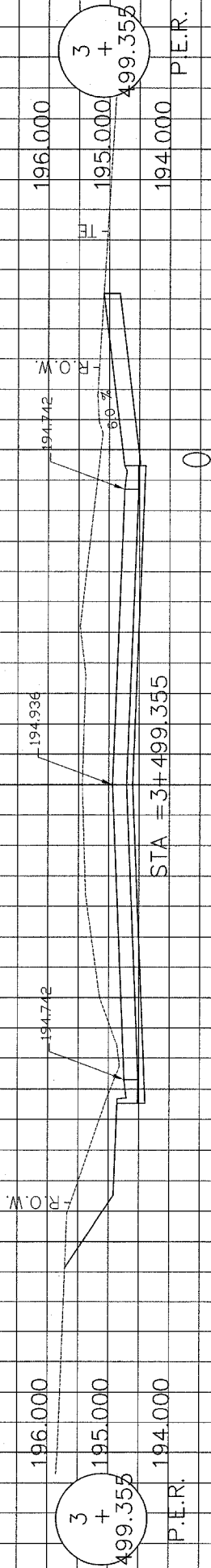
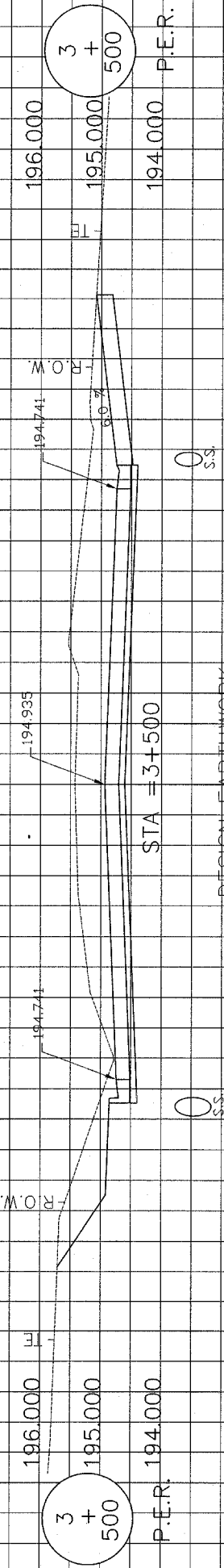

TE=30.48 M

AIRPORT ROAD

ROUTE NO. F.A.U 6578 F.A.U 6678	SECTION NO. 03-00019-1	TOTAL SHEET 98	SHEET NO. 51
FED. ROAD DIST. NO.	COUNTY PEORIA ILLINOIS	PROJECT M5093 (104)	
CONTRACT NO. 893691			

24 22 20 18 16 14 12 10 8 6 4 2 C 2 4 6 8 10 12 14 16 18 20 22 24