

ROUTE NO.	SECTION NO.	TOTAL SHEETS
F.A.U. 8578 F.A.U. 8579	03-00019-1 1-PP	98
FED. ROAD DIST. NO.	COUNTY	PROJECT
	PEDRIA	M-5093
	ILLINOIS	
CONTRACT NO. 89368		

**CONSTRUCTION STAGING (SUGGESTED)**

THE CONTRACTOR WILL PERFORM ALL PHASE WORK BY CLOSING ONE LANE OF TRAFFIC WHEN NECESSARY IN ACCORDANCE WITH ILLINOIS DEPARTMENT OF TRANSPORTATION STANDARDS. DURING NON-WORKING HOURS BOTH LANES OF TRAFFIC WILL REMAIN OPEN. ACCESS WILL BE MAINTAINED TO ALL BUSINESSES AND SCHOOLS EXCEPT AS DIRECTED BY THE ENGINEER. DRAINAGE AND UTILITIES WILL BE MAINTAINED AT ALL TIMES EXCEPT TO MAKE NEW CONNECTIONS

PHASE 6A (HATCHED AREA)  
INSTALL TEMPORARY BITUMINOUS RAMPS (SEE TOTAL QUANTITIES ON PHASE 5A)

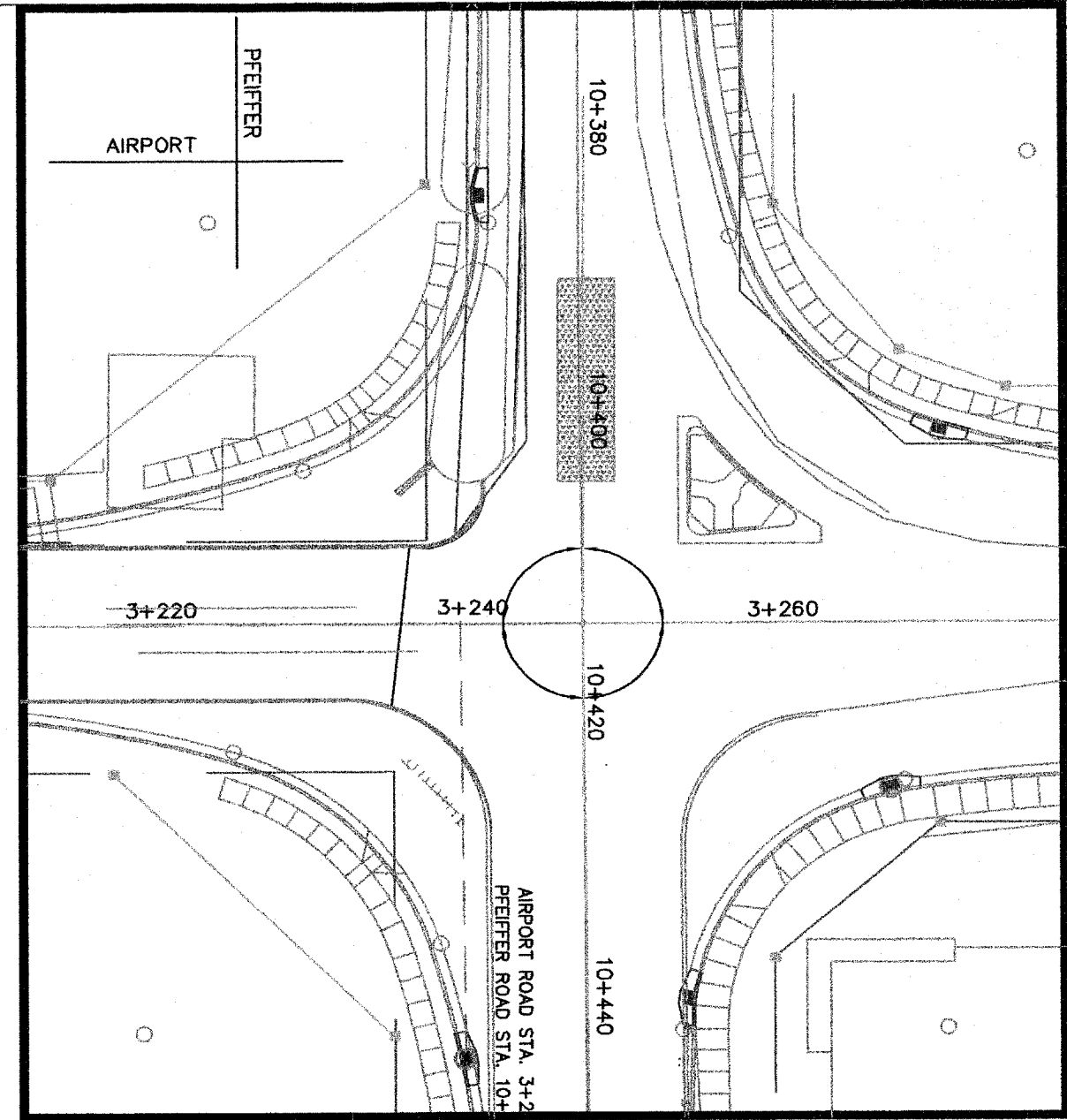
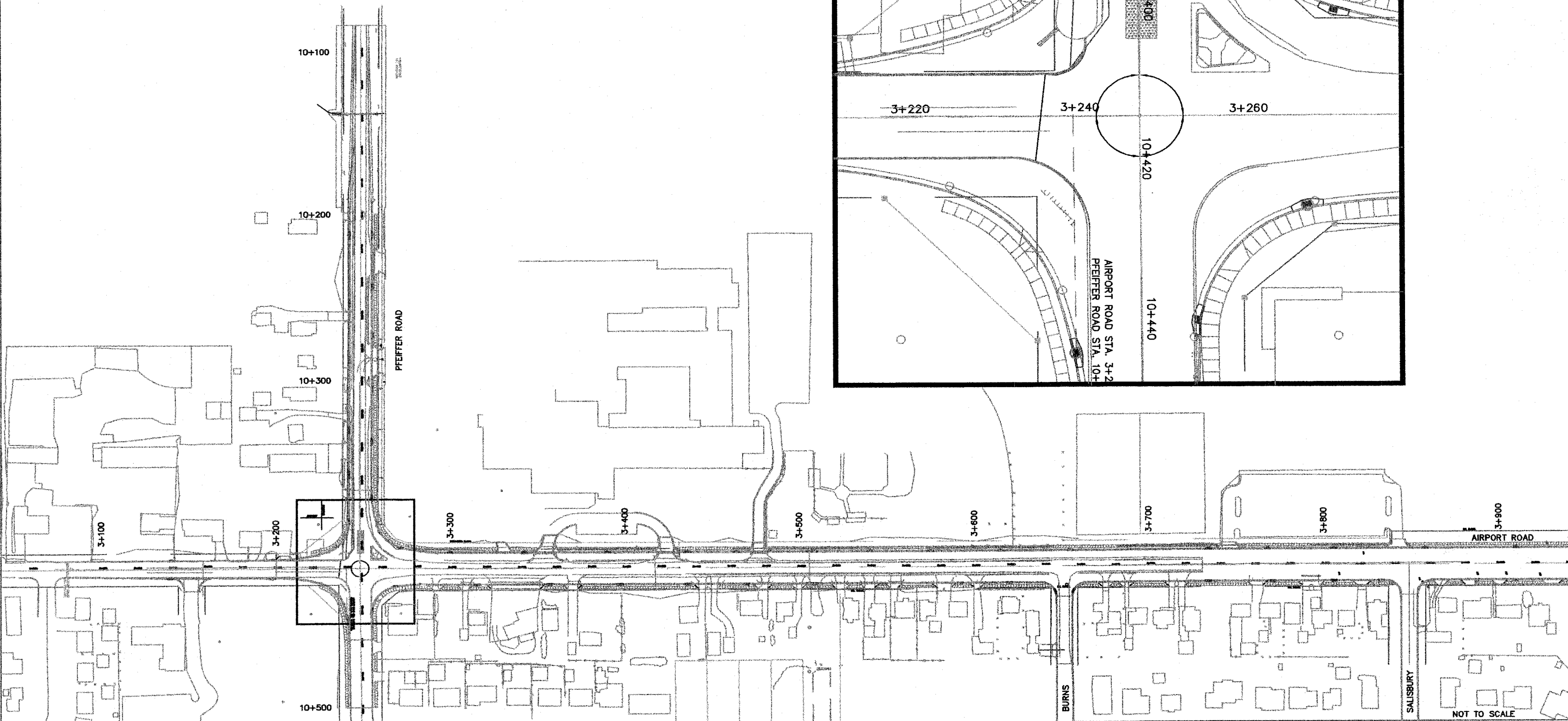

NOT TO SCALE