

ROUTE NO.	SECTION NO.	TOTAL SHEET
F.A.U. 8578 F.A.U. 8579	03-00019-1 1-FP	98
FED. ROAD DIST. NO.	COUNTY	PROJ. NO.
	PEORIA	M-5093
	ILLINOIS	
CONTRACT NO. 89389		

CONSTRUCTION STAGING (SUGGESTED)

THE CONTRACTOR WILL PERFORM ALL PHASE WORK BY CLOSING ONE LANE OF TRAFFIC WHEN NECESSARY IN ACCORDANCE WITH ILLINOIS DEPARTMENT OF TRANSPORTATION STANDARDS. DURING NON-WORKING HOURS BOTH LANES OF TRAFFIC WILL REMAIN OPEN. ACCESS WILL BE MAINTAINED TO ALL BUSINESSES AND SCHOOLS EXCEPT AS DIRECTED BY THE ENGINEER. DRAINAGE AND UTILITIES WILL BE MAINTAINED AT ALL TIMES EXCEPT TO MAKE NEW CONNECTIONS

PHASE 11 (HATCHED AREA)
 REMOVE TEMPORARY ISLAND PATCH AND CONSTRUCT ISLAND
 INSTALL TEMPORARY TRAFFIC SIGNALS AT WEST END OF PFEIFFER
 ONE LANE OF WEST PFEIFFER ROAD MAY BE CLOSED DURING NON-WORKING HOURS AS LONG AS THE TEMPORARY TRAFFIC SIGNALS ARE MAINTAINED.
 COST OF TEMPORARY TRAFFIC SIGNALS INCLUDES ALL MATERIALS, ELECTRICAL SERVICE HOOK UP, MAINTENANCE AND REMOVAL

TEMPORARY PAVEMENT MARKING QUANTITY THIS PHASE - 116 METER
 COST TO REMOVE ANY EXISTING OR TEMPORARY PAVEMENT MARKINGS WILL BE CONSIDERED INCLUDED IN THE CONTRACT
 UNIT COST FOR TEMPORARY PAVEMENT MARKINGS

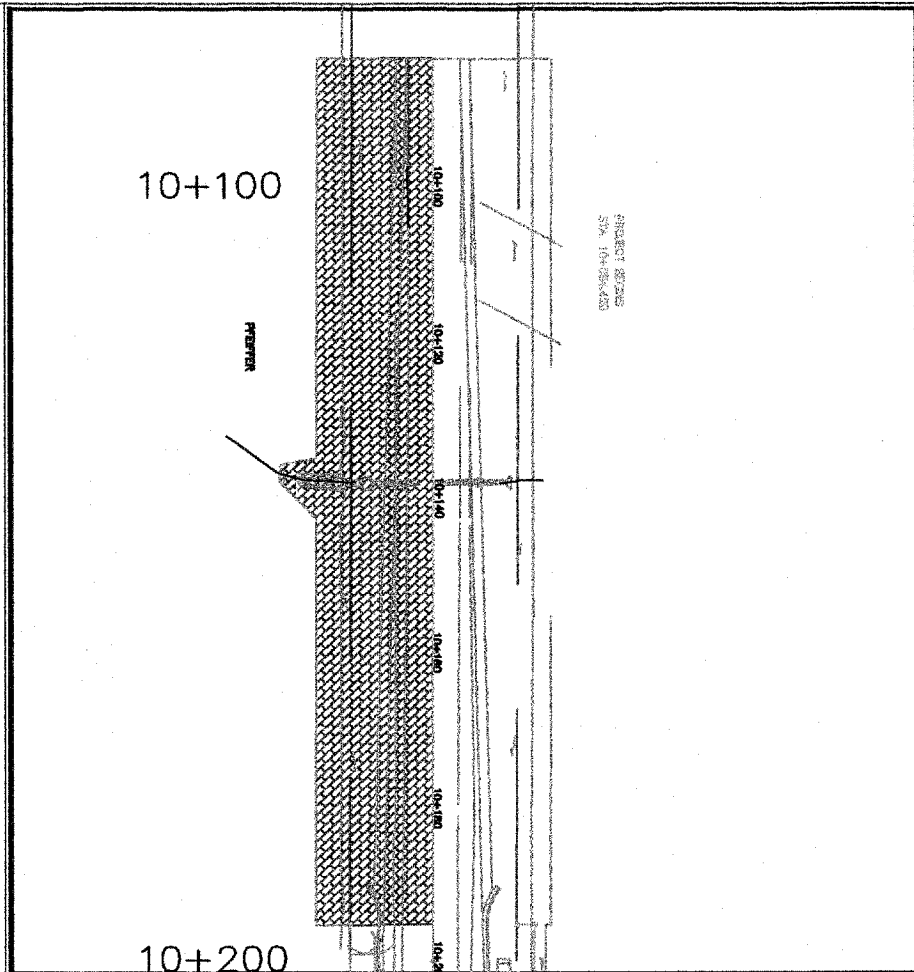

PFEIFFER ROAD

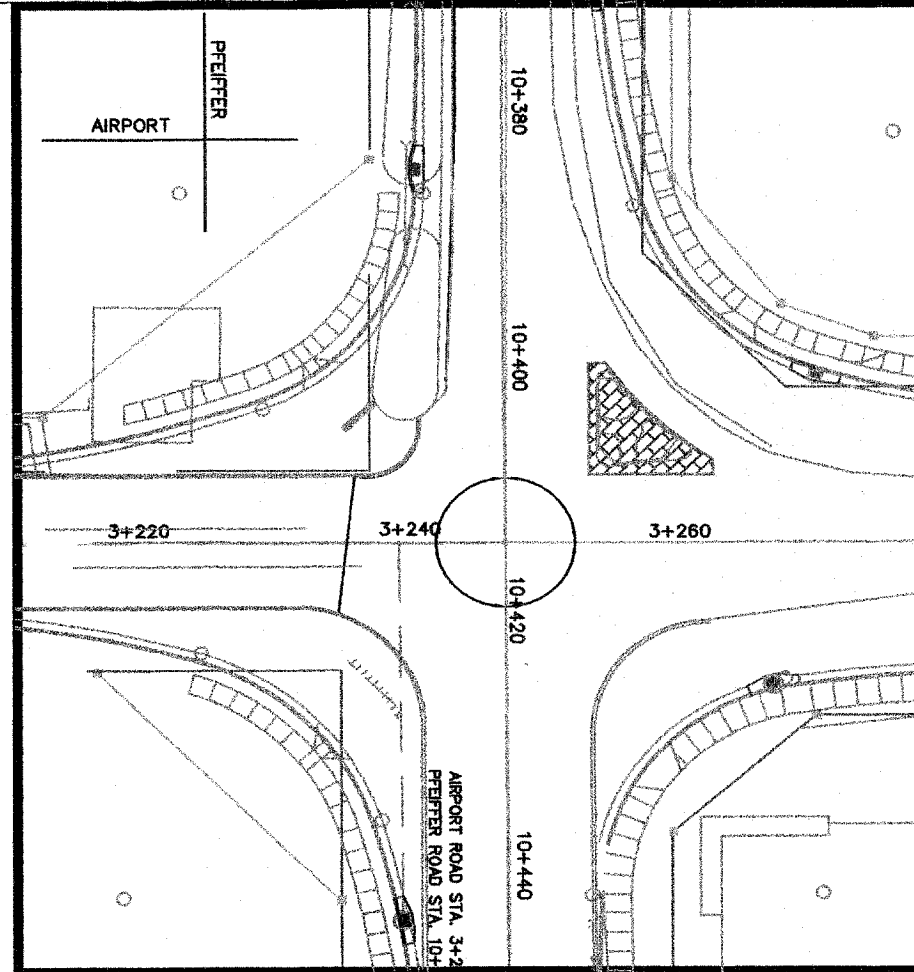

INTERSECTION

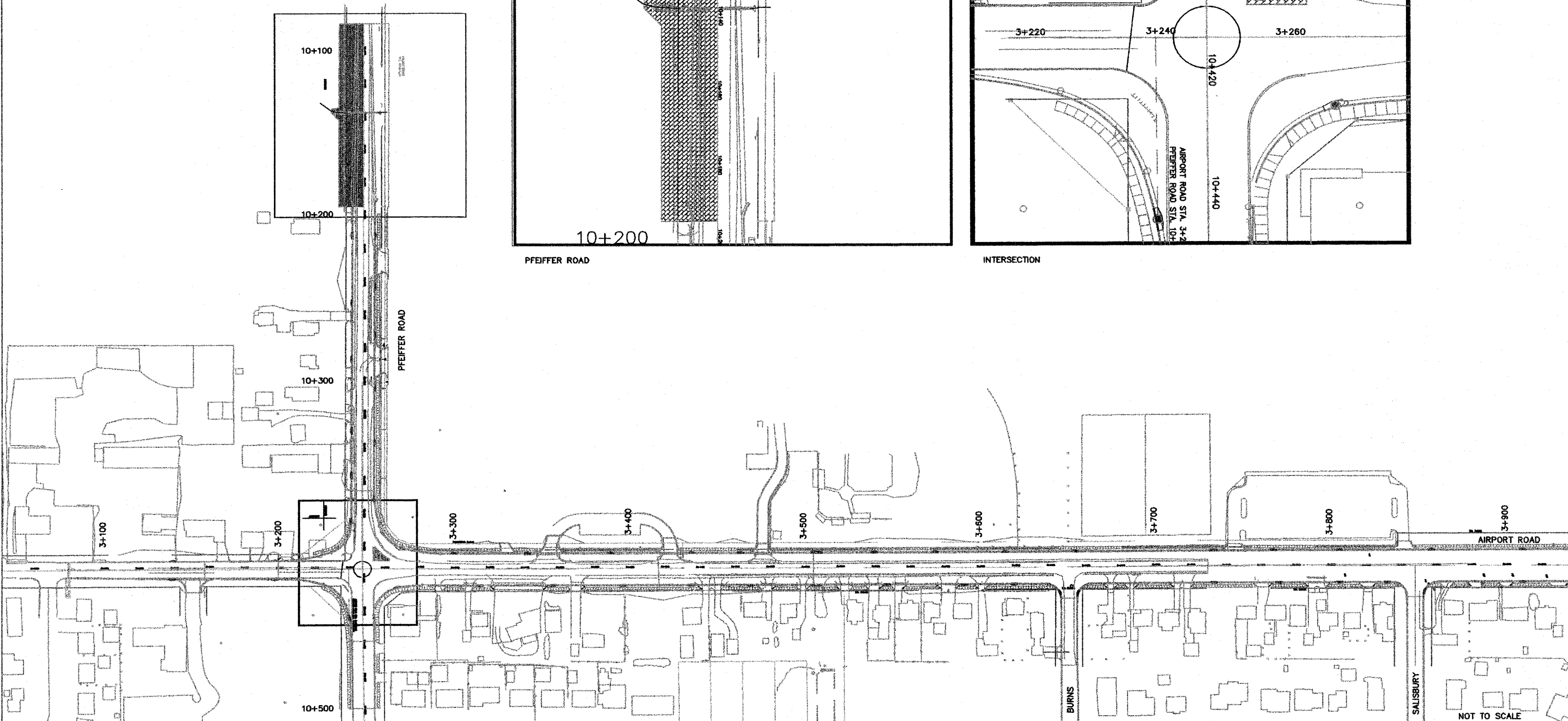

NOT TO SCALE