

GENERAL NOTES

1. THE CONSTRUCTION SHALL BE GOVERNED BY THE "STANDARD SPECIFICATIONS FOR ROAD AND BRIDGE CONSTRUCTION IN ILLINOIS", CURRENT EDITION.
2. THE CONTRACTOR SHALL BE RESPONSIBLE FOR HAVING THE UTILITY COMPANIES LOCATE THEIR FACILITIES ON SITE PRIOR TO ANY CONSTRUCTION AND WILL BE HELD RESPONSIBLE FOR THE MAINTENANCE AND PRESERVATION OF THEIR FACILITIES. THE CONTRACTOR, ON SITE, SHALL DETERMINE THE EXACT LOCATIONS OF THE UTILITIES. THE CONTRACTOR SHALL CALL J.U.L.I.E. @ 1-800-892-0123 FOR UTILITY LOCATIONS.
3. THE CONTRACTOR WILL BE RESPONSIBLE FOR REPAIRS TO ANY UTILITY LINES AND EXISTING IMPROVEMENTS TO REMAIN THAT ARE DAMAGED AS A RESULT OF THE WORK.
4. ADJUSTMENTS OF PROPOSED GRADES TO MATCH EXISTING ENTRANCES OR OTHER FIELD CONDITIONS MAY BE REQUIRED AS DIRECTED BY THE ENGINEER.
5. THE CONTRACTOR IS RESPONSIBLE FOR OBTAINING ALL NECESSARY PERMITS.
6. ACCESS SHALL BE MAINTAINED TO ALL PROPERTIES DURING ALL STAGES OF CONSTRUCTION.
7. EXCESS MATERIAL, IF NOT USED FOR OTHER ON-SITE PURPOSES, SHALL BE COMPLETELY REMOVED FROM THE CONSTRUCTION SITE AND DISPOSED OF OFF-SITE BY THE CONTRACTOR.
8. THE WORK AREA SHALL BE POSITIVELY DRAINED DURING CONSTRUCTION. FINAL GRADES SHALL BE PROTECTED AGAINST DAMAGE FROM EROSION, SEDIMENTATION, AND TRAFFIC.
9. WHERE SECTION OR SUBSECTION MONUMENTS ARE ENCOUNTERED, THE ENGINEER SHALL BE NOTIFIED BEFORE SUCH MONUMENTS ARE REMOVED. THE CONTRACTOR SHALL PROTECT AND CAREFULLY PRESERVE ALL PROPERTY MARKERS AND MONUMENTS UNTIL THE OWNER, AN AUTHORIZED SURVEYOR OR AGENT HAS WITNESSED OR OTHERWISE REFERENCED THEIR LOCATION.
10. THE OWNER RESERVES THE RIGHT TO REDUCE ANY QUANTITY OR DELETE PAY ITEMS FROM THIS CONTRACT. NO ADDITIONAL COMPENSATION WILL BE ALLOWED.
11. THE CONTRACTOR SHALL FIELD VERIFY ALL DIMENSIONS AND EXISTING CONDITIONS PRIOR TO CONSTRUCTION AND NOTIFY THE ENGINEER OF ANY DISCREPANCY IMMEDIATELY.
12. APPLICATION RATES:
 TEMPORARY EROSION CONTROL SEEDING: 100 LB/ACRE
 BITUMINOUS MATERIALS (PRIME COAT): 0.50 GAL/SQ YD (GRAVEL SURFACE)
 BITUMINOUS MATERIALS (PRIME COAT): 0.05 GAL/SQ YD (EXISTING PAVEMENT)
 BITUMINOUS MATERIAL (PRIME COAT): 0.1 GAL/SQ YD (MILLED SURFACE)
 BITUMINOUS MATERIAL (PRIME COAT): 0.03 GAL/SQ YD (PAVED SURFACE)
13. THE CONTRACTOR SHALL USE ANY ON SITE MATERIAL DEEMED SUITABLE BY THE ENGINEER BEFORE ANY NEW FILL IS HAULED TO THE SITE.
14. THE EXISTING GUARDRAIL ON THE SITE SHALL BE SALVAGED AND STOCK PILED FOR PICK-UP BY WARREN COUNTY.

SUMMARY OF QUANTITIES

CONSTRUCTION TYPE CODE X080-2#

CODE NO.	DESCRIPTION	QUANTITY	UNITS
20200100	EARTH EXCAVATION	CU YD	30
20400800	FURNISHED EXCAVATION	CU YD	325
21101615	TOPSOIL FURNISH AND PLACE, 4"	SQ YD	358
25000210	SEEDING, CLASS 2A	ACRE	0.10
25000400	NITROGEN FERTILIZER NUTRIENT	POUND	9
25000500	PHOSPHORUS FERTILIZER NUTRIENT	POUND	9
25000600	POTASSIUM FERTILIZER NUTRIENT	POUND	9
25100115	MULCH, METHOD 2	ACRE	0.10
28000250	TEMPORARY EROSION CONTROL SEEDING	POUND	40
28000300	TEMPORARY DITCH CHECKS	EACH	4
28000400	PERIMETER EROSION BARRIER	FOOT	450
28100810	STONE DUMPED RIPRAP, CLASS A5 (SPECIAL)	TON	316
35100100	AGGREGATE BASE COURSE, TYPE A	TON	42
40600100	BITUMINOUS MATERIAL (PRIME COAT)	GALLON	102
40600980	BITUMINOUS SURFACE REMOVAL-BUTT JOINT	SQ YD	204
48100100	AGGREGATE SHOULDERS, TYPE A	TON	40
50100100	REMOVAL OF EXISTING STRUCTURES	EACH	1
50200100	STRUCTURE EXCAVATION	CU YD	129.3
50300225	CONCRETE STRUCTURES	CU YD	36.2
50400305	PRECAST PRESTRESSED CONCRETE DECK BEAMS (17" DEPTH)	SQ FT	2424
50800205	REINFORCEMENT BARS, EPOXY COATED	POUND	4180
50901005	STEEL BRIDGE RAIL, TYPE SM	FOOT	155
51201400	FURNISHING STEEL PILES, HP 10x42	FOOT	513
51202700	DRIVING STEEL PILES	FOOT	513
51203400	TEST PILE, STEEL HP 10x42	EACH	1
51204315	CONCRETE ENCASEMENT	CU YD	20.9
51500100	NAME PLATE	EACH	1
58100200	WATERPROOFING MEMBRANE SYSTEM	SQ YD	276
63100087	TRAFFIC BARRIER TERMINAL, TYPE 6A	EACH	4
63100167	TRAFFIC BARRIER TERMINAL, TYPE 1, SPECIAL (TANGENT)	EACH	4
63200310	GUARDRAIL REMOVAL	FOOT	163
67100100	MOBILIZATION	L SUM	1
70101700	TRAFFIC CONTROL AND PROTECTION	L SUM	1
78200410	GUARDRAIL MARKERS, TYPE A	EACH	8
78201000	TERMINAL MARKER DIRECT APPLIED	EACH	4
X4066414	BITUMINOUS CONCRETE SURFACE COURSE, SUPERPAVE, MIX "C", N50	TON	150
X5020501	UNDERWATER STRUCTURE EXCAVATION PROTECTION, LOCATION 1	EACH	1
X5020502	UNDERWATER STRUCTURE EXCAVATION PROTECTION, LOCATION 2	EACH	1

• SEE SPECIAL PROVISIONS AND/OR DETAILS IN PLANS

F.A.S. RTE.	SECTION	COUNTY	TOTAL SHEETS	SHEET NO.
405	04-00035-01-BR	WARREN	16	2
STA.		TO STA.		
FED. ROAD DIST. NO. 7		ILLINOIS	PROJECT NO. BRS-405(103)	
CONTRACT NO. 89381				

EDGE OF PAVEMENT STATION, OFFSET, & ELEVATION

STATION	OFFSET LT.	ELEV. LT.	OFFSET RT.	ELEV. RT.	CL ELEV.
32+34.25	-10.15	99.76	10.35	99.72	100.00
32+50.00	-10.40	99.70	10.57	99.66	99.93
33+00.00	-11.16	99.49	11.25	99.47	99.70
33+50.00	-11.94	99.30	11.94	99.30	99.48
34+00.00	-16.00	99.10	16.00	99.10	99.34
34+50.00	-11.77	98.96	11.68	98.96	99.15
35+00.00	-11.15	98.66	10.79	98.65	98.87
35+50.00	-10.53	98.37	9.91	98.35	98.60
35+51.75	-10.51	98.36	9.88	98.34	98.59

SUGGESTED SEQUENCE OF CONSTRUCTION

1. CONSTRUCT TEMPORARY EROSION CONTROL MEASURES.
2. INSTALL TRAFFIC CONTROL FOR ROAD CLOSURE. (NO MARKED DETOUR NEEDED)
3. REMOVE EXISTING STRUCTURE.
4. CONSTRUCT NEW BRIDGE STRUCTURE.
5. OVERLAY ROADWAY.
6. INSTALL GUARDRAIL.
7. FINAL SHAPE AND SEED PROJECT AREA AND FINISH MISCELLANEOUS ROAD WORK ITEMS.
8. OPEN ROADWAY TO TRAFFIC.

BENCHMARKS:

1. COTTON SPINDEL IN POWER POLE SOUTH OF BRIDGE AND WEST OF COUNTY HIGHWAY 1. ELEV. = 100.00
2. TOP OF BRIDGE CURB AT NORTH END OF WEST CURB. ELEV. = 99.55

NOTE

BENCHMARK #2 WILL BE DESTROYED DURING REMOVAL OF EXISTING STRUCTURE. CONTRACTOR WILL NEED TO TRANSFER BENCHMARK TO ANOTHER LOCATION BEFORE BEGINNING CONSTRUCTION ACTIVITIES.

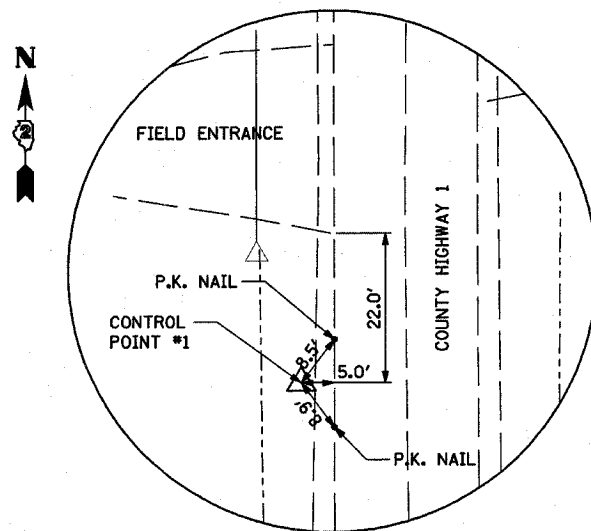

CONTROL POINT #1
1/2" IRON PIN SET
STA. 30+93.91

CONTROL POINT #	NORTHING	EASTING	ELEVATION	DESCRIPTION
1	10000.000	10000.000	102.87	1/2" IRON PIN
2	10501.260	10000.000	98.28	1/2" IRON PIN

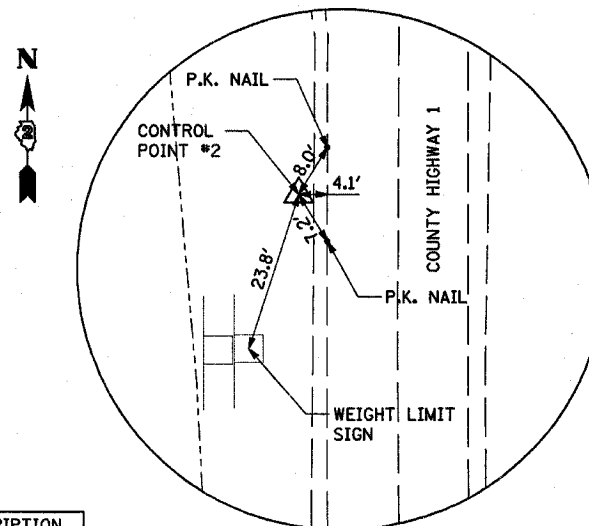

CONTROL POINT #2
1/2" IRON PIN SET
STA. 35+95.17

REVISIONS	
NAME	DATE

ILLINOIS DEPARTMENT OF TRANSPORTATION
 F.A.S. 405
 SECTION 04-00035-01-BR
 WARREN COUNTY
 COUNTY HIGHWAY 1 OVER MIDDLE HENDERSON CREEK
SUMMARY OF QUANTITIES,
GENERAL NOTES,
AND CONTROL POINTS
 SCALE: VERT. _____ DRAWN BY RLA
 HORIZ. _____ CHECKED BY JDS
 DATE 02/06/06

HANSON
 Hanson Professional Services Inc.
 Copyright Hanson Professional Services Inc. 2006

LAYOUT RLA 09/22/05 /MS
 DRAWN RLA 02/01/06 02/06/2006 11:41 AM
 REVIEWED JDS 02/03/06 #FILE#