

ROUTE NO.	SECTION	COUNTY	TOTAL SHEETS	SHEET NO.
C.H. 10 FAS 732	01-00083 -00-BR	CHRISTIAN	12	4
ILLINOIS				

CONTRACT NO. 93403

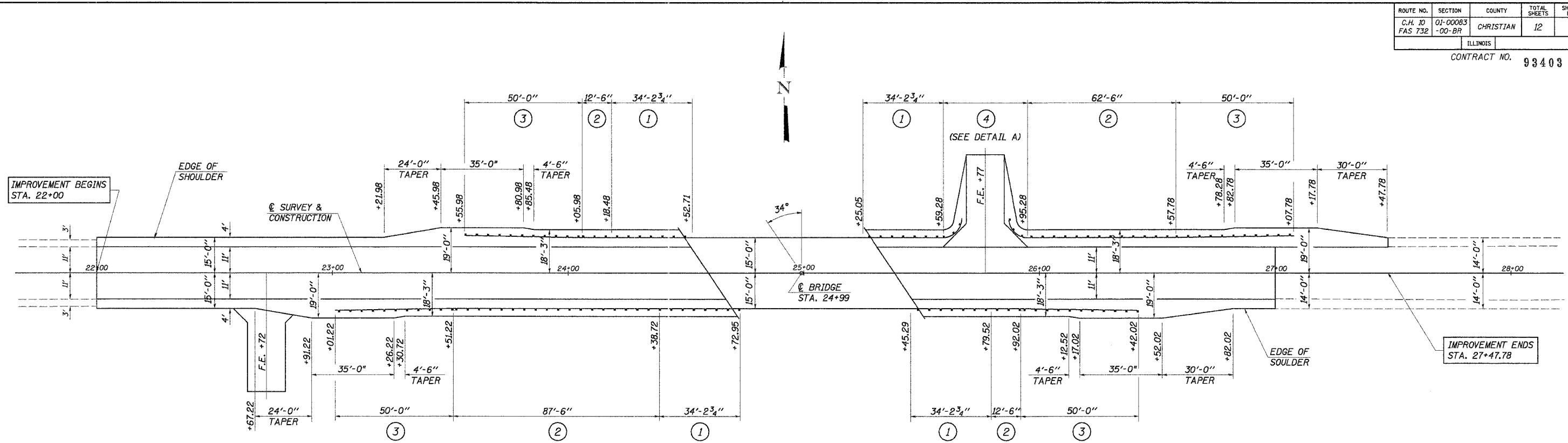

PLAN

TRAFFIC BARRIER TERMINAL, TYPE 6A

15' LT. STA. 24+18.48 TO 15' LT. STA. 24+52.71	= 1 EACH
15' RT. STA. 24+38.72 TO 15' RT. STA. 24+72.95	= 1
15' LT. STA. 25+25.05 TO 15' LT. STA. 25+59.28	= 1
15' RT. STA. 25+45.29 TO 15' RT. STA. 25+79.52	= 1
TOTAL	= 4 EACH

TRAFFIC BARRIER TERMINAL, TYPE 1, SPECIAL (TANGENT)

15'-9" LT. STA. 23+55.98 TO 15' LT. STA. 24+05.98	= 1 EACH
15'-9" RT. STA. 23+01.22 TO 15' RT. STA. 23+51.22	= 1
15' LT. STA. 26+57.78 TO 15'-9" LT. STA. 27+07.78	= 1
15' RT. STA. 26+42.02 TO 15'-9" RT. STA. 26+92.02	= 1
TOTAL	= 4 EACH

STEEL PLATE BEAM GUARDRAIL, TYPE A

15' LT. STA. 24+05.98 TO 15' LT. STA. 24+18.48	= 12.5 FOOT
15' RT. STA. 23+51.22 TO 15' RT. STA. 24+38.72	= 87.5
15' LT. STA. 25+95.28 TO 15' LT. STA. 26+57.78	= 62.5
15' RT. STA. 25+79.52 TO 15' RT. STA. 25+92.02	= 12.5
TOTAL	= 175.0 FOOT

TRAFFIC BARRIER TERMINAL, TYPE 2 (SPECIAL)

15' LT. STA. 25+59.28 TO 23' LT. STA. 25+67.28	= 1 EACH
23' LT. STA. 25+87.28 TO 15' LT. STA. 25+95.28	= 1
TOTAL	= 2 EACH

GUARDRAIL REMOVAL

LT. STA. 24+13 TO STA. 24+55	= 42 FOOT
RT. STA. 24+32 TO STA. 24+74	= 42
LT. STA. 25+24 TO STA. 25+62	= 38
RT. STA. 25+43 TO STA. 25+84	= 41
TOTAL	= 163 FOOT

LEGEND

NOTE: ALL DIMENSIONS REFER TO FRONT FACE OF PROPOSED RAILING.

- ① TRAFFIC BARRIER TERMINAL, TYPE 6A
- ② STEEL PLATE BEAM GUARDRAIL, TYPE A
- ③ TRAFFIC BARRIER TERMINAL, TYPE 1, SPECIAL (TANGENT)
- *④ TRAFFIC BARRIER TERMINAL, TYPE 2 (SPECIAL)

*SHOP BEND TO MATCH DETAIL A

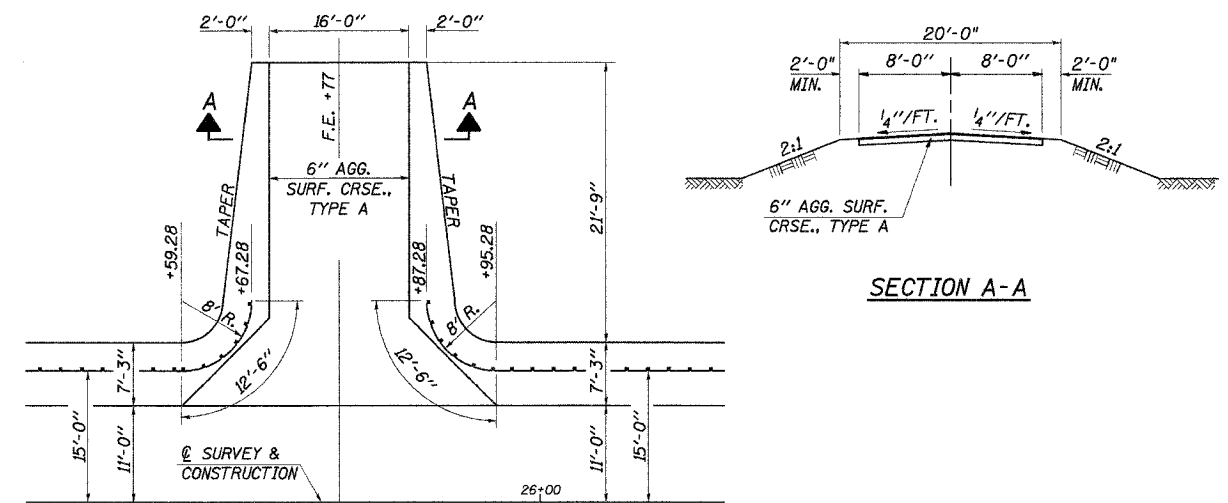

DETAIL A

SECTION A-A

DESIGNED	FJS
CHECKED	SFM
DRAWN	SAP & KTR
CHECKED	SFM

SHOULDER AND GUARDRAIL DETAILS

SECTION 01-00083-00-BR
F.A.S. ROUTE 732 (C.H. 10)
CHRISTIAN COUNTY
STATION 24+99

4440 ASH GROVE SPRINGFIELD, IL 62707 (217) 793-8600 oasinc@farmvid.com	OZYURT AND STONE, INC. CONSULTING ENGINEERS	JOB NO.: 0304 FILE: SHLDR.DGN DATE: 02-19-04
---	---	--