

ROUTE NO.	SECTION	COUNTY	TOTAL SHEETS	SHEET NO.
C.H. 10 FAS 732	01-00083 -00-BR	CHRISTIAN	12	5
ROAD DIST.		ILLINOIS	CONTRACT NO. 93403	

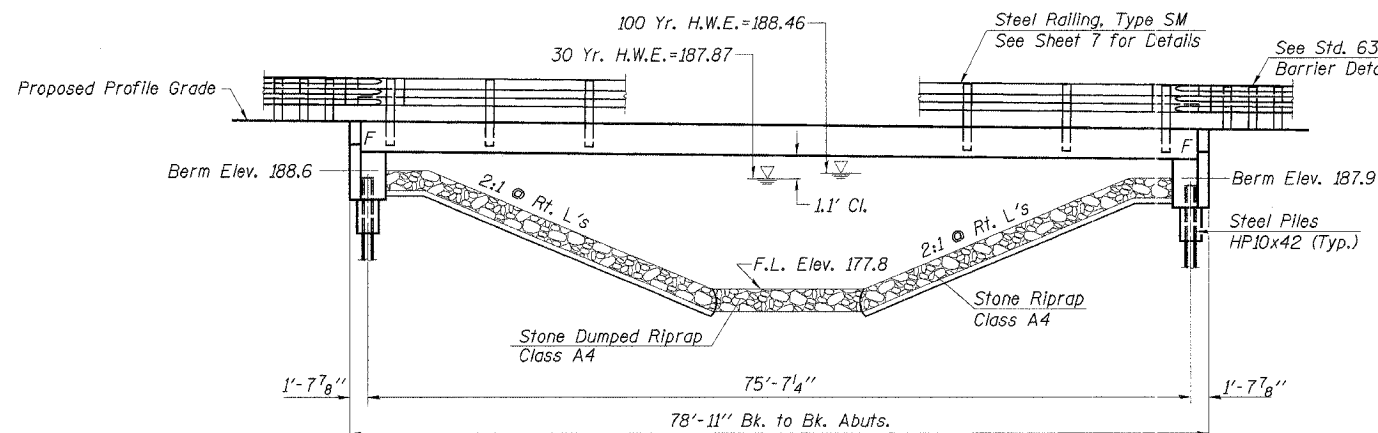

ELEVATION

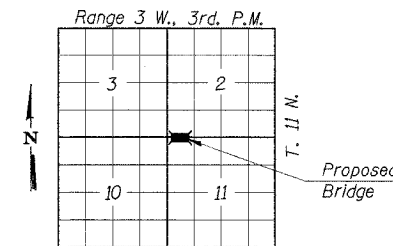

LOCATION PLAN

GENERAL NOTES

See Special Provisions for Boring data.

Reinforcement bars shall conform to the requirements of AASHTO M-31, M-42 or M-53, Grade 60.

The Contractor shall drive one steel test pile in a permanent location at each abutment as directed by the Engineer, before ordering the remainder of piles.

Layout of slope protection system may be varied in the field to suit ground conditions as directed by the Engineer.

Structure excavation will not be paid for as a separate item but shall be considered as included in the contract unit price for the class of concrete involved.

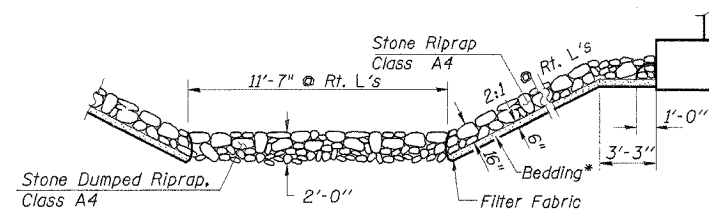

RIPRAP PLACEMENT

*(Included in the cost of Riprap)

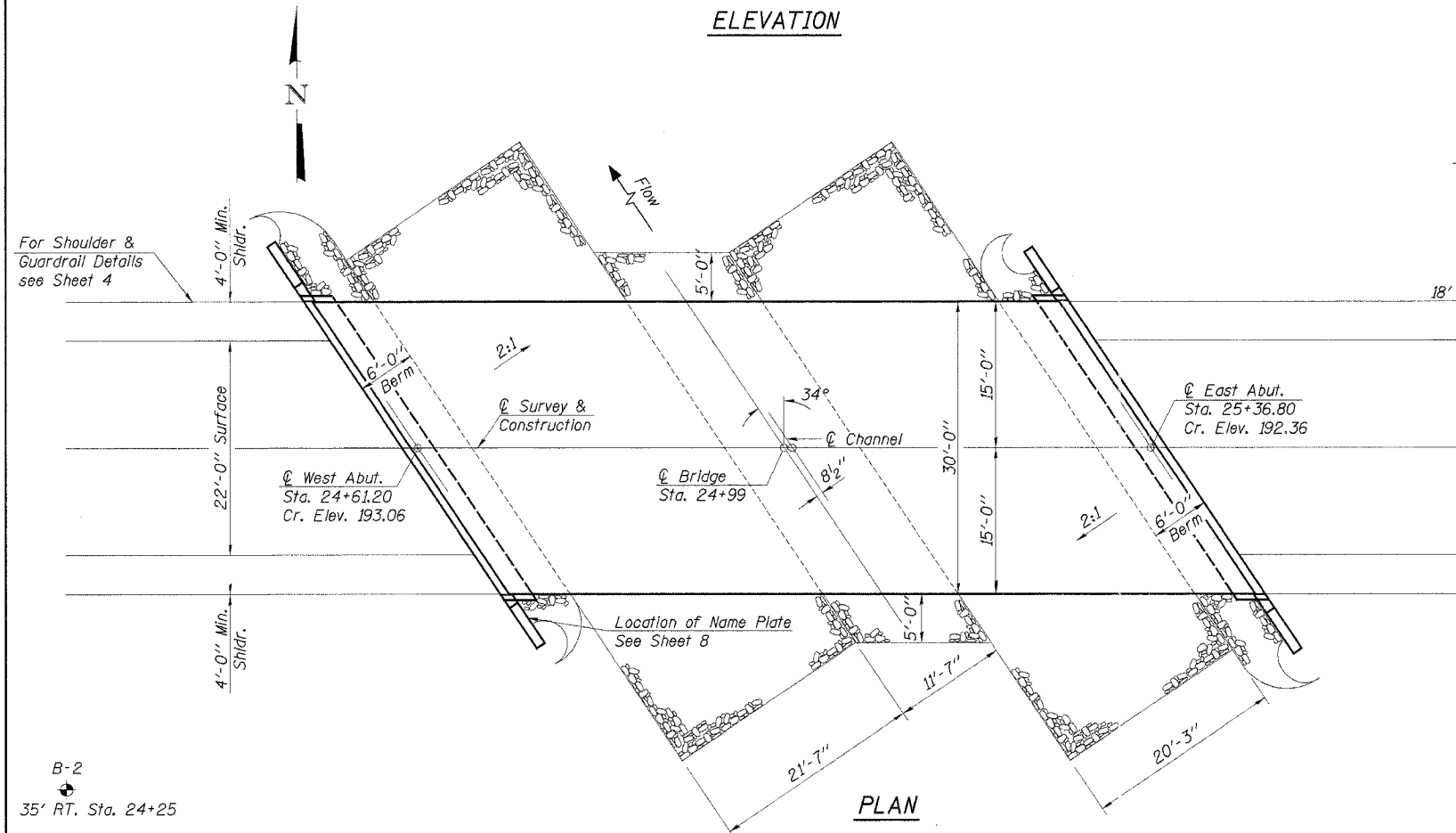

PLAN

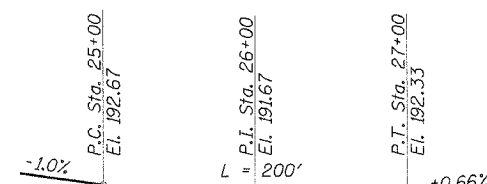

PROFILE GRADE

MILLER BRANCH
BUILT 200_ BY
CHRISTIAN COUNTY
SEC. 01-00083-00-BR
F.A.S. ROUTE 732
F.A. PROJ. BRS-732(144)
STR. NO. 011-3397 LOADING HS20

LETTERING FOR NAME PLATE

See Std. 515001

TOTAL BILL OF MATERIAL

ITEM	UNIT	SUPER	SUB	TOTAL
Precast Prestressed Concrete Deck Beams (33" Depth)	Sq. Ft.	2310		2310
Concrete Structures	Cu. Yd.		35.2	35.2
Reinforcement Bars	Pound		3880	3880
Steel Bridge Rail, Type SM	Foot	156		156
Name Plates	Each		1	1
Steel Piles HP10x42	Foot		550	550
Test Pile Steel HP10x42	Each		2	2
Stone Riprap, Class A4	Ton		266	266
Filter Fabric	Sq. Yd.		363	363
Stone Dumped Riprap, Class A4	Ton		68	68
Bit. Conc. Surf. Crse., Mix C N50	Ton	30		30
Waterproofing Membrane System	Sq. Yd.	257		257
P.C. Mortar Fairing Course	Foot	200		200
Concrete Encasement	Cu. Yd.		4.2	4.2

DESIGN STRESSES

$f_c = 5,000$ p.s.i. (Prestressed Beams)
 $f_{ci} = 4,000$ p.s.i. (Prestressed Beams)
 $f_c = 1,400$ p.s.i. (Concrete)
 $f_s = 270,000$ p.s.i. (Prestressed Strands)
 $f_{si} = 201,960$ p.s.i. (Prestressed Strands)
 $f_s = 24,000$ p.s.i. (Reinf. Bars -- Field Units)
 $f_y = 60,000$ p.s.i. (Reinf. Bars -- Field Units)
 $n = 9$ (Concrete)
 LOADING HS20-44
 Design Specifications: 2002 AASHTO
 25#1/Sq. Ft. Included in dead load for future wearing surface.

WATERWAY INFORMATION

Drainage Area	6.53 Sq. Mi.
Existing Opening (30 Yr.)	232 Sq. Ft.
Required Opening (30 Yr.)	310 Sq. Ft.
Proposed Opening (30 Yr.)	310 Sq. Ft.
Design Discharge (30 Yr.)	1154 C.F.S.
Created Head (30 Yr.)	0.54 Ft.
100 Year Discharge	1536 C.F.S.
100 Yr. Created Head	0.28 Ft.

DESIGNED	FJS
CHECKED	SFM
DRAWN	SAP & KTR
CHECKED	SFM

"I certify that to the best of my knowledge, information and belief, this bridge design is structurally adequate for the design loading shown on the plans. The design is an economical one for the style of structure and complies with requirements of the current 'AASHTO Standard Specifications for Highway Bridges'."



Fred J. Stone, Jr. (11-29-05)
 ILLINOIS STRUCTURAL NO. 2934 (Expires 11/30/06)

GENERAL PLAN & ELEVATION

SECTION 01-00083-00-BR
 F.A.S. ROUTE 732
 CHRISTIAN COUNTY
 STATION 24+99

4440 ASH GROVE
 SPRINGFIELD, IL 62707
 (217) 793-8800
 oasinc@famvid.com

OZYURT AND STONE, INC.
 CONSULTING ENGINEERS

JOB NO.: 0304
 FILE: GPE.DGN
 DATE: 02-18-04