

ROUTE NO.	SEC.	COUNTY	TOTAL SHEETS	SHEET NO.
FAS RTE 1588	*	ADAMS	38	38
FED. ROAD DIST. NO. 7		ILLINOIS	PROJECT	

Location #2, Structure No. 001-3028
 * 05-00189-00-BR

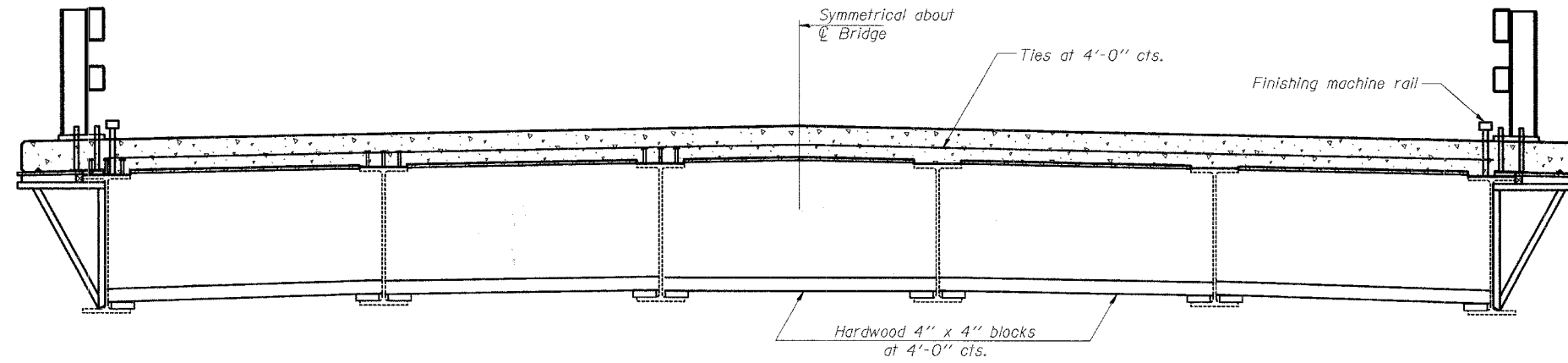

**FORM BRACES FOR
STANDARD CONSTRUCTION**

When cantilever forming brackets are used, the work shall be done according to Article 503.06, except as modified below and in the details shown on this sheet.

The finishing machine rails shall be placed on the top flange of the exterior beams.

The beams or girders, supporting cantilever forming brackets, shall be tied together at 4 foot intervals.

For Standard construction the Hardwood bracing materials shall be placed as shown between webs of beams in each bay.

REV. NO.	DRAWN	CHKD.	APPD.	DESCRIPTION	DATE
					12/05
F.A.S. RTE. 1588 OVER WALNUT CREEK SECTION 05-00189-00-BR Project RS-1588 (106) ADAMS COUNTY					
CANTILEVER FORMING BRACKETS (W27 BEAMS & SMALLER) STRUCTURE NUMBER 001-3028 STATION 407+65					