

ROUTE NO.	SECTION	COUNTY	TOTAL SHEETS	SHEET NO.
CH 3	*	PIKE	17	4
FED. ROAD DIST. NO. 7		ALIGNMENT	PROJECT	BRS-601(17)
*04-00079-00-BR				

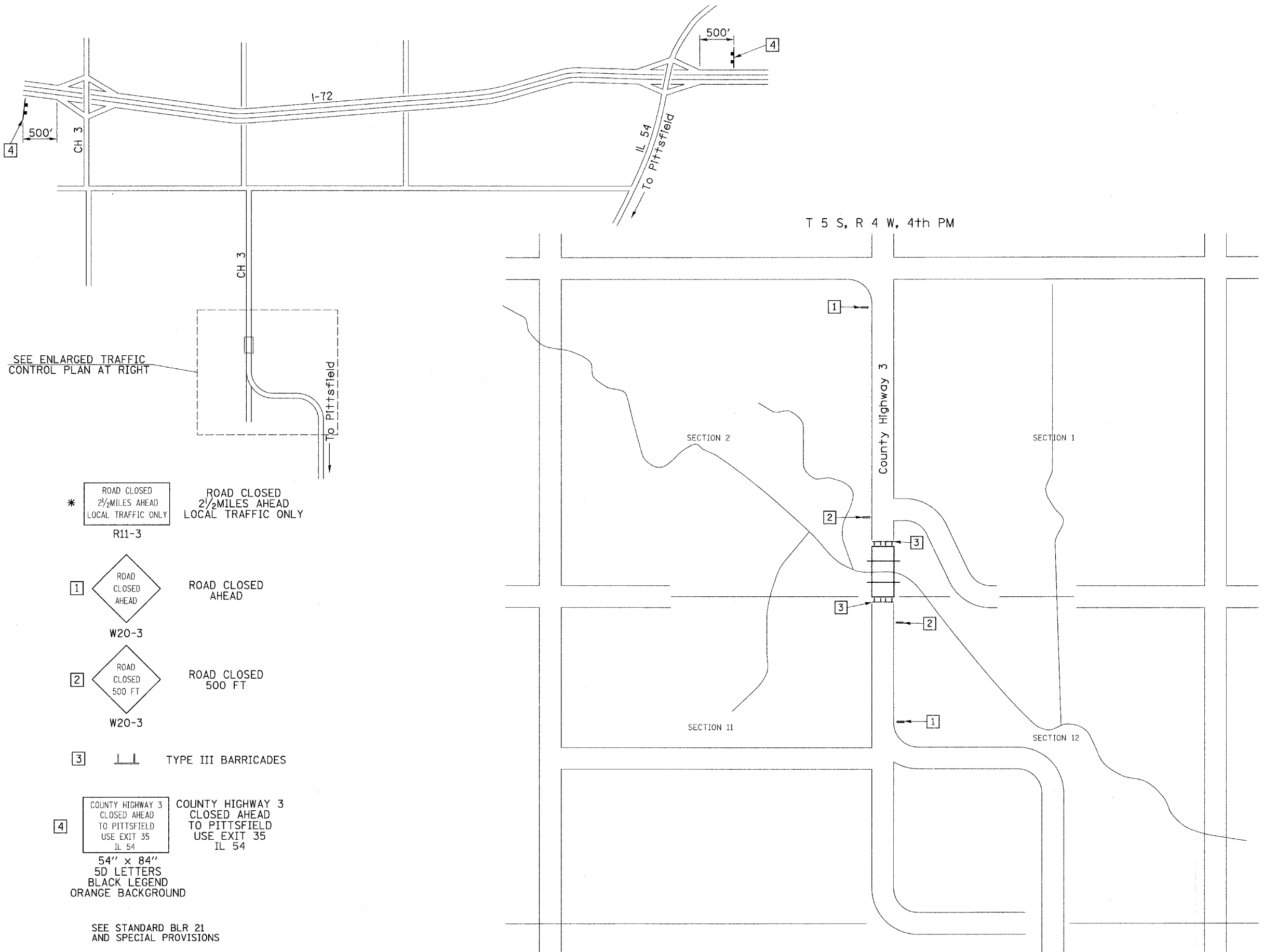

SEE ENLARGED TRAFFIC CONTROL PLAN AT RIGHT

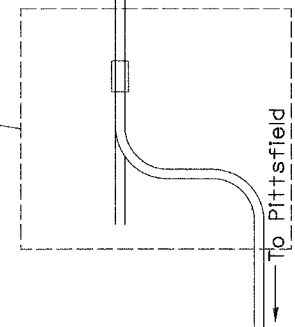

\* ROAD CLOSED 2 1/2 MILES AHEAD LOCAL TRAFFIC ONLY  
 R11-3

1 ROAD CLOSED AHEAD  
 W20-3

2 ROAD CLOSED 500 FT  
 W20-3

3 TYPE III BARRICADES

4 COUNTY HIGHWAY 3 CLOSED AHEAD TO PITTSFIELD USE EXIT 35 IL 54  
 54" x 84" 5D LETTERS BLACK LEGEND ORANGE BACKGROUND

SEE STANDARD BLR 21 AND SPECIAL PROVISIONS

\* ADVANCE WARNING R11-3 SIGNS SHALL BE PLACED AT THE SOUTH EDGE OF THE I-72 INTERCHANGE AND AT THE NORTH PITTSFIELD CITY LIMIT

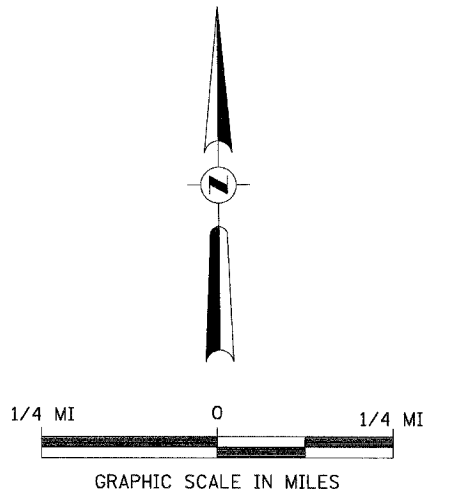

TRAFFIC CONTROL PLAN  
 COUNTY HIGHWAY 3 OVER  
 BAY CREEK  
 SECTION 04-00079-00-BR  
 PIKE COUNTY  
 STATION 133+69.88