

F.A.P. ROUTE	SECTION	COUNTY	TOTAL SHEETS	SHEET NO.
322	182 & 18Y, RS 282	MARION	222	35
STA. 2321+00.00		TO STA. 2327+00.00		
DIST. DIST. NO. 7		ILLINOIS FED. AID PROJECT		
CONTRACT NO. 94700				

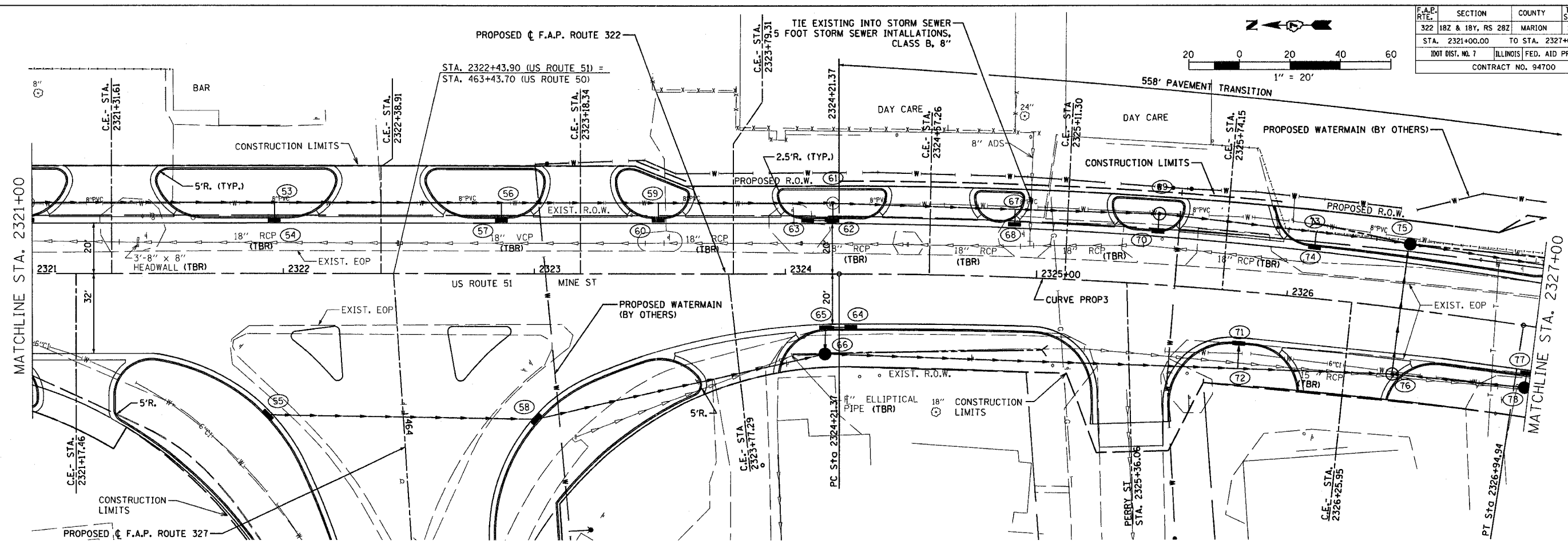

PLAN	DATE
BY	
NO.	

PROFILE	DATE
BY	
NO.	

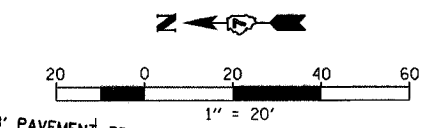
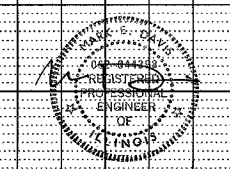
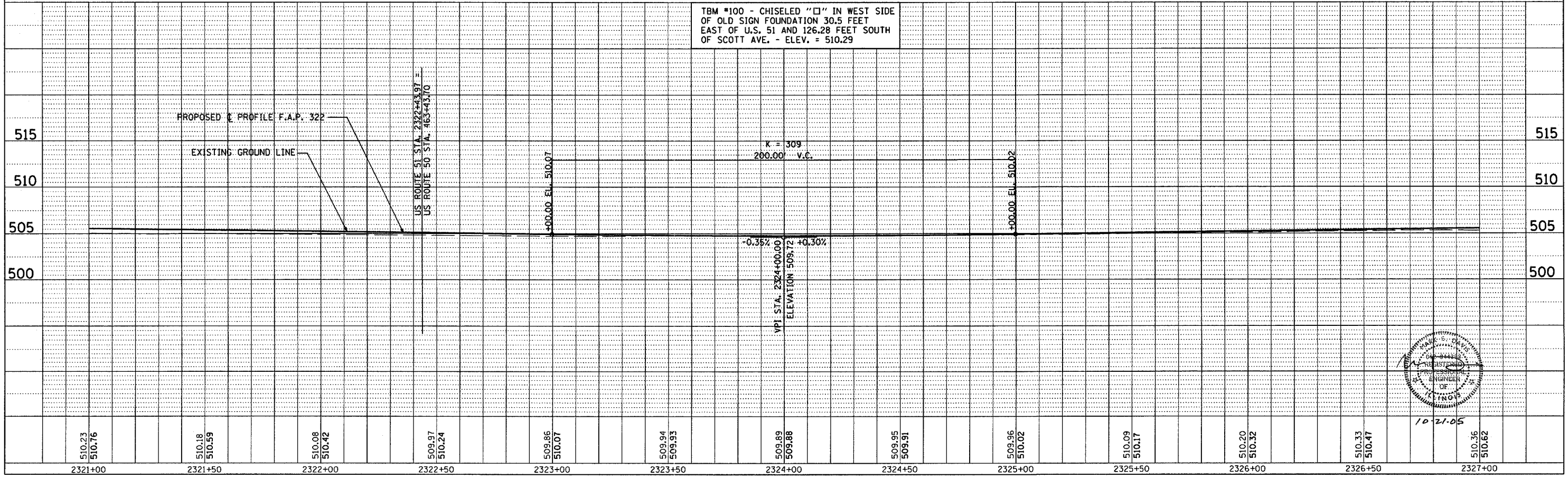

I:\33082\working\33082.dgn 10/27/05 8:06:35 AM