

F.A.R. RTE.	SECTION	COUNTY	TOTAL SHEETS	SHEET NO.
322	18Z & 18Y, RS 28Z	MARION	222	77
STA.		TO STA.		
DOT DIST. NO. 7		ILLINOIS FED. AID PROJECT		
CONTRACT NO. 94700				

N.E. QUADRANT			
STATIONING ALONG U.S. RTE. 51	OFFSET TO EOP FEET	EOP ELEV FEET	DISTANCE ALONG RAD. FEET
LT. 2318+39.17	20.00	511.26	
LT. 2318+49.00	21.85	511.11	10.00
LT. 2318+57.48	27.15	510.96	20.00
LT. 2318+63.45	35.18	510.81	30.00
LT. 2318+66.08	44.82	510.66	40.00
LT. 2318+65.47	54.80	510.51	50.00
LT. 2318+65.43	55.17	510.50	50.61

S.E. QUADRANT			
STATIONING ALONG U.S. RTE. 51	OFFSET TO EOP FEET	EOP ELEV FEET	DISTANCE ALONG RAD. FEET
LT. 2319+19.66	20.00	510.99	
LT. 2319+09.83	21.85	510.90	10.00
LT. 2319+01.36	27.15	510.81	20.00
LT. 2318+95.93	35.56	510.72	30.00
LT. 2319+02.56	43.05	510.63	40.00
LT. 2319+02.92	43.06	510.61	40.36

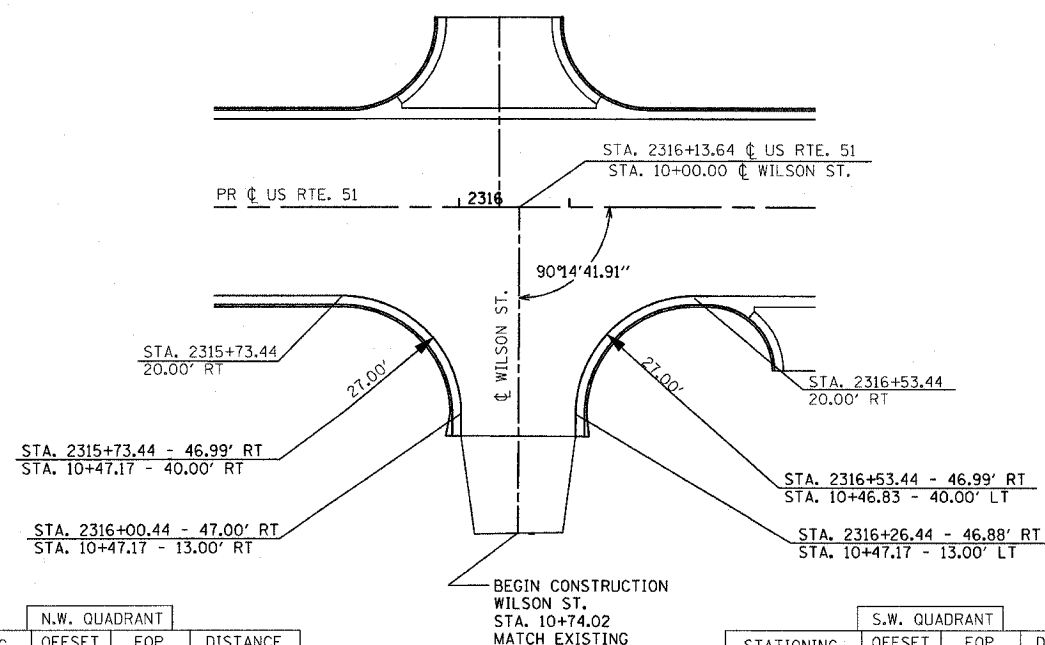

N.W. QUADRANT			
STATIONING ALONG U.S. RTE. 51	OFFSET TO EOP FEET	EOP ELEV FEET	DISTANCE ALONG RAD. FEET
RT. 2315+73.44	20.00	512.19	
RT. 2315+83.27	21.85	512.00	10.00
RT. 2315+91.75	27.15	511.81	20.00
RT. 2316+97.72	35.18	511.63	30.00
RT. 2316+00.35	44.82	511.44	40.00
RT. 2316+00.44	52.12	511.30	47.30

S.W. QUADRANT			
STATIONING ALONG U.S. RTE. 51	OFFSET TO EOP FEET	EOP ELEV FEET	DISTANCE ALONG RAD. FEET
RT. 2316+53.44	20.00	511.92	
RT. 2316+43.62	21.85	511.79	10.00
RT. 2316+35.14	27.15	511.66	20.00
RT. 2316+29.17	35.18	511.53	30.00
RT. 2316+26.53	44.82	511.40	40.00
RT. 2316+26.42	52.24	511.30	47.42

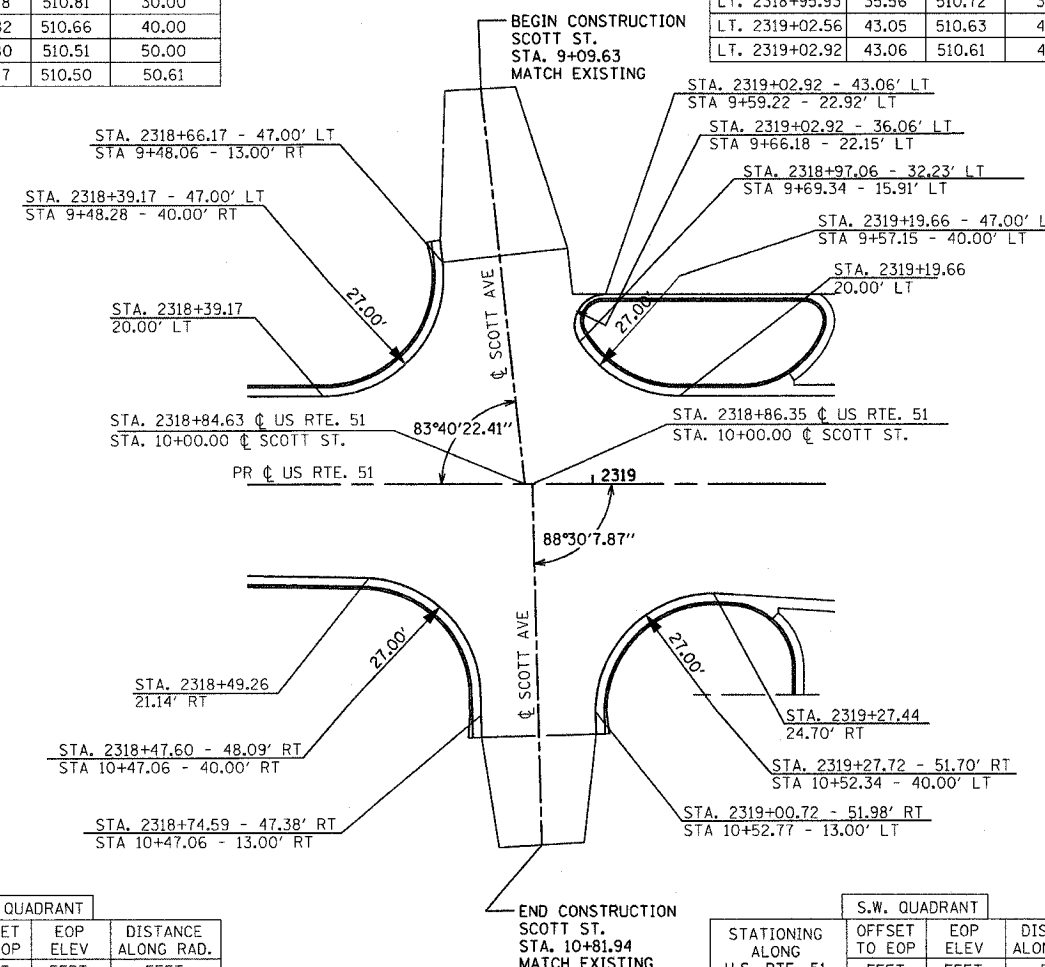
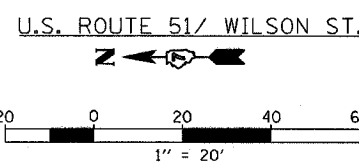

N.W. QUADRANT			
STATIONING ALONG U.S. RTE. 51	OFFSET TO EOP FEET	EOP ELEV FEET	DISTANCE ALONG RAD. FEET
RT. 2318+49.26	21.14	511.20	
RT. 2318+58.96	23.59	511.01	10.00
RT. 2318+67.09	29.41	510.82	20.00
RT. 2318+72.55	37.79	510.64	30.00
RT. 2318+74.59	47.58	510.45	40.00
RT. 2318+74.85	57.57	510.26	50.00

S.W. QUADRANT			
STATIONING ALONG U.S. RTE. 51	OFFSET TO EOP FEET	EOP ELEV FEET	DISTANCE ALONG RAD. FEET
RT. 2319+27.44	24.70	510.88	
RT. 2319+17.63	26.66	510.75	10.00
RT. 2319+09.21	32.05	510.62	20.00
RT. 2319+03.32	40.13	510.49	30.00
RT. 2318+00.78	49.81	510.36	40.00
RT. 2319+00.85	56.98	510.26	47.18

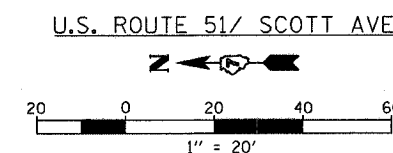

REVISIONS		ILLINOIS DEPARTMENT OF TRANSPORTATION
NAME	DATE	
		INTERSECTION WARPING / GEOMETRIC LAYOUT U.S. ROUTE 51
SCALE:	VERT. 1"=20'	DRAWN BY MEC CHECKED BY MJM
DATE	HORIZ. 1"=20'	
DATE 6/27/03		