

F.A.D. No.	SECTION	COUNTY	TOTAL SHEETS	SHEET NO.
327	1B2 & 1B3, RS 2B2	MARION	222	84
STA.		TO STA.		
DOT DIST. NO. 7		ILLINOIS FED. AID PROJECT		
CONTRACT NO. 94700				

S.E. QUADRANT			
STATIONING ALONG U.S. RTE. 50	OFFSET TO EOP FEET	EOP ELEV FEET	DISTANCE ALONG RAD. FEET
LT. 476+57.43	13.00	508.72	
LT. 476+67.14	14.89	508.51	10.00
LT. 476+75.45	20.28	508.29	20.00
LT. 476+81.17	28.40	508.08	30.00
LT. 476+83.56	38.10	507.86	40.00
LT. 476+83.07	47.11	507.67	49.02

S.W. QUADRANT			
STATIONING ALONG U.S. RTE. 50	OFFSET TO EOP FEET	EOP ELEV FEET	DISTANCE ALONG RAD. FEET
LT. 477+35.37	13.00	509.28	
LT. 477+25.66	14.89	508.97	10.00
LT. 477+17.36	20.28	508.66	20.00
LT. 477+11.63	28.41	508.34	30.00
LT. 477+09.22	38.09	508.03	40.00
LT. 477+08.16	48.03	507.72	50.00
LT. 477+08.51	20.00	507.67	51.64

S.E. QUADRANT			
STATIONING ALONG U.S. RTE. 50	OFFSET TO EOP FEET	EOP ELEV FEET	DISTANCE ALONG RAD. FEET
LT. 478+02.54	13.00	509.47	
LT. 478+12.25	14.89	509.26	10.00
LT. 478+20.56	20.28	509.05	20.00
LT. 478+26.28	28.41	508.83	30.00
LT. 478+28.67	38.10	508.62	40.00
LT. 478+27.51	48.03	508.41	50.00
LT. 478+26.74	51.19	508.34	53.26

S.W. QUADRANT			
STATIONING ALONG U.S. RTE. 50	OFFSET TO EOP FEET	EOP ELEV FEET	DISTANCE ALONG RAD. FEET
LT. 478+84.50	12.64	509.62	
LT. 478+74.63	14.26	509.41	10.00
LT. 478+66.03	19.36	509.21	20.00
LT. 478+59.87	27.25	509.00	30.00
LT. 478+56.69	36.73	508.79	40.00
LT. 478+54.10	46.38	508.59	50.00
LT. 478+51.51	56.04	508.38	60.00
LT. 478+51.06	57.75	508.34	61.80

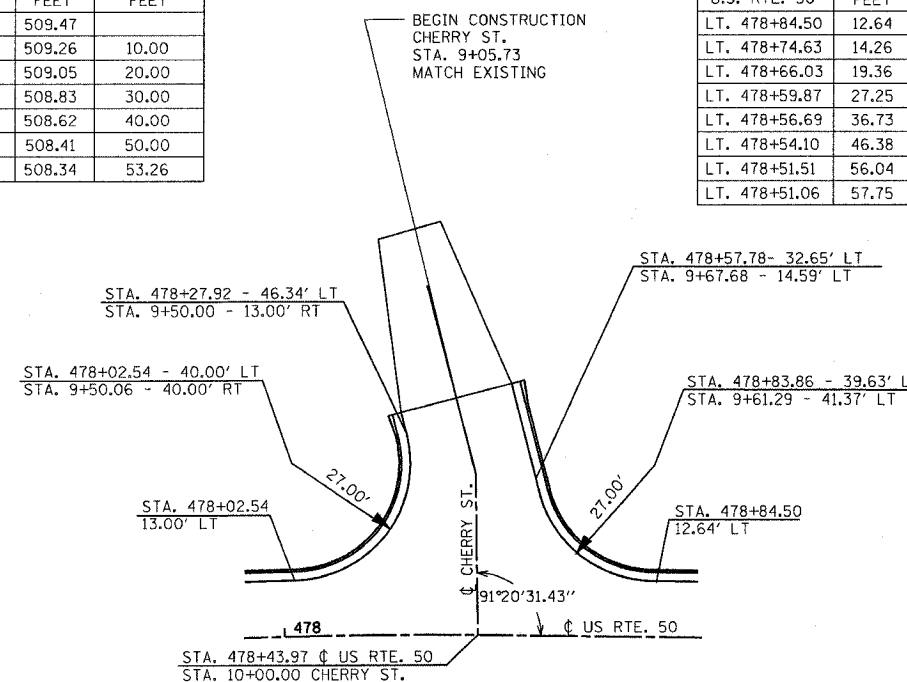
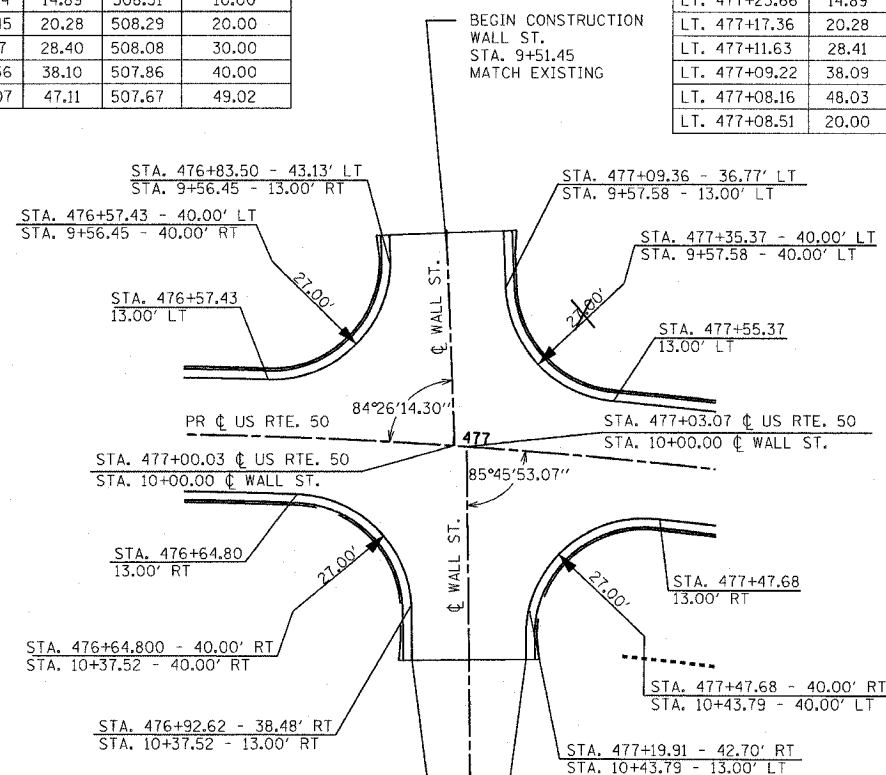

N.E. QUADRANT			
STATIONING ALONG U.S. RTE. 50	OFFSET TO EOP FEET	EOP ELEV FEET	DISTANCE ALONG RAD. FEET
RT. 476+64.80	13.00	509.03	
RT. 476+74.75	14.81	508.79	10.00
RT. 476+83.40	20.02	508.56	20.00
RT. 476+89.63	27.94	508.32	30.00
RT. 476+92.54	37.53	508.09	40.00
RT. 476+93.26	47.50	507.85	50.00
RT. 476+93.41	49.72	507.80	52.22

N.W. QUADRANT			
STATIONING ALONG U.S. RTE. 51	OFFSET TO EOP FEET	EOP ELEV FEET	DISTANCE ALONG RAD. FEET
RT. 477+47.68	13.00	509.25	
RT. 477+37.74	14.81	508.96	10.00
RT. 477+29.08	20.02	508.67	20.00
RT. 477+22.86	27.94	508.39	30.00
RT. 477+19.95	37.53	508.10	40.00
RT. 477+20.36	47.52	507.81	50.00
RT. 477+20.37	47.68	507.80	50.26

U.S. ROUTE 50 / CHERRY ST.

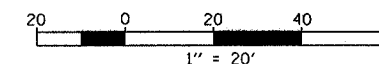

U.S. ROUTE 50 / WALL ST.

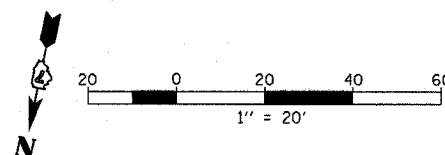

REVISIONS	
NAME	DATE

ILLINOIS DEPARTMENT OF TRANSPORTATION
**INTERSECTION WARPING /
 GEOMETRIC LAYOUT
 U.S. ROUTE 50**

SCALE: VERT. 1" = 20'
 HORIZ. 1" = 20'
 DATE 6/27/03
 DRAWN BY MEC
 CHECKED BY MJM