

F.A.P. RTE.	SECTION	COUNTY	TOTAL SHEETS	SHEET NO.
327	182 & 187, RS 282	MARION	222	85
STA.		TO STA.		
DOT DIST. NO. 7		ILLINOIS FED. AID PROJECT		
CONTRACT NO. 94700				

S.E. QUADRANT			
STATIONING ALONG U.S. RTE. 50	OFFSET TO EOP FEET	EOP ELEV FEET	DISTANCE ALONG RAD. FEET
LT. 481+46.50	13.00	508.86	
LT. 481+56.43	14.82	508.72	10.00
LT. 481+65.06	20.04	508.58	20.00
LT. 481+71.25	27.97	508.44	30.00
LT. 481+74.13	37.57	508.30	40.00
LT. 481+71.82	47.31	508.17	50.00
LT. 481+66.94	56.14	508.03	60.00
LT. 481+63.33	63.85	507.91	68.45

S.W. QUADRANT			
STATIONING ALONG U.S. RTE. 50	OFFSET TO EOP FEET	EOP ELEV FEET	DISTANCE ALONG RAD. FEET
LT. 482+28.96	13.00	508.70	
LT. 482+19.03	14.82	508.59	10.00
LT. 482+10.40	20.04	508.48	20.00
LT. 482+04.21	27.97	508.37	30.00
LT. 482+01.33	37.57	508.26	40.00
LT. 481+01.42	46.27	508.15	50.00
LT. 481+05.14	55.61	508.04	60.00
LT. 481+08.82	64.96	507.93	70.00
LT. 481+08.98	66.84	507.91	71.88

S.E. QUADRANT			
STATIONING ALONG U.S. RTE. 50	OFFSET TO EOP FEET	EOP ELEV FEET	DISTANCE ALONG RAD. FEET
LT. 479+59.04	13.00	509.59	
LT. 479+68.87	14.85	509.34	10.00
LT. 479+77.35	20.15	509.10	20.00
LT. 479+88.33	28.17	508.85	30.00
LT. 479+86.05	37.81	508.61	40.00
LT. 479+85.08	47.77	508.36	50.00
LT. 479+84.50	50.48	508.29	52.76

S.W. QUADRANT			
STATIONING ALONG U.S. RTE. 50	OFFSET TO EOP FEET	EOP ELEV FEET	DISTANCE ALONG RAD. FEET
LT. 480+41.90	14.21	509.33	
LT. 480+31.97	16.06	509.08	10.00
LT. 480+23.35	21.32	508.84	20.00
LT. 480+17.19	29.27	508.59	30.00
LT. 480+14.24	38.85	508.34	40.00
LT. 480+12.32	48.68	508.29	42.04

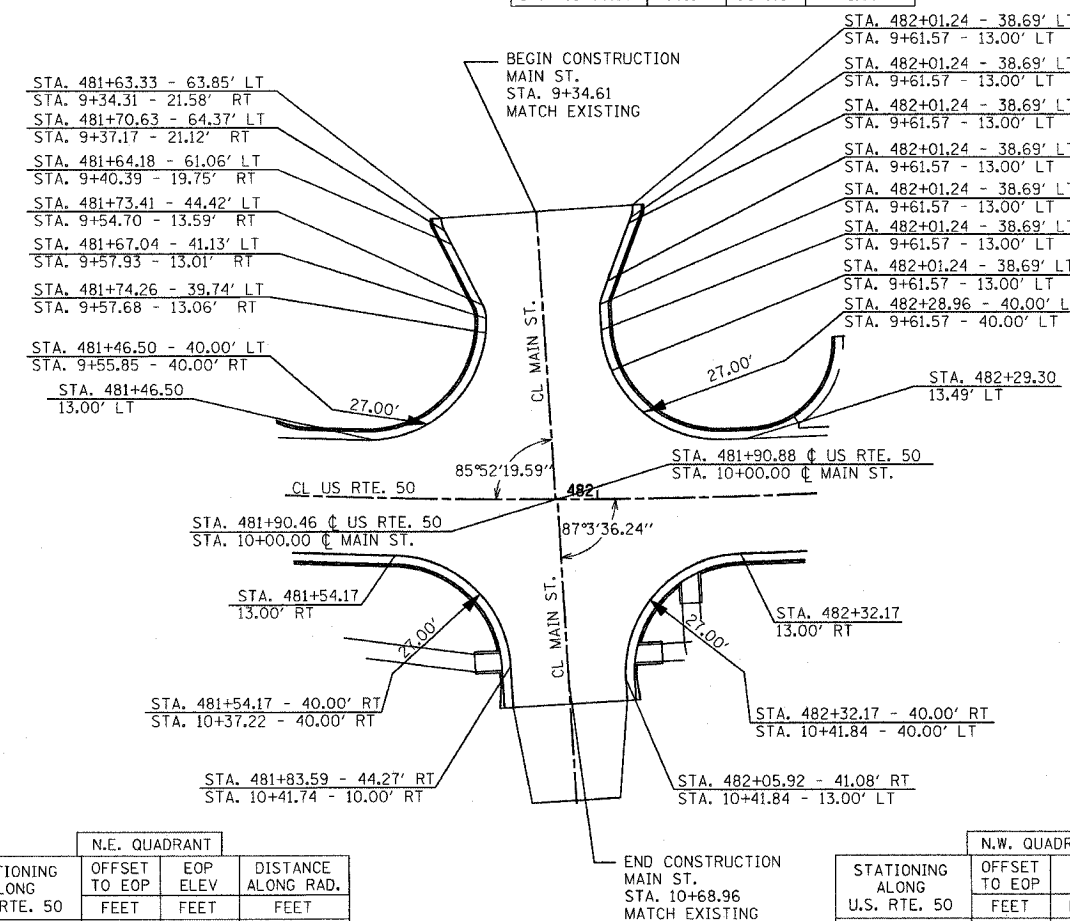
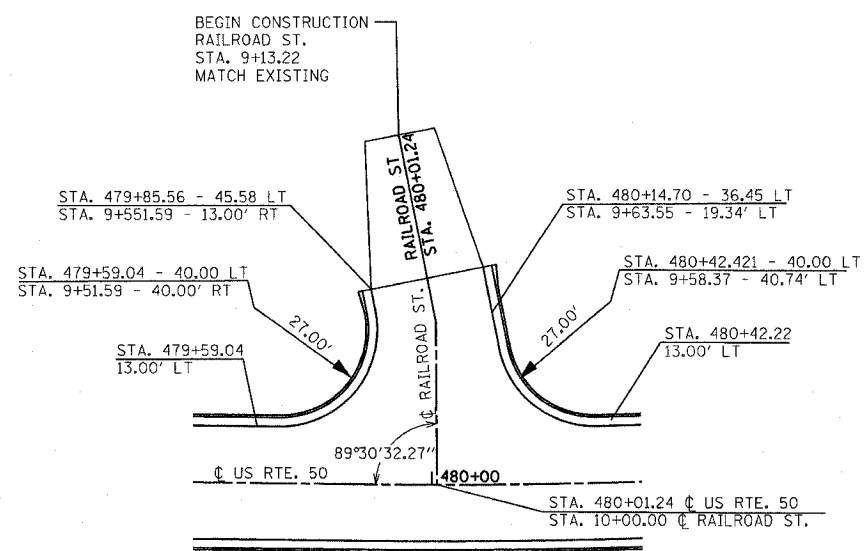

N.E. QUADRANT			
STATIONING ALONG U.S. RTE. 50	OFFSET TO EOP FEET	EOP ELEV FEET	DISTANCE ALONG RAD. FEET
RT. 481+54.17	13.00	508.83	
RT. 481+63.90	14.88	508.92	10.00
RT. 481+72.22	20.27	509.01	20.00
RT. 481+77.98	28.37	509.10	30.00
RT. 481+80.40	38.06	509.12	40.00
RT. 481+81.09	47.56	508.94	49.52

N.W. QUADRANT			
STATIONING ALONG U.S. RTE. 50	OFFSET TO EOP FEET	EOP ELEV FEET	DISTANCE ALONG RAD. FEET
RT. 482+32.17	13.00	508.70	
RT. 482+22.44	14.88	508.83	10.00
RT. 482+14.12	20.27	508.96	20.00
RT. 482+08.36	28.38	509.09	30.00
RT. 482+05.94	38.06	509.11	40.00
RT. 482+06.16	46.07	508.94	48.01

U.S. ROUTE 50 / RAILROAD ST.

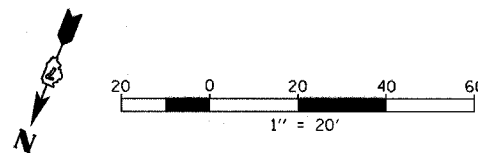

U.S. ROUTE 50 / MAIN ST.

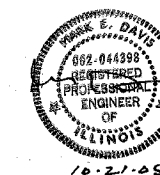
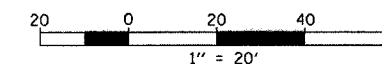

REVISIONS	
NAME	DATE

ILLINOIS DEPARTMENT OF TRANSPORTATION

INTERSECTION WARPING / GEOMETRIC LAYOUT U.S. ROUTE 50

SCALE: VERT. 1" = 20'  
HORIZ. 1" = 20'  
DATE 6/27/03

DRAWN BY MEC  
CHECKED BY MJM