

F.A.P. RTE.	SECTION	COUNTY	TOTAL SHEETS	SHEET NO.
327	18Z & 18Y, RS 28Z	MARION	221	97
STA. 463+50.70		TO STA. 475+00.00		
DOT DIST. NO. 7		ILLINOIS FED. AID PROJECT		
CONTRACT NO. 94700				

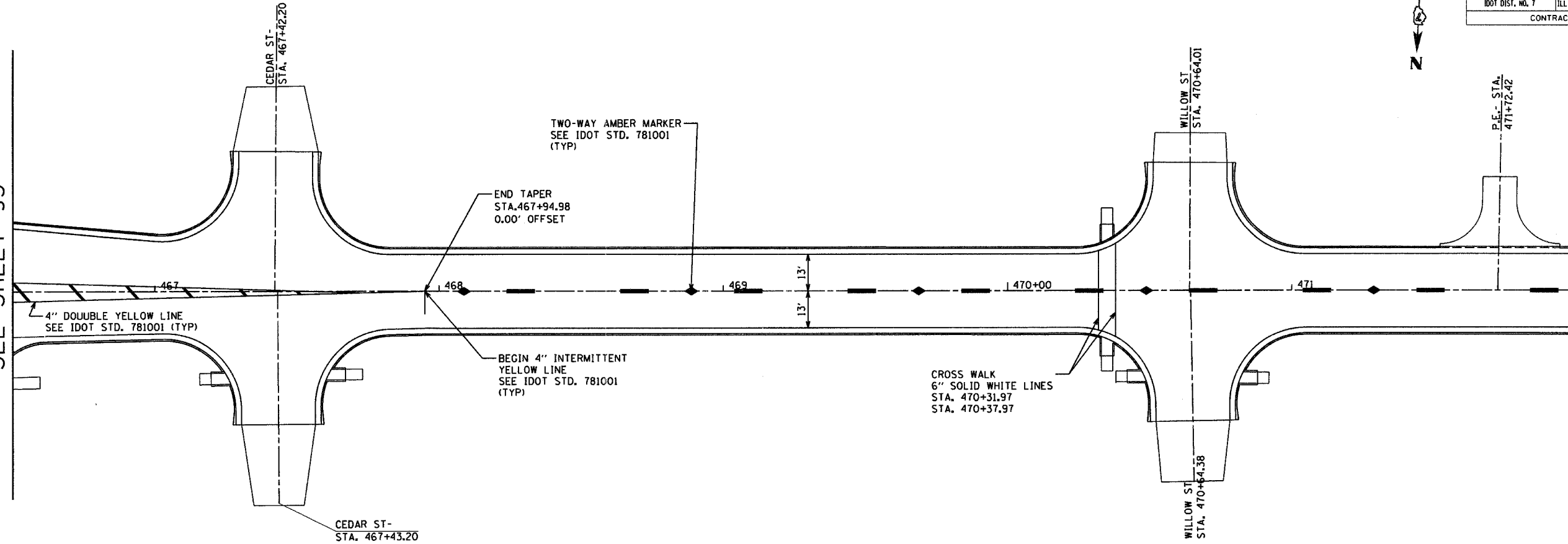

MATCHLINE STA. 466+50.00
SEE SHEET 93

MATCHLINE STA. 472+00.00



MATCHLINE STA. 472+00.00

MATCHLINE STA. 478+00.00
SEE SHEET 98

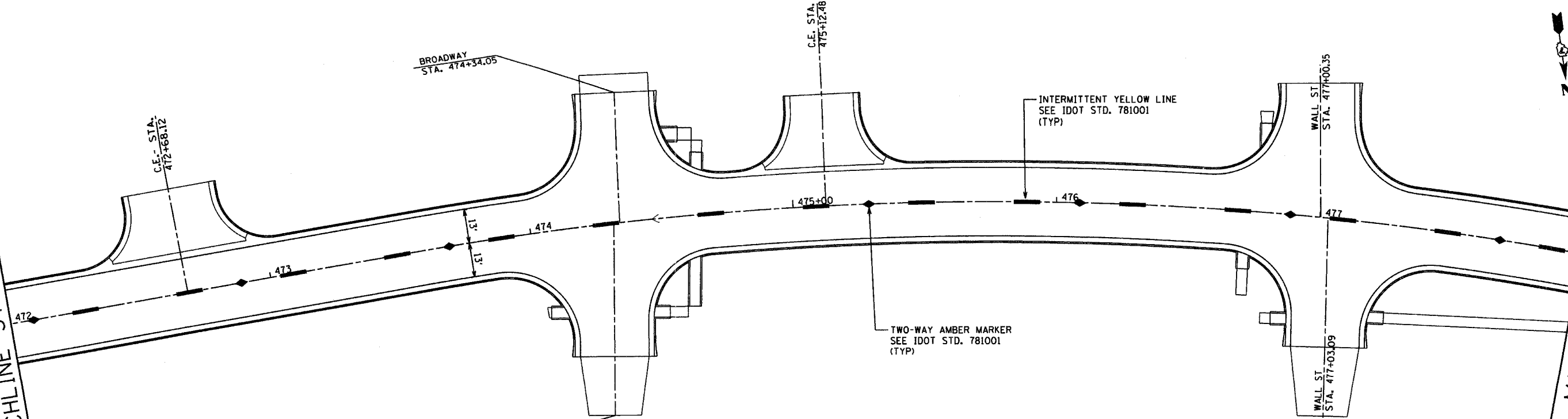

SEE STD. 780001 FOR ADDITIONAL INFORMATION

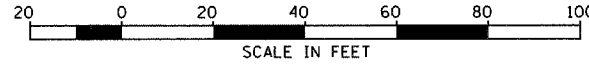

REVISIONS	
NAME	DATE

ILLINOIS DEPARTMENT OF TRANSPORTATION
PERMANENT PAVEMENT MARKING
SCALE: AS NOTED
DATE: 10/20/2005
DRAWN BY: ELA
CHECKED BY: AEF

