

F.A.P. RTE.	SECTION	COUNTY	TOTAL SHEETS	SHEET NO.
327 182 & 18Y, RS 28Z		MARION	221	101
STA. 511+00.00		TO STA. 523+00.00		
IDOT DIST. NO. 7		ILLINOIS FED. AID PROJECT		
CONTRACT NO. 94700				

MATCHLINE STA. 514+00.00
SEE SHEET 100

MATCHLINE STA. 520+00.00

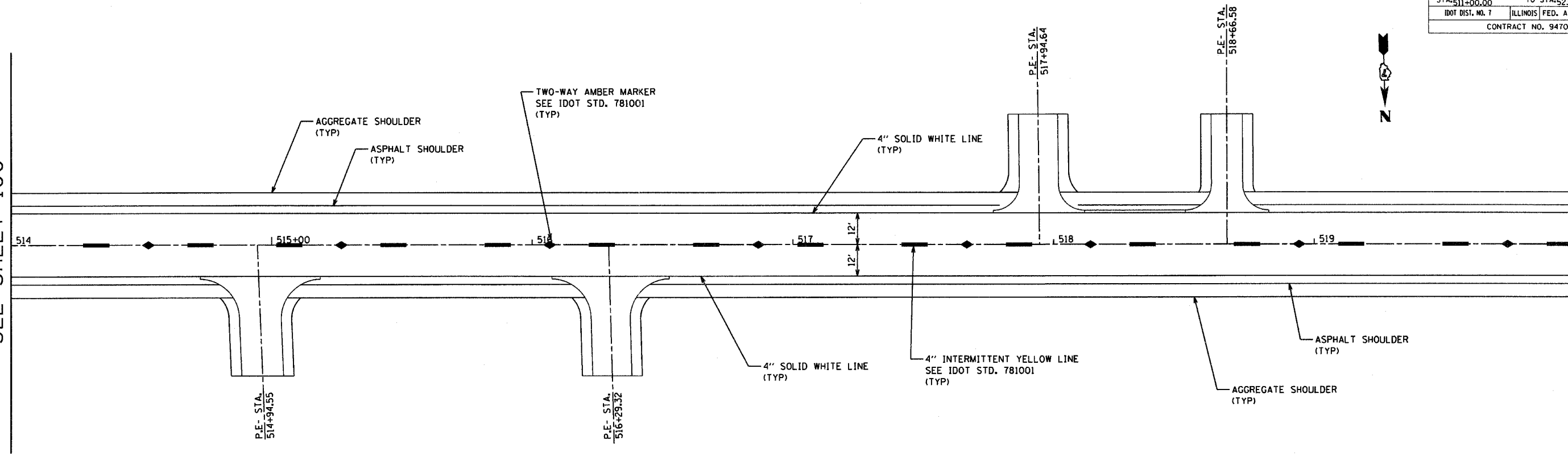

SEE STD. 780001 FOR ADDITIONAL INFORMATION

MATCHLINE STA. 520+00.00

MATCHLINE STA. 526+00.00
SEE SHEET 102

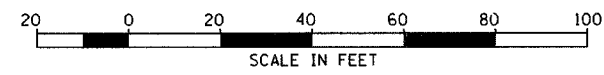
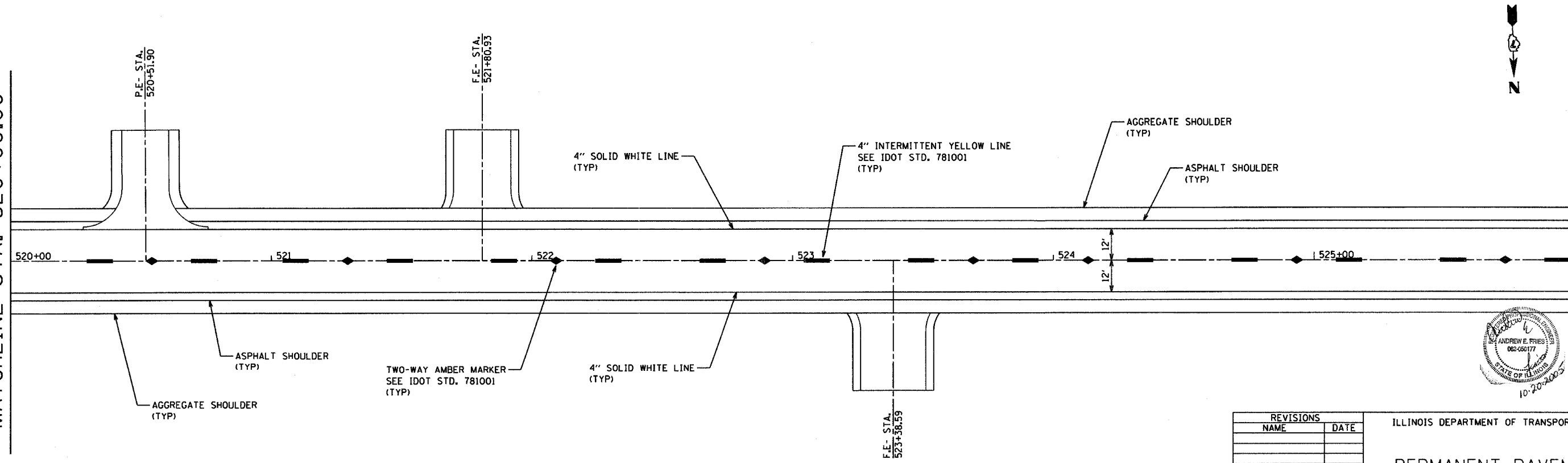

REVISIONS	
NAME	DATE

ILLINOIS DEPARTMENT OF TRANSPORTATION

PERMANENT PAVEMENT MARKING

SCALE: AS NOTED
DATE: 10/20/2005

DRAWN BY: ELA
CHECKED BY: AEF

