

F.A.E. RTE.	SECTION	COUNTY	TOTAL SHEETS	SHEET NO.
327	182 & 18Y, RS 282	MARION	222	103
STA.	TO STA.			
IDOT DIST. NO. 7	ILLINOIS FED. AID PROJECT			
CONTRACT NO. 94700				

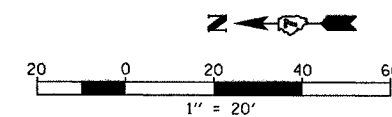

PLAN  
 REVISIONS  
 NO. DATE BY  
 1. 01/21/05 [blank] [blank]

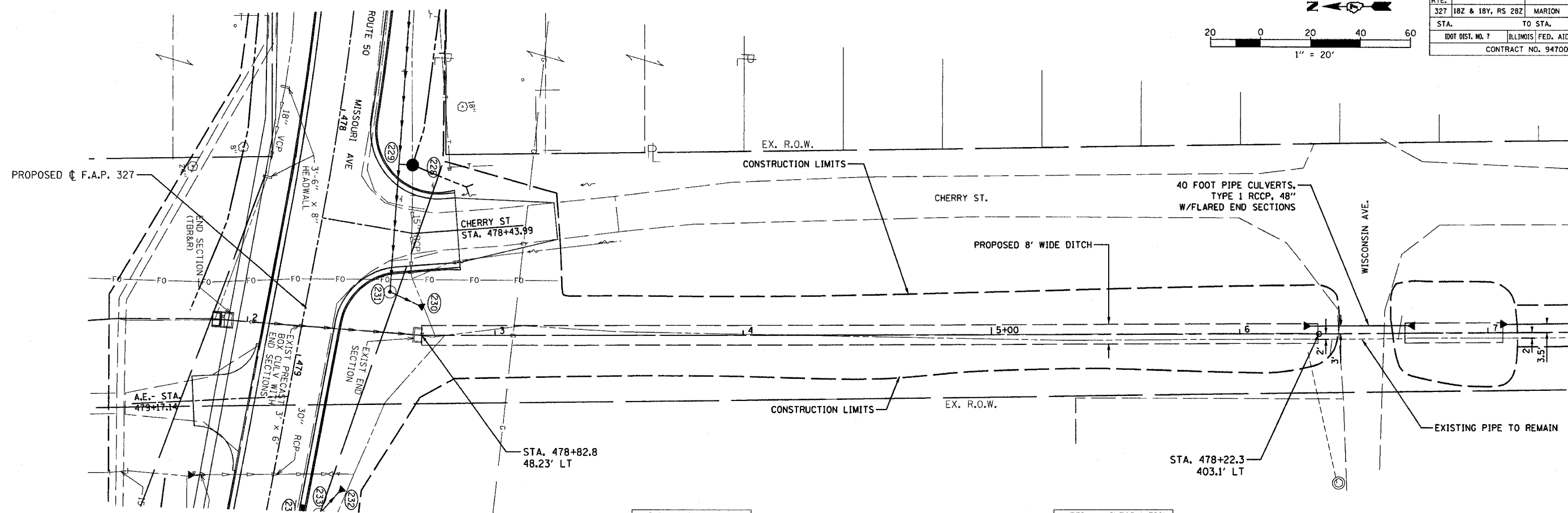

PROFILE  
 REVISIONS  
 NO. DATE BY  
 1. 01/21/05 [blank] [blank]

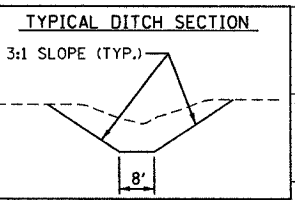

WATERWAY INFORMATION													
3'X6' CULVERT UNDER US RTE. 50 STA. 478+88					2-48" CULVERTS UNDER WISCONSIN AVE. STA. 478+21 OFF. 420' LT								
FLOOD	FREQ. YRS.	Q C.F.S.	OPENING SQ. FT.	NAT. H.W.E.	HEAD - FT.	HEADWATER EL.	FLOOD	FREQ. YRS.	Q C.F.S.	OPENING SQ. FT.	NAT. H.W.E.	HEAD - FT.	HEADWATER EL.
DESIGN	50	47	18	18	504.88	1.04	DESIGN	50	12.57	25.14			
BASE	100	52	18	18	504.95	1.11	BASE	100	12.57	25.14			
OVERTOPPING							OVERTOPPING						
MAX. CALC.	500	63	18	18	505.11	1.25	MAX. CALC.	500	12.57	25.14			

