

F.A.P. RTE.	SECTION	COUNTY	TOTAL SHEETS	SHEET NO.
327 18Z & 18Y, RS 28Z		MARION	221	123
STA. 511+00.00		TO STA. 523+00.00		
DOT DIST. NO. 7		ILLINOIS FED. AID PROJECT		
CONTRACT NO. 94700				

MATCHLINE STA. 511+00.00

MATCHLINE STA. 517+00.00

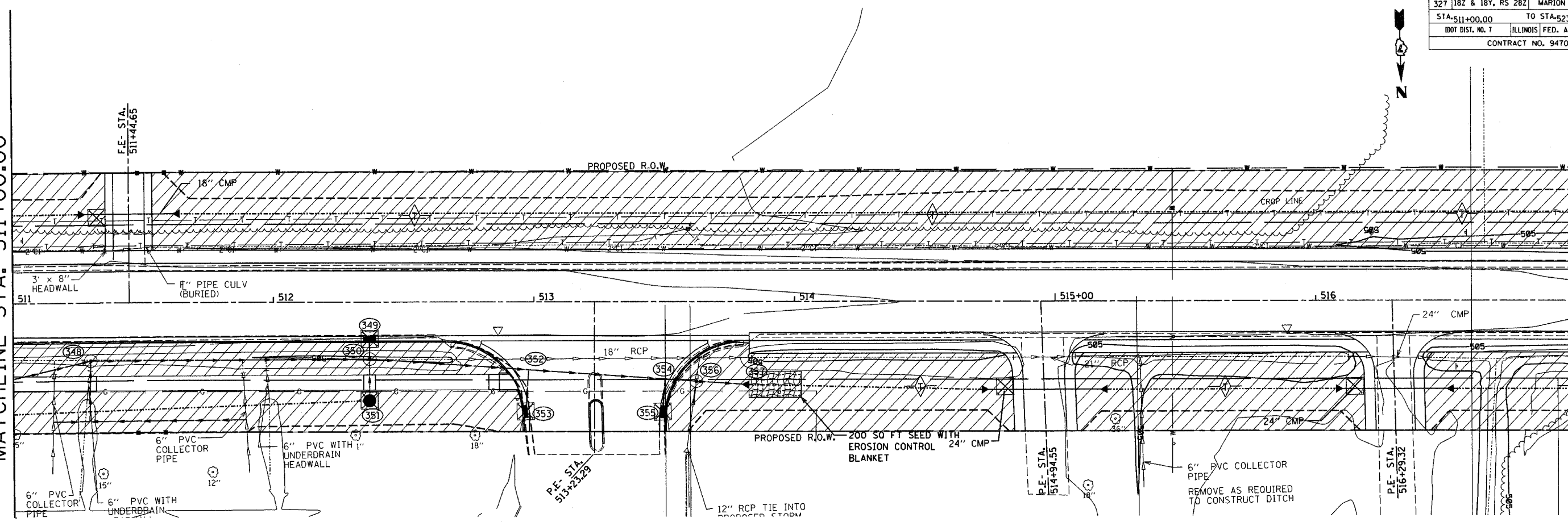

MATCHLINE STA. 517+00.00

MATCHLINE STA. 523+00.00

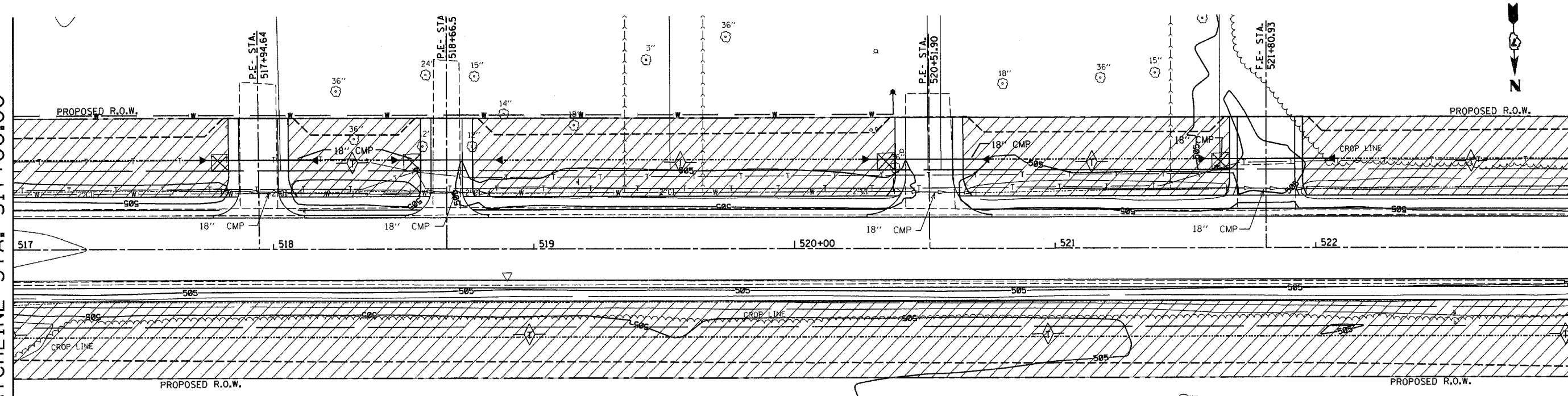

REVISIONS	
NAME	DATE

ILLINOIS DEPARTMENT OF TRANSPORTATION
EROSION CONTROL PLAN
 SCALE: VERT. N/A
 HORIZ. 1" = 20'
 DATE 06-27-03
 DRAWN BY ELA
 CHECKED BY AEF

