

F.A.P. RTE.	SECTION	COUNTY	TOTAL SHEET NO.
322	182 & 184, RS 282	MARION	222
STA.	TO STA.		183
FED. ROAD-DIST. NO.	ILLINOIS	FED. AID PROJECT	

DATE	BY
FINAL SURVEY	
SURVEYED	
NOTE BOOK	
NO.	
AREAS CHECKED	
AREAS	
TYPICAL	
AREAS	

DATE	BY
ORIGINAL SURVEY	
SURVEYED	
NOTE BOOK	
NO.	
AREAS CHECKED	
AREAS	
TYPICAL	
AREAS	

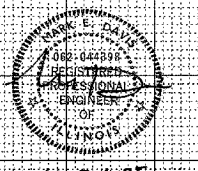
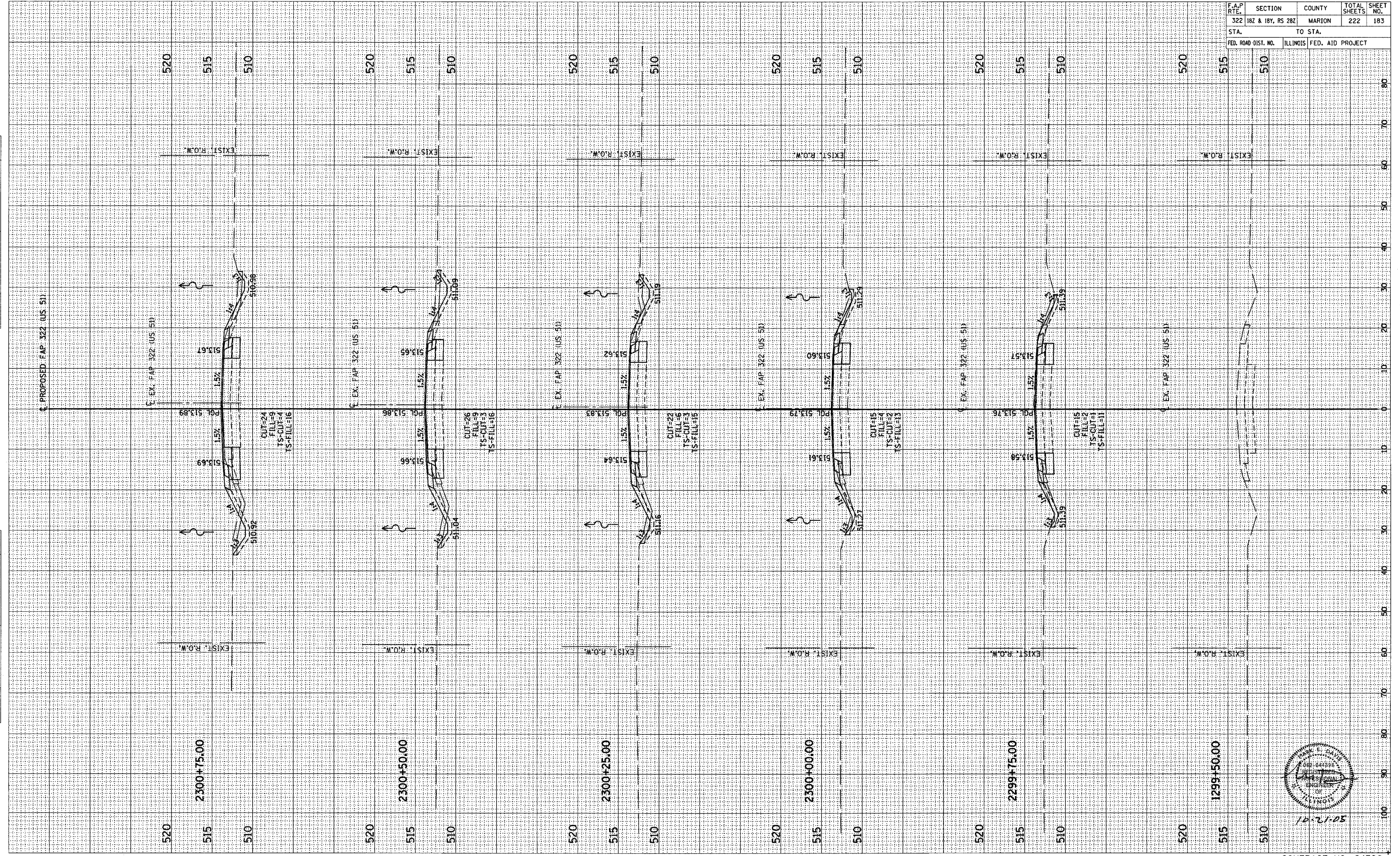

5/12/91