

F.A.P. RTE.	SECTION	COUNTY	TOTAL SHEETS	SHEET NO.
331	*	JACKSON	258	49
STA.		TO STA.		
FED. ROAD DIST. NO.		ILLINOIS	FED. AID PROJECT	
* (12-1)2N,I-5,TS-3,B-1				

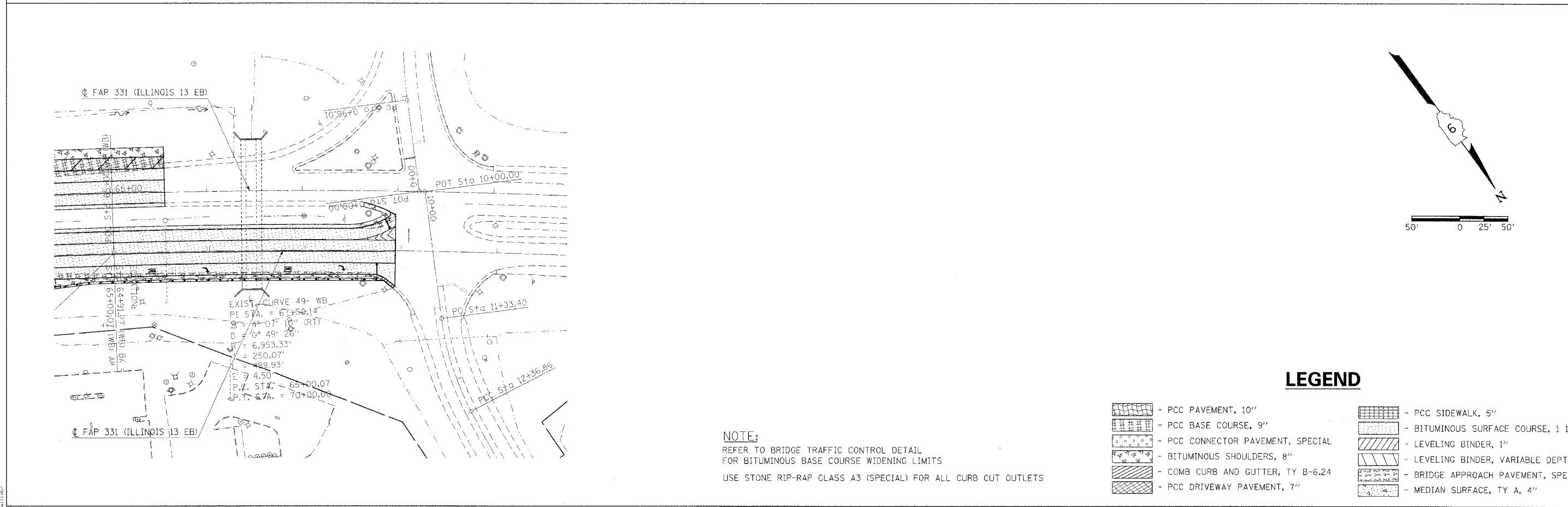
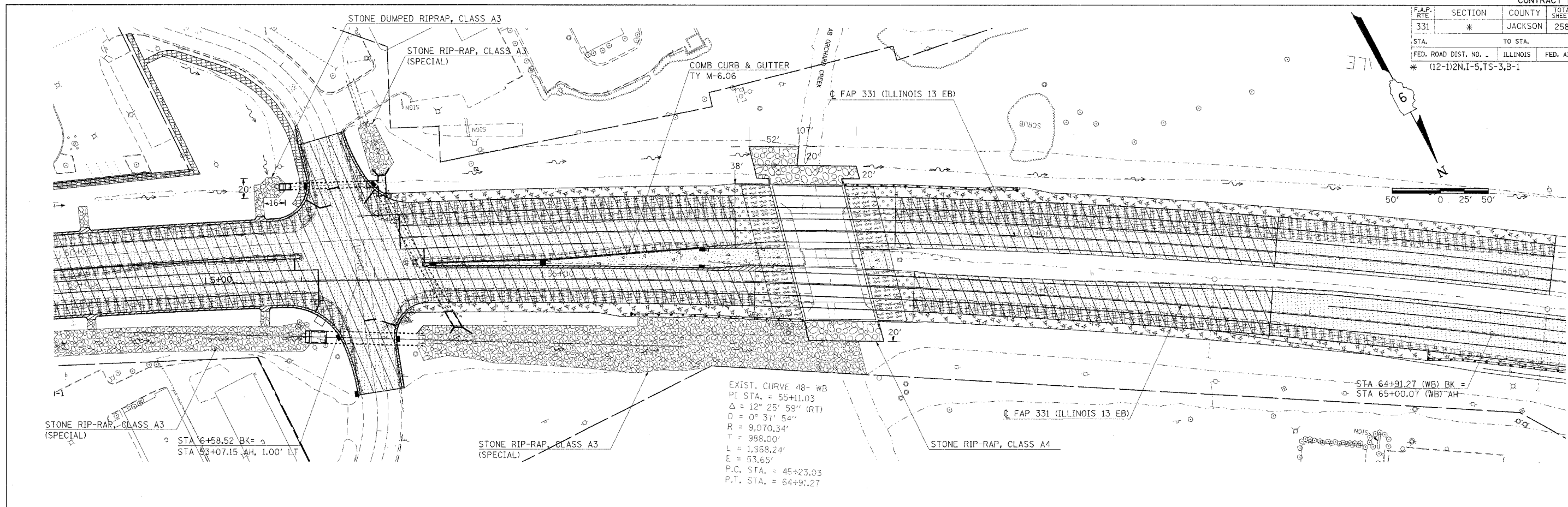

NOTE:
 REFER TO BRIDGE TRAFFIC CONTROL DETAIL FOR BITUMINOUS BASE COURSE WIDENING LIMITS
 USE STONE RIP-RAP CLASS A3 (SPECIAL) FOR ALL CURB CUT OUTLETS

LEGEND

	- PCC PAVEMENT, 10"		- PCC SIDEWALK, 5"
	- PCC BASE COURSE, 9"		- BITUMINOUS SURFACE COURSE, 1 1/2 "
	- PCC CONNECTOR PAVEMENT, SPECIAL		- LEVELING BINDER, 1"
	- BITUMINOUS SHOULDERS, 8"		- LEVELING BINDER, VARIABLE DEPTH
	- COMB CURB AND GUTTER, TY B-6.24		- BRIDGE APPROACH PAVEMENT, SPECIAL
	- PCC DRIVEWAY PAVEMENT, 7"		- MEDIAN SURFACE, TY A, 4"

2/15/2006
 C:\pwworkspace\104402140\104402140.dwg
 10:11:20 AM 7/20/06
 111111