

F.A.P. RTE	SECTION	COUNTY	TOTAL SHEETS	SHEET NO
331	*	JACKSON	258	51
STATION		TO STA.		
FED. ROAD DIST. NO. -		ILLINOIS	FED. AID PROJECT	
*(12-1)2N,I-5,TS-3,B-1				

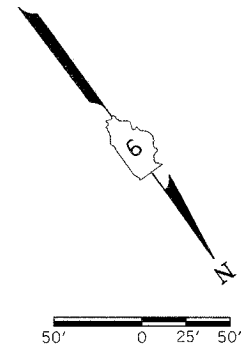
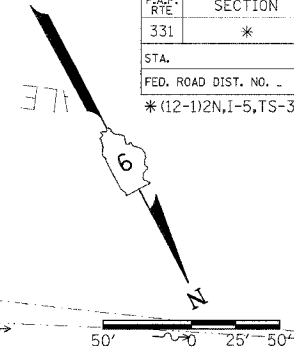
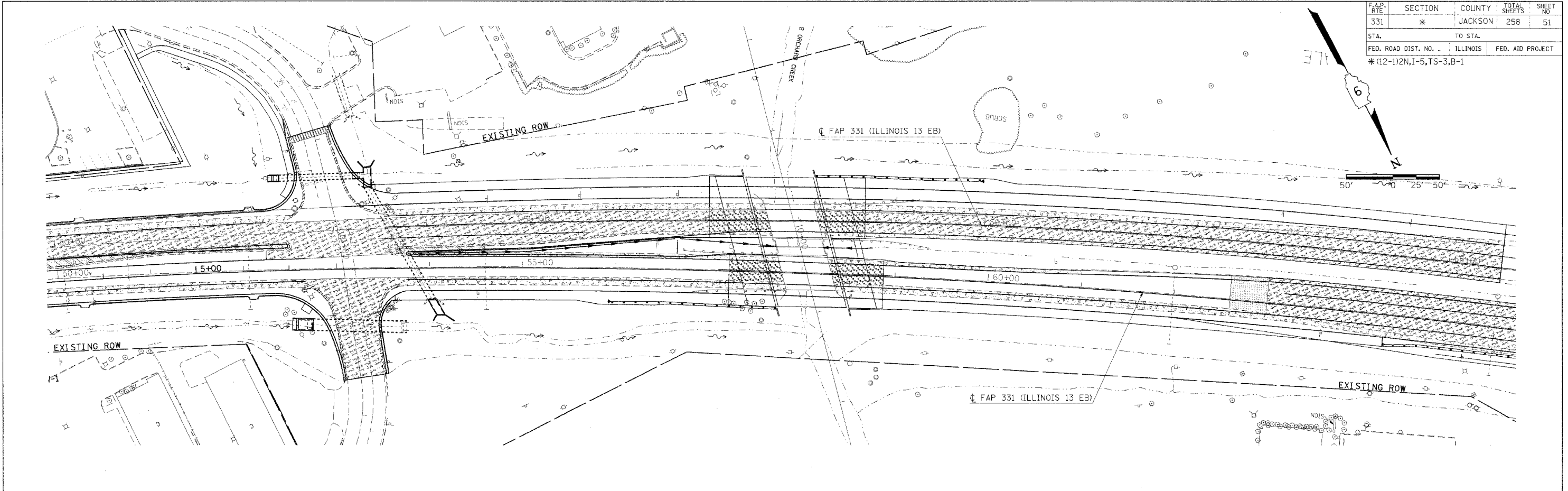

LEGEND

- PAVEMENT REMOVAL
- MEDIAN REMOVAL
- SHOULDER REMOVAL
- SIDEWALK REMOVAL
- BIT SURFACE REMOVAL, 1 1/2 "
- BIT SURFACE REMOVAL, VAR DEPTH
- PCC SURFACE REMOVAL, 1 1/2 "
- PCC SURFACE REMOVAL, BUTT JOINT
- CURB/GUTTER REMOVAL
- DRIVEWAY PAVEMENT REMOVAL

2/15/2005
 c:\p05\mca\p304483\p304483.dgn
 50,0000 / / IN.
 ml33r