

F.A.P. RTE.	SECTION	COUNTY	TOTAL SHEETS	SHEET NO.
331	*	JACKSON	258	66
STA.		TO STA.		
FED. ROAD DIST. NO. -		ILLINOIS	FED. AID PROJECT	
* (12-1)2N,I-5,TS-3,B-1				

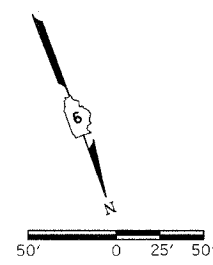
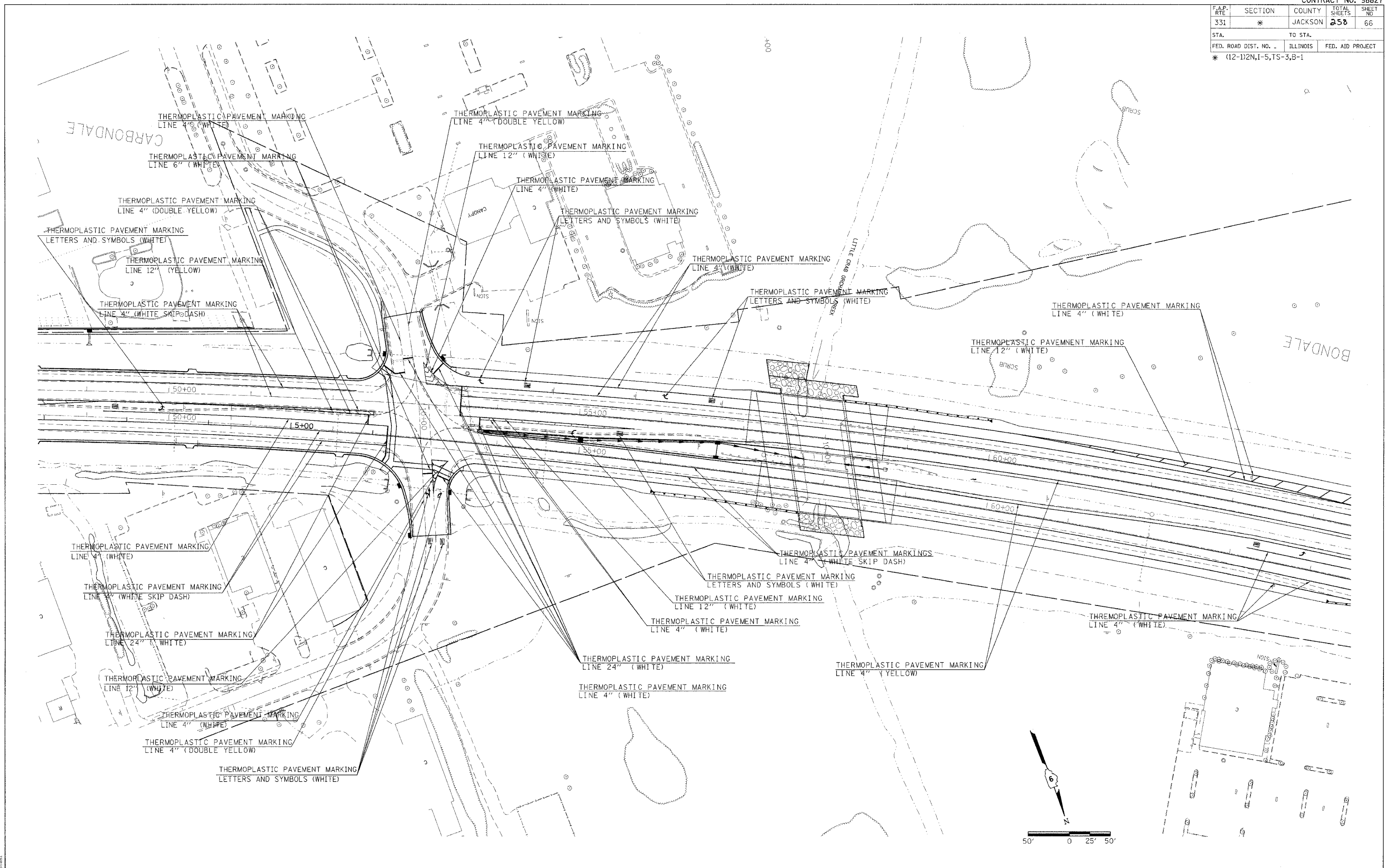

2/14/2006
 A:\Projects\98827\98827.dwg
 5/20/06
 7
 print

PAVEMENT MARKINGS